

#30-FIRST CONGREGATIONAL CHURCH OF PUTNEY, INC.
 (A 902) STA 979+60-992+66±
 COND. 7/10/59
 REC.: # 31A

Channel Excavation of Earth
 Item 106-A
 980+20 Lt. - 983+76±

Paved Median Gutter
 Item No. 505
 980+25 to 980+50
 981+75 to 985+00

Bituminous Concrete Curb
 Item No. 505
 980+00 to 980+72 Lt.
 983+35 to 985+00 Lt.

Gravel Sackfill
 Item No. 222
 980+00 to 980+77 Lt.
 981+00 to 981+16 Rt.
 983+37 to 985+00 Lt.
 983+76 to 985+00 Rt.
 986+00 to 980+00 Lt.
 986+50 to 980+00 Rt.

Sub-base of Sand
 Item No. 202
 980+00 to 980+76 Lt.
 981+00 to 981+16 Rt.
 983+82 to 985+00 Lt.
 984+06 to 980+00 Rt.

Bituminous Grouted Stone Gutter
 Item 553
 985+00 Lt.

Stone Fill for Slope Protection
 Item No. 522
 980+00 to 980+77 Lt.
 981+00 to 981+16 Rt.
 983+37 to 984+81 Lt.
 983+79 to 984+87 Rt.

Three Cable Guard with Steel Posts
 980+00 to 980+76 Lt.
 981+00 to 981+16 Rt.
 983+37 to 985+00 Lt. +20
 983+76 to 985+00 Rt. +40
 986+00 to 980+00 Lt. Med.
 986+50 to 980+00 Lt. Med.
 986+50 to 980+00 Rt. Med.

Rev. Interstate Curve Data
 $\Delta = 16^\circ - 23' - 47''$ Lt.
 $D = 0^\circ - 30'$

Property Line Fence with Steel Posts
 Item No. 583 B
 980+00 to 980+00 Lt.
 980+00 to 980+00 Rt.

2ND REV. INTERSTATE CURVE DATA
 Sur. P.O.T. 982+25.6±
 $\Delta = 28^\circ 02' LT$
 $D = 0^\circ 30'$
 $R = 1459.2'$
 $T = 205.0'$
 $E = 410.0'$
 $L = 1.6'$
 Bank 1/4" Per Ft.

2ND REV. INTERSTATE CURVE DATA
 $\Delta = 6^\circ 46' LT$
 $D = 0^\circ 45'$
 $R = 7639.5'$
 $T = 451.7'$
 $E = 1302.2'$
 $L = 13.4'$
 Bank 1/4" Per Ft.

Summary-Landscape Material
 Contract No. 1.

- I Trees.
 - A. Evergreens.
 - 1. Thuja Canadensis-Canada Hemlock. 1
 - 2. Thuja Occidentalis-Eastern Arborvitae. 25
 - B. Deciduous.
 - 1. Quercus Borealis-Northern Red Oak. 1
 - 2. Cornus Florida-Flowering Dogwood. 16
- II Shrubs.
 - A. Deciduous
 - 1. Cornus Racemosa-Gray Dogwood. 20
 - 2. Rose Multiflora-Japanese Rose. 200
- III Vines
 - 1. Lonicera Tartarica-Pink Tartarian Honeysuckle 40

- IV General Notes.
- A. Size Of Planting Material.
 1. Evergreen Trees Should Be 2-3 Feet In Height.
 2. Evergreen Shrubs Should Be 12" in Diameter (Measurement is Average Spread of Branches), 9-12" in Height and 2 5/16" Minimum Caliber.
 3. Large Deciduous Trees Should Be 3 1/4" to 1" in Caliber, 5 to 6 Feet in Height With 6 or More Branches.
 4. Small Deciduous Trees Should Be 1 1/16" in Caliber, 5 to 6 Feet in Height With 6 or More Branches.
 5. Deciduous Shrubs Should Be 2 to 3 Feet in Height, With Not Less Than 4 Canes, 2 Feet and Up.
 6. All Conifers Must Have Dormant Buds and Secondary Needles.
 - B. All Plant Material to be Graded According to American Standards for Nursery Stock.

980+00
 END PROJECT I 91-1(91)
 CONTRACT NO. 5
 BEGIN PROJECT I 91-1(10)
 CONTRACT NO. 1

#31-A ALDREN A & NANCY D. WATSON
 (A1362) STA 983+25-1007+52±
 COND. 7/3/59
 REC.: PUTNEY BK.-35-PG.222-7/10/59

STATE OF VERMONT
 DEPARTMENT OF HIGHWAYS
 INTERSTATE PROJECT in the town of
 PUTNEY

THE STATE ENGINEERING BOARD
 REGISTERED PROFESSIONAL ENGINEERS

PROJECT NO. 91-1(10) SHEET 30
 CONTRACT NO. 1

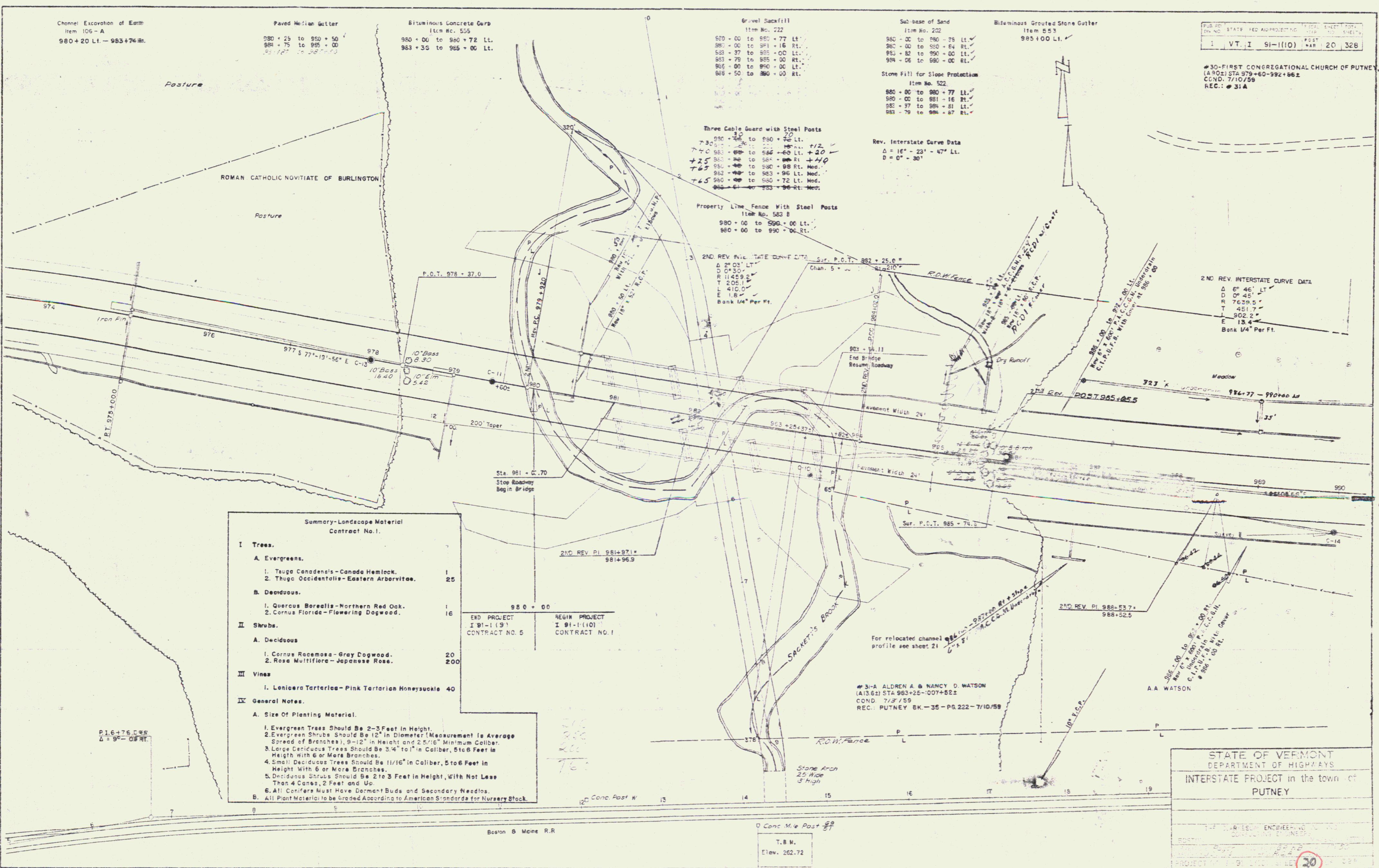

P16+76.00±
 $\Delta = 9^\circ - 08' RT.$

Boston & Maine R.R.

T.B.M.
 Elev. 262.72