

Channel Excavation of Earth
Item 106-A
980+20 Lt. - 983+76 Rt.

Paved Median Gutter
Item No. 555
980+25 to 980+50
981+75 to 985+00
987+07 to 987+10

Simultaneous Concrete Curb
Item No. 555
980+00 to 980+72 Lt.
983+30 to 985+00 Lt.

Gravel Ditchfill
Item No. 222
980+00 to 980+77 Lt.
980+00 to 981+16 Lt.
983+37 to 985+00 Lt.
985+78 to 985+00 Lt.
986+00 to 986+00 Lt.
988+50 to 988+00 Lt.

Sub-base of Sand
Item No. 222
980+00 to 980+78 Lt.
980+00 to 980+78 Lt.
983+82 to 985+00 Lt.
986+06 to 986+00 Lt.

Bituminous Grouted Stone Gutter
Item No. 553
985+00 Lt.

STATE OF VERMONT
DEPARTMENT OF HIGHWAYS
PROJECT NO. 91-1(10) SHEET NO. 20 OF 32B

#30-FIRST CONGREGATIONAL CHURCH OF PUTNEY, INC.
(LARGE) STA 979+60-992+86.2
COND. 7/10/59
REC. # 31A

Three Cable Guard with Steel Posts
790+00 to 980+20 Lt.
790+00 to 980+20 Lt.
+25 980+00 to 981+16 Lt. +20
+25 983+37 to 985+00 Lt. +40
+25 985+78 to 985+00 Lt. +40
+25 986+00 to 986+00 Lt. +40
+25 988+50 to 988+00 Lt. +40

Rev. Interstate Curve Data
L = 117' - 23" - 47" Lt.
D = 0" - 30'

Property Line Fence With Steel Posts
Item No. 563 B
980+00 to 980+00 Lt.
980+00 to 980+00 Lt.

2ND REV. INT. STATE CURVE DATA
Sur. P.C.T. 982+25.6"
Chan. 5' - 0"
D = 0' - 30'
R = 1172.5'
T = 205.0'
L = 410.0'
E = 18.4'
Bank 1/4" Per Ft.

2ND REV. INTERSTATE CURVE DATA
D = 6' - 46" Lt.
D = 0' - 45"
R = 7628.5'
T = 451.7'
L = 902.3'
E = 18.4'
Bank 1/4" Per Ft.

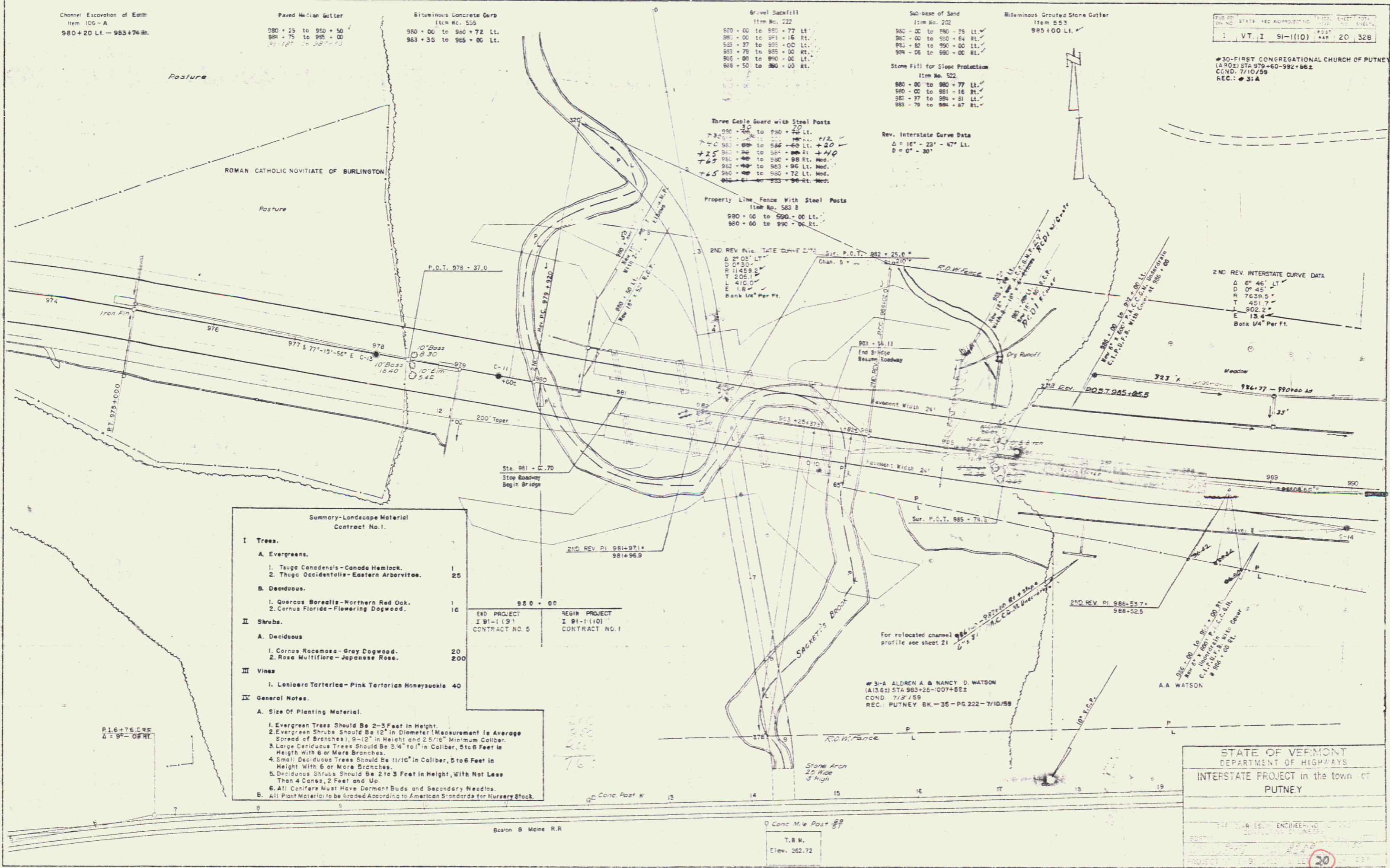

Summary-Landscape Material
Contract No. 1.

I Trees.	
A. Evergreens.	
1. Thuja Canadensis - Canada Hemlock.	1
2. Thuja Occidentalis - Eastern Arborvitae.	25
B. Deciduous.	
1. Quercus Borealis - Northern Red Oak.	1
2. Cornus Florida - Flowering Dogwood.	16
II Shrubs.	
A. Deciduous	
1. Cornus Racemosa - Gray Dogwood.	20
2. Rosa Multiflora - Japanese Rose.	200
III Vines	
1. Lonicera Tartarica - Pink Tartarian Honeysuckle	40
IV General Notes.	
A. Size Of Planting Material.	
1. Evergreen Trees Should Be 2-3 Feet in Height.	
2. Evergreen Shrubs Should Be 12" in Diameter (Measurement is Average Spread of Branches), 9-12" in Height and 2 5/16" Minimum Caliber.	
3. Large Deciduous Trees Should Be 3-4" to 1" in Caliber, 5 to 6 Feet in Height with 6 or More Branches.	
4. Small Deciduous Trees Should Be 1 1/16" in Caliber, 5 to 6 Feet in Height with 6 or More Branches.	
5. Deciduous Shrubs Should Be 2 to 3 Feet in Height, with Not Less Than 4 Canes, 2 Feet and Up.	
6. All Conifers Must Have Dormant Buds and Secondary Needles.	
B. All Plant Material to be graded according to American Standards for Nursery Stock.	

#3-A ALDREN & NANCY O WATSON
(A1361) STA 983+25-107+82.2
COND. 7/3/59
REC. PUTNEY BK.-35-PG.222-7/10/59

STATE OF VERMONT
DEPARTMENT OF HIGHWAYS
INTERSTATE PROJECT in the town of
PUTNEY

PROJECT NO. 91-1(10) SHEET NO. 20 OF 32B
CONTRACT NO. 1