

A PORTION OF THE LAND ACQUIRED BY THE STATE OF VERMONT BY CONDEMNATION FROM DONALD W. & JUNE L. RECORD DATED MAY 21, 1958 AND RECORDED IN BOOK 101 PAGES 159-205 OF THE TOWN OF BRATTLEBORO LAND RECORDS.

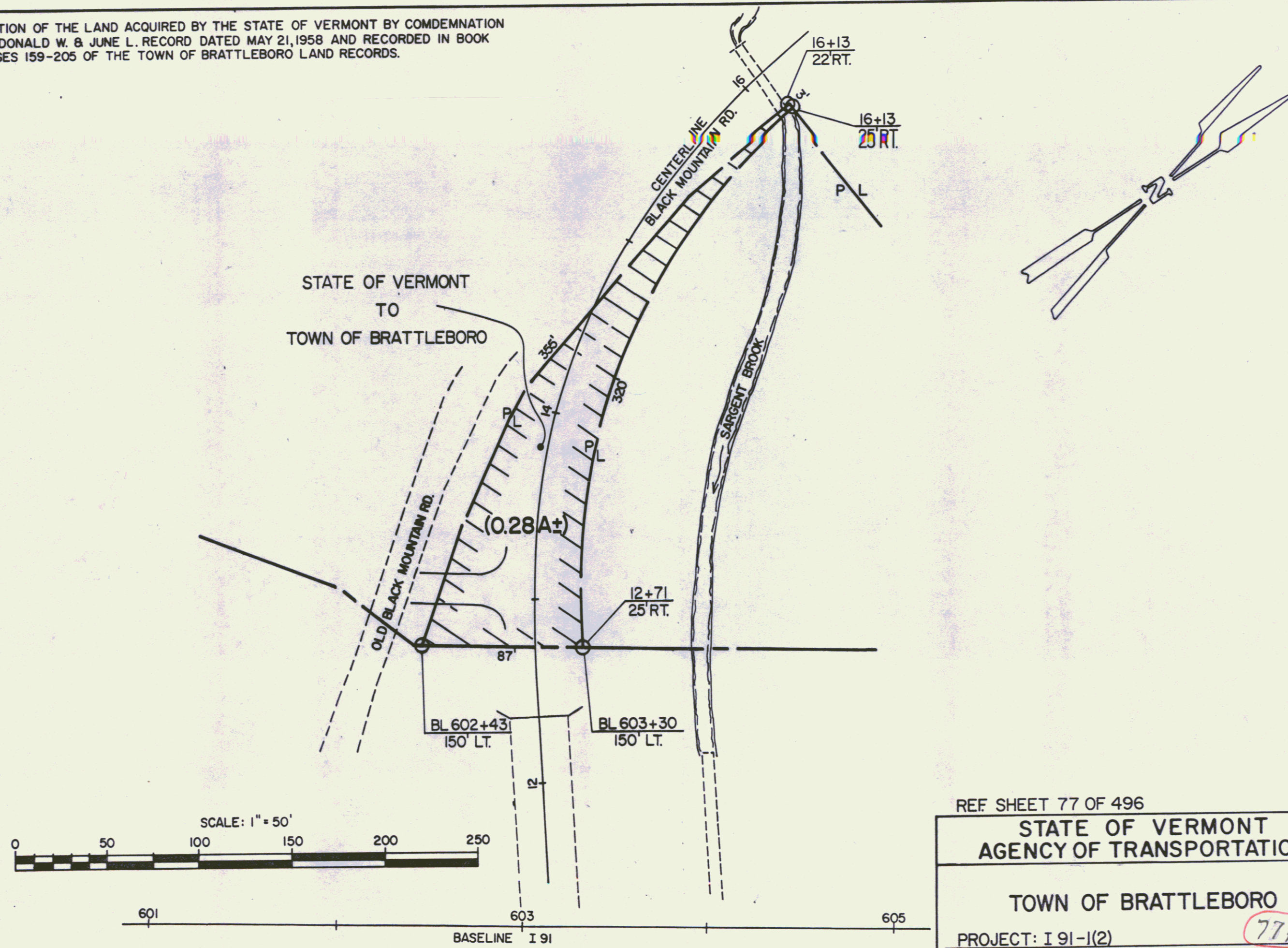

REF SHEET 77 OF 496  
**STATE OF VERMONT**  
**AGENCY OF TRANSPORTATION**  
**TOWN OF BRATTLEBORO**  
 PROJECT: I 91-1(2) 77A  
 APPROX. SCALE 1"=50'    DATE 9-2-83    DRAWN BY D.E.M.

20