

DRILLING OF SOLID ROCK SUBGRADE, ITEM 114-A
BLASTING OF SOLID ROCK SUBGRADE, ITEM 114-B
380+00 - 390+00

THREE CABLE GUARD RAIL w/ STEEL POSTS
LH 380+00 - 390+00 LH
RH 382+33 - 393+53 RH
LH 391+41 - 396+00 LH

THREE CABLE GUARD RAIL w/ STEEL POSTS
LH 378+96 - 390+00
RH 379+20 - 393+53
LH 391+41 - 396+00

FOR DETAILS ON RAMPS
AND ACCELERATION LANES
SEE SHEETS 37-40 OF 182

OSCAR G. & LYDIA H. LAWRENCE

CENTERLINE OFFSET TRANSITION
From 41' Sta 383+22.5
To 37' Sta 387+32

B.M. NO. 86
EL. 422.01

B.M. NO. 85
EL. 470.99

OSCAR G. & LYDIA H. LAWRENCE

B.M. 85-A EL. 479.84
Spot on LEADS
Sta 381+00

COW PASTURE
1 ELECTRIC WIRE
OUTSIDE R.O.W. FENCE

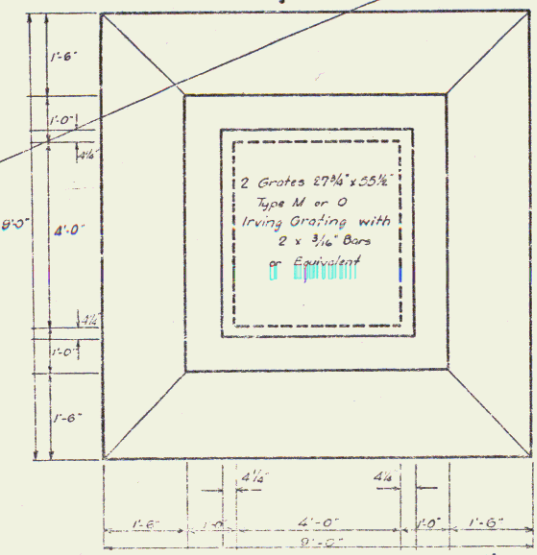

TOP VIEW - CATCH BASIN
SCALE: 1/4" = 1'-0"

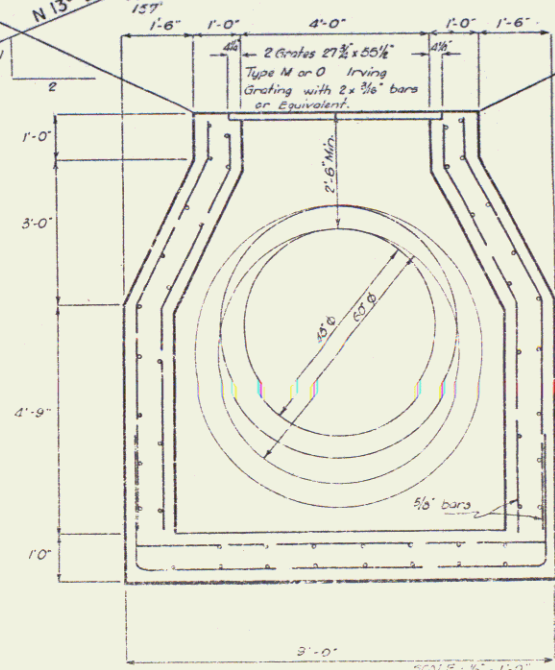

DESIRED SIZE OF CATCH BASIN AND JUNCTION BOX AT STA 395+78
SCALE: 1/4" = 1'-0"

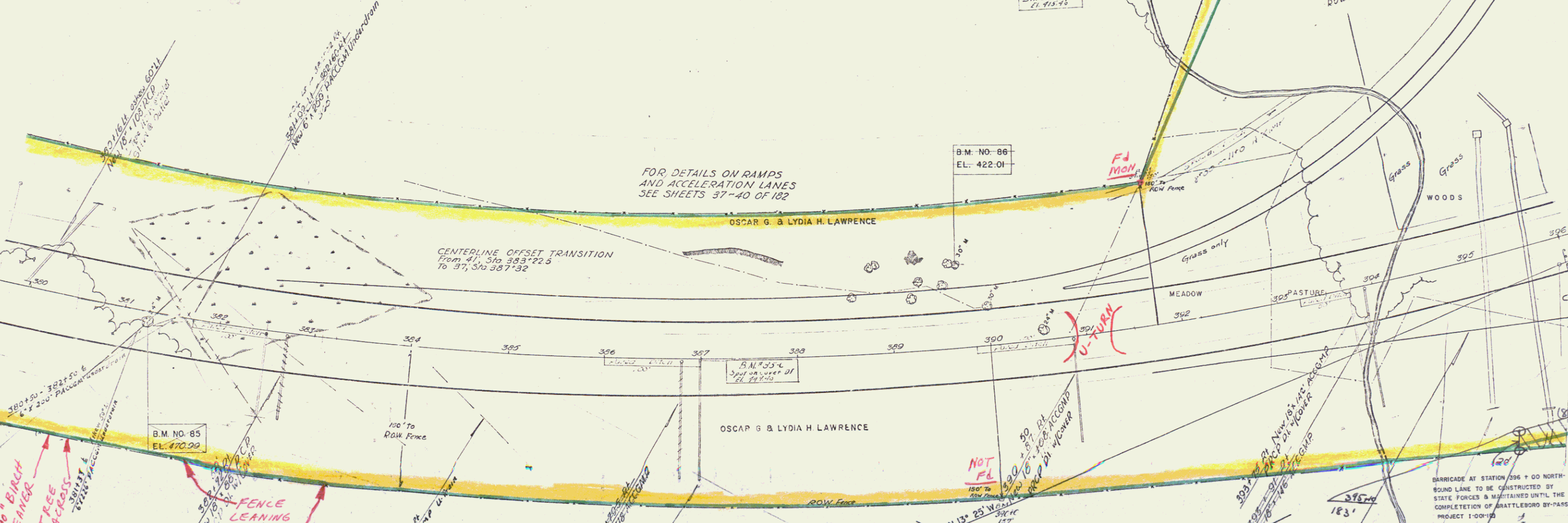

494' to side line
ROT. 17+00.0
Δ 48°41' L.

REV. P.I. 385+25.3 =
382+12.2

GUILFORD - BRATTLEBORO
Project 1-001-167 31161
Surveyed
Plotted
Traced
Sheet 28 of 182