

Property Line Fence With Steel Posts  
Item 583 - B  
944 + 00 To 958 + 00 Rt.  
944 + 00 To 953 + 63 Lt.  
954 + 00 To 958 + 00 Lt.

Bituminous Concrete Curb  
Item 21  
944 + 00 To 950 + 80 Rt.  
944 + 00 To 950 + 80 Lt.

Paved Median Gutter  
Item No. 351-B  
944 + 50 To 948 + 75  
949 + 00 To 949 + 25  
955 + 75 To 956 + 00

Bituminous Grouted Stone Gutter  
Item No. 553  
952 + 00 To 952 + 00  
952 + 00 To 952 + 00

Construct Special Ditch  
Item No. 101-A  
943 + 00 To 948 + 50 Rt.

Construct Drives  
L<sub>1</sub>  
954 + 00  
L<sub>2</sub>  
954 + 00

PUB. NO.	STATE	FED. AID PROJECT NO.	FISCAL YEAR	SHEET NO.	TOTAL SHEETS
1	VT	I-91-1(9)	POST WAR	64	530

Note: Location of Underdrain to be determined by the Engineer.

Gravel Backfill  
Item #222  
942 + 00 To 948 + 25 Rt.  
950 + 00 Lt. To 12 + 18 Rt. Ramp A

U.S. Rte. #5  
Curve Data  
Δ = 33° 05' Rt.  
D = 1"  
R = 5729.7'  
T = 1701.7'  
L = 3305.3  
E = 297.4

INTERSTATE  
Revised Curve Data  
Δ = 23° 42' 30" Rt.  
D = 2" 00"  
R = 2864.9'  
T = 601.3'  
L = 1185.4'  
E = 62.4'  
Bank 16 per ft.

Removing and Resetting Three Cable Guard Rail With Steel Posts  
452 + 91 To 453 + 19 Rt.

- LANDSCAPE MATERIAL  
94000-95000
- I. Trees
    - A. Evergreen
      1. Juniperus Virginiana - E. Red Cedar
      2. Thuja Occidentalis - E. Arborvitae (Pyramidal)
      3. Picea Strobus - E. White Pine
      4. Taxus Canadensis - Canada Redwood
    - B. Deciduous
      1. Betula Papyrifera - Paper Birch
      2. Quercus Borealis - Northern Red Oak
      3. Acer Saccharum - Sugar Maple
      4. Cornus Florida - Flowering Dogwood
  - II Shrubs
    - A. Evergreen
      1. Juniperus Sabina - Savin Juniper
    - B. Deciduous
      1. Symplocarpus Alba - Common Snowberry
      2. Rosa Multiflora - Japanese Rose
  - III Vines
    1. Vicia Mitor - Parthenocarpic

- IV General Notes
- A. Size of planting material
    1. Evergreen trees should be 2-3 feet in height
    2. Evergreen shrubs should be 12" to 18" in diameter (except for large spread of branches)
    3. Large deciduous trees should be 3/4" to 1" in diameter with a minimum height of 6 to 8 feet
    4. Small deciduous trees should be 1 1/2" to 2" in diameter
    5. All trees must have dormant buds not yet opening
    6. All soil material to be graded according to project standards for Nursery Stock.

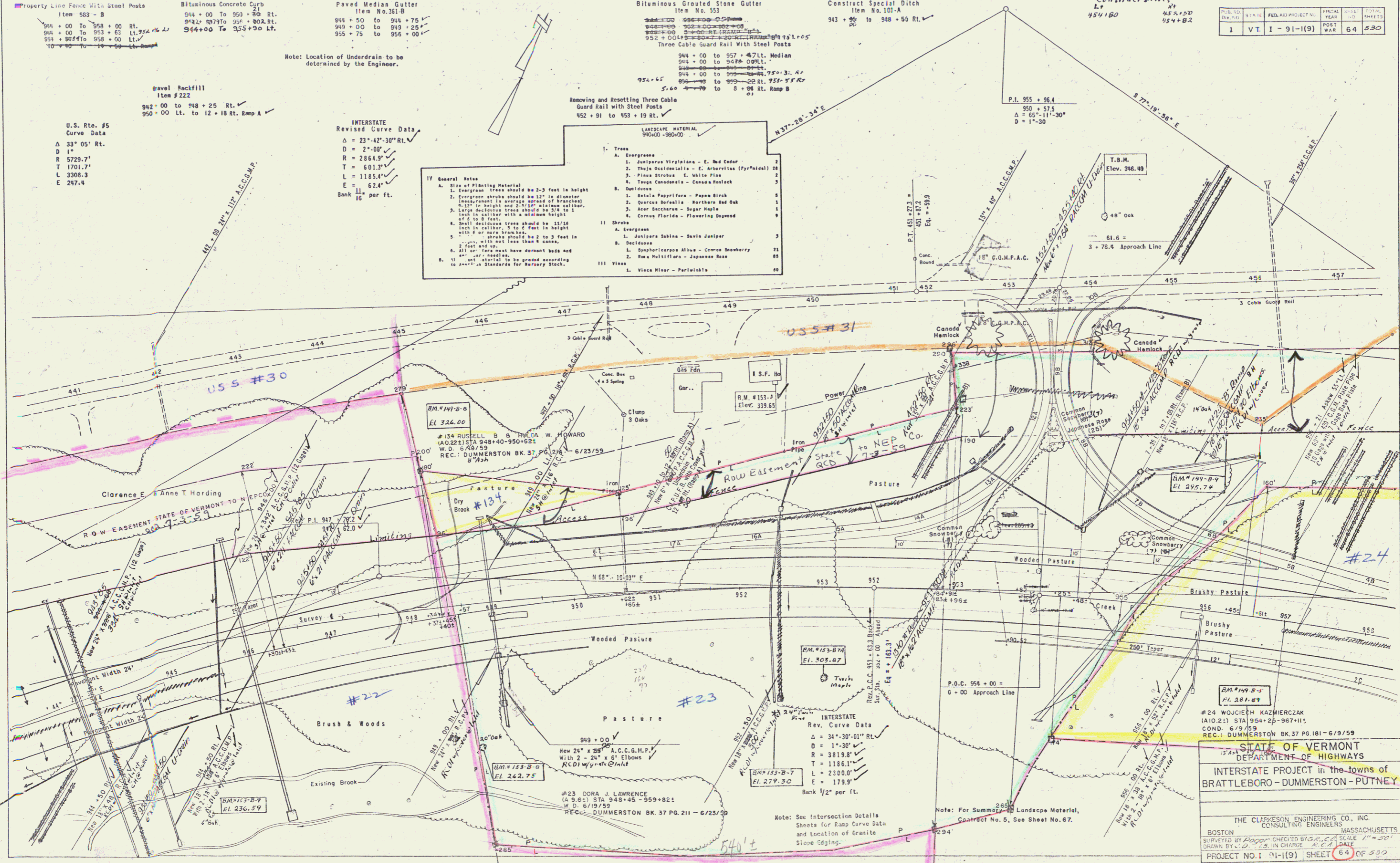

STATE OF VERMONT  
DEPARTMENT OF HIGHWAYS  
INTERSTATE PROJECT in the towns of  
BRATTLEBORO - DUMMERSTON - PUTNEY

THE CLARKESON ENGINEERING CO., INC.  
CONSULTING ENGINEERS  
BOSTON MASSACHUSETTS

PROJECT NO. 91-1(9) SHEET 64 OF 530

Note: See Intersection Details Sheets for Ramp Curve Data and Location of Granite Slope Edging.

Note: For Summary Landscape Material, Contact No. 5, See Sheet No. 67.

#22  
310 to North line T-24  
952+54 / 605'  
23