

Property Line Fence With Steel Posts
Item No. 583 - B
850 + 00 to 866 + 00 Lt. ✓
850 + 00 to 854 + 50 Rt.

Paved Median Gutter
Item 361 - B
852 + 50 To 852 + 75 ✓
860 + 50 To 860 + 75 ✓
865 + 35 To 865 + 60 ✓

CONSTRUCT R.O.W. FENCE
ACCORDING TO PLANS AND SPECIFICATIONS
BEFORE CONSTRUCTION IS BEGUN
850 + 00 - 866 + 00 Lt.

Bituminous Grouted Stone Gutter
Item No. 553
865 + 60 Lt. ✓
863 + 50 Lt. ✓
864 + 50 Lt. ✓
865 + 00 Rt. ✓

Three Cable Guard Rail With Steel Posts
Item No. 553
863 + 75 To 866 + 00 Lt. ✓
850 + 00 To 854 + 50 Rt. ✓
864 + 65 Lt. ✓
864 + 00 Rt. ✓

POST	WAR	53	530
1	VT.	1-91-(9)	

Revised Curve Data
 $\Delta = 51^{\circ} - 39' - 44''$ Lt.
 $D = 1^{\circ} - 35'$
 $R = 3516.5'$
 $T = 122.5'$
 $L = 662.5'$
 $E = 35.5'$
 BANK 1/2" PER FT.

U-Turn
Sta. 860+50

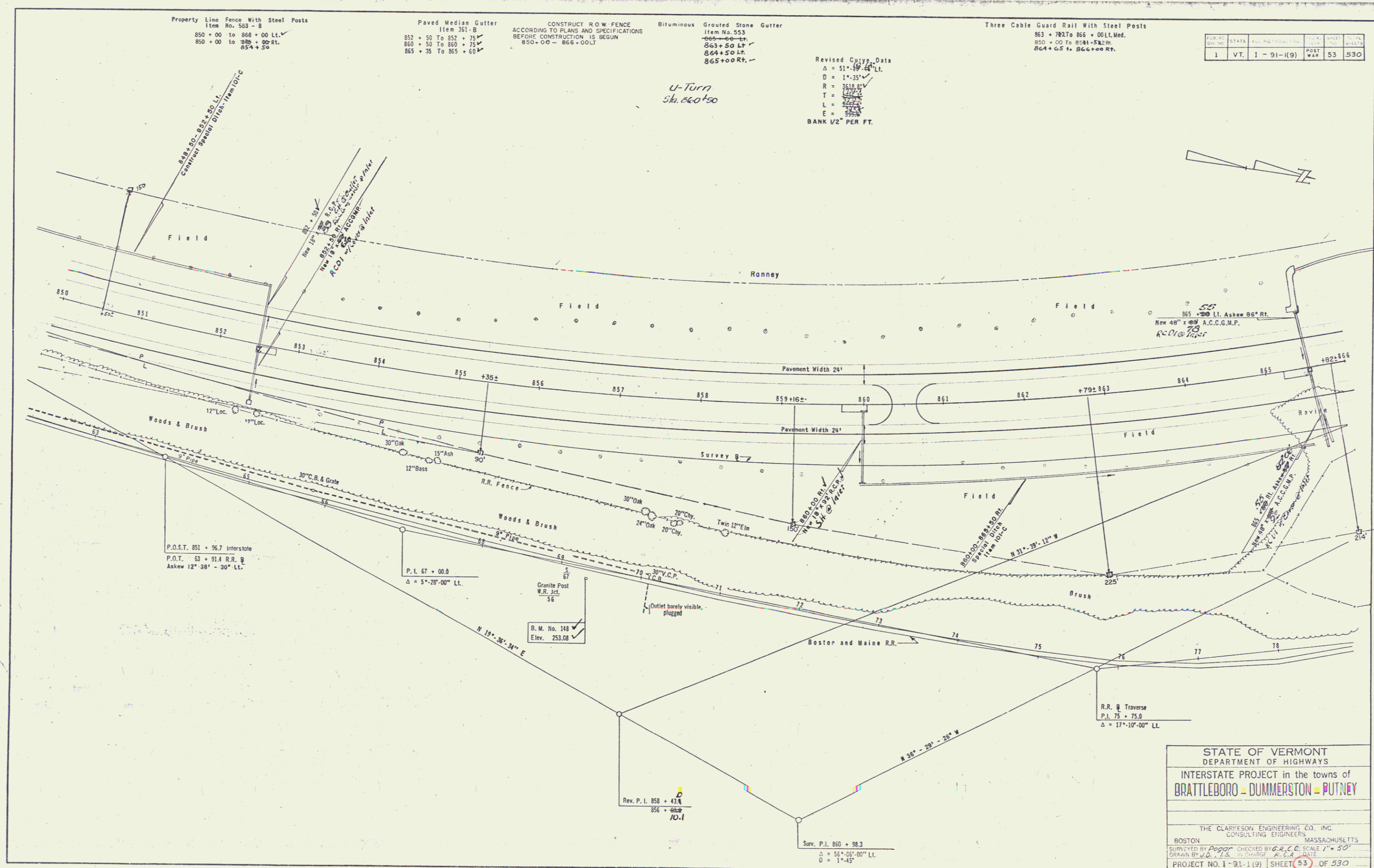

STATE OF VERMONT
DEPARTMENT OF HIGHWAYS
INTERSTATE PROJECT in the towns of
BRATTLEBORO - DUMMERSTON - PUTNEY

THE CLARIFESON ENGINEERING CO., INC.
CONSULTING ENGINEERS
BOSTON MASSACHUSETTS

SURVEYED BY *Pogor* CHECKED BY *G.C.C.* SCALE 1" = 50'
DRAWN BY *J.B.* IN CHARGE *A.C.C.* DATE
PROJECT NO. 1-91-1(9) SHEET 53 OF 530