

CONSTRUCT R.O.W. FENCE
ACCORDING TO PLANS AND SPECIFICATIONS
BEFORE CONSTRUCTION IS BEGUN
802+00 - 818+00 LT.

Property Line Fence With Steel Posts
Item No. 553-B
802+00 to 818+00 Lt.
802+00 to 818+00 Rt.
Three Cable Guard Rail With Steel Posts
807+00 To 818+00 Rt. Med.
808+00 to 818+00 Rt. Med.
808+00 to 812+00 Lt. Med.
808+00 to 812+00 Lt. Med.

Bituminous Concrete Curb
Item No. 555
802+78 to 818+00 Rt. (Lt. Lane)
806+00 to 818+00 Rt.

Stone Fill for Slope Protection
Item No. 522
802+00
803+00

Bituminous Grouted Stone Gutter
Item No. 553
808+75 to 809+05 Lt. (Lt. Lane)
808+75 to 809+05 Lt. (Lt. Lane)
808+75 to 809+05 Lt. (Lt. Lane)
808+75 to 809+05 Lt. (Lt. Lane)

Gravel Backfill
Item No. 222
809+35 to 809+84 Lt.
809+50 to 812+65 Rt.
814+25 to 816+22 Rt.

PUB. NO.	STATE	FED. AID PROJECT NO.	FISCAL YEAR	SHEET NO.	TOTAL SHEETS
I	VT.	I-91-1(9)	POST WAR	48	530

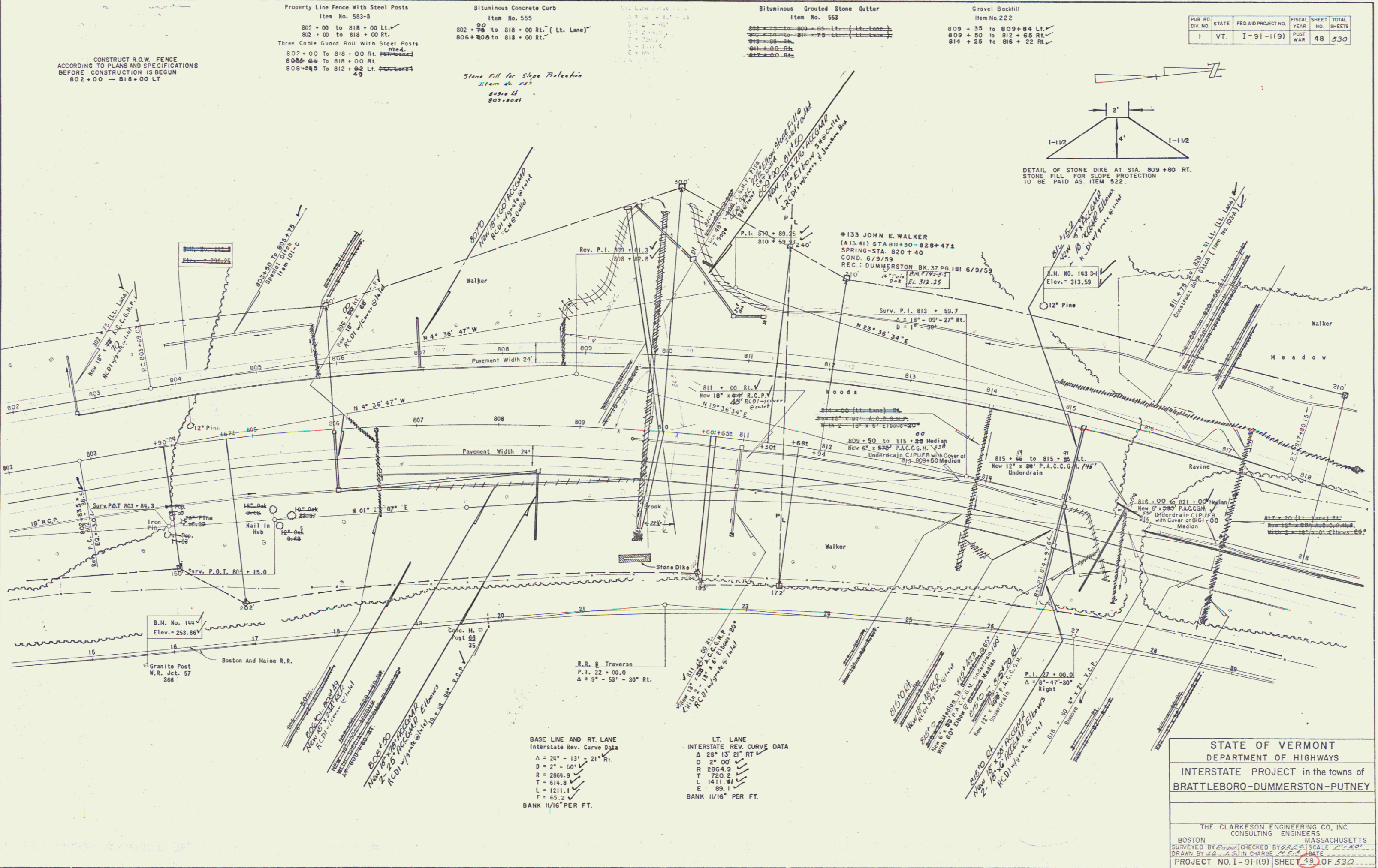
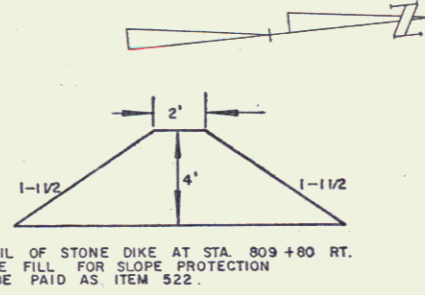

BASE LINE AND RT. LANE
Interstate Rev. Curve Data
Δ = 24° - 13' - 21" Rt.
D = 2' - 00"
R = 2864.9
T = 618.3
L = 1211.1
E = 65.2
BANK 1 1/16" PER FT.

LT. LANE
Interstate Rev. Curve Data
Δ = 28° - 15' - 21" Rt.
D = 2' - 00"
R = 2864.9
T = 720.2
L = 1411.8
E = 89.1
BANK 1 1/16" PER FT.

STATE OF VERMONT
DEPARTMENT OF HIGHWAYS
INTERSTATE PROJECT in the towns of
BRATTLEBORO-DUMMERSTON-PUTNEY

THE CLARKSON ENGINEERING CO., INC.
CONSULTING ENGINEERS
BOSTON MASSACHUSETTS
SURVEYED BY [Signature] CHECKED BY [Signature] SCALE 1" = 40'
DESIGNED BY [Signature] DRAWN BY [Signature] DATE [Date]
PROJECT NO. I-91(9) SHEET 48 OF 530