

Property Line Fence With Steel Posts
Item No. 583 - B
690 + 00 TO 706 + 00 LT.
690 + 00 TO 706 + 00 RT.

Bituminous Grouted Stone Gutter
Item No. 553
CONSTRUCT R.O.W. FENCE
ACCORDING TO PLAN AND SPECIFICATIONS
BEFORE CONSTRUCTION IS BEGUN
690 + 00 - 706 + 00 RT.

Drilling & Blasting of Solid Rock Subgrade
W.M. 114 A & B
696 + 00 TO 706 + 00 LT.
696 + 00 TO 706 + 00 RT.
697 + 20

Paved Median Gutter
Item No. 361-B
695 + 50 TO 695 + 50
695 + 75 TO 695 + 75
699 + 50 TO 700 + 50

Construct Special Ditch
Item No. 555
695 + 25 TO 695 + 25
696 + 75 TO 696 + 75
699 + 50 TO 699 + 50

Three Cable Guard Rail With Steel Posts
693 + 00 TO 695 + 3475 RT.
693 + 00 TO 695 + 3475 LT.

Bituminous Concrete Curb
Item No. 555
693 + 00 TO 695 + 3475 RT.
693 + 00 TO 695 + 3475 LT.

NO.	STATE	FED. AID PROJECT NO.	FISCAL YEAR	SHEET NO.	TOTAL SHEETS
1	VT.	I-91-(19)		36	530

INTERSTATE
CURVE DATA
Δ = 55° 36' 00" LT.
D = 214'
R = 2264.33
T = 1489.01500.8
L = 2967.0276407
E = 368.9
BANK 11/16" PER FT.

NOTE: Location of Underdrain to be determined by the Engineer

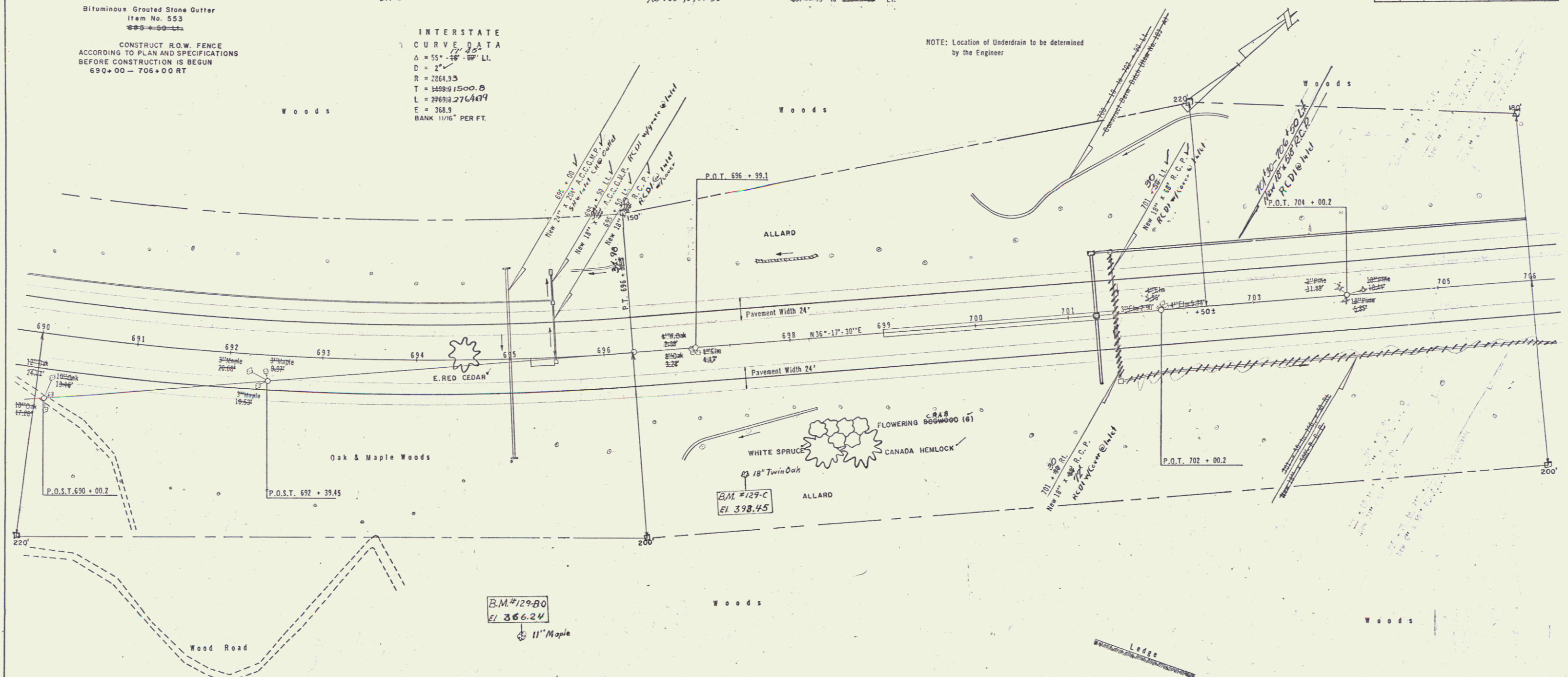

B.M. #129-B0
E.L. 366.24
11" Maple

B.M. #129-C
E.L. 398.45

888 + 50 - 900 + 00
LANDSCAPE MATERIAL

1. Trees	
1. Evergreens	4
2. Eastern Red Cedar	4
3. White Pine	4
4. White Spruce	4
5. Canada Hemlock	4
6. Red Cedar	4
7. Red Pine	4
8. Red Spruce	4
9. Norway Spruce	4
10. Fir	4
11. Spruce	4
12. Pine	4
13. Fir	4
14. Spruce	4
15. Pine	4
16. Fir	4
17. Spruce	4
18. Pine	4
19. Fir	4
20. Spruce	4
21. Pine	4
22. Fir	4
23. Spruce	4
24. Pine	4
25. Fir	4
26. Spruce	4
27. Pine	4
28. Fir	4
29. Spruce	4
30. Pine	4
31. Fir	4
32. Spruce	4
33. Pine	4
34. Fir	4
35. Spruce	4
36. Pine	4
37. Fir	4
38. Spruce	4
39. Pine	4
40. Fir	4
41. Spruce	4
42. Pine	4
43. Fir	4
44. Spruce	4
45. Pine	4
46. Fir	4
47. Spruce	4
48. Pine	4
49. Fir	4
50. Spruce	4
51. Pine	4
52. Fir	4
53. Spruce	4
54. Pine	4
55. Fir	4
56. Spruce	4
57. Pine	4
58. Fir	4
59. Spruce	4
60. Pine	4
61. Fir	4
62. Spruce	4
63. Pine	4
64. Fir	4
65. Spruce	4
66. Pine	4
67. Fir	4
68. Spruce	4
69. Pine	4
70. Fir	4
71. Spruce	4
72. Pine	4
73. Fir	4
74. Spruce	4
75. Pine	4
76. Fir	4
77. Spruce	4
78. Pine	4
79. Fir	4
80. Spruce	4
81. Pine	4
82. Fir	4
83. Spruce	4
84. Pine	4
85. Fir	4
86. Spruce	4
87. Pine	4
88. Fir	4
89. Spruce	4
90. Pine	4
91. Fir	4
92. Spruce	4
93. Pine	4
94. Fir	4
95. Spruce	4
96. Pine	4
97. Fir	4
98. Spruce	4
99. Pine	4
100. Fir	4

General Notes
A. Size of Planting Material
1. Evergreen trees should be 3 year old transplants or older.
2. Evergreen shrubs should be 1 1/2" in diameter (measurement in average spread of branches).
3. Large deciduous trees should be 1 1/2" to 1 3/4" inches in caliper with a minimum height of 7 to 8 feet.
4. Small deciduous trees should be 1 1/2" to 2" in caliper, 5 to 7 feet in height with 3 or more branches.
5. Deciduous shrubs should be 2 to 3 feet in height with not less than 3 stems, 2 feet one up.
6. Coniferous shrubs shall be 8"-12" in height and 2 1/2" minimum caliper. All conifers must have dormant buds and secondary needles.
7. Perennials to be planted 2-5 feet apart.
B. All plant material to be graded according to American standards for nursery stock.
C. Fertilizer to be applied at the same time as the grass seed at the rate of 80 lbs. per acre.

STATE OF VERMONT
DEPARTMENT OF HIGHWAYS
INTERSTATE PROJECT in the towns of
BRATTLEBORO - DUMMERSTON - PUTNEY
THE CLARKSON ENGINEERING CO., INC.
CONSULTING ENGINEERS
BOSTON MASSACHUSETTS
SURVEYED BY [Signature] CHECKED BY [Signature] SCALE 1" = 50'
DRAWN BY [Signature] IN CHARGE [Signature] DATE [Date]
PROJECT NO. 1-91-1(9) SHEET 36 OF 530