

Paved Median Gutter
Item No. 361 - B
675 + 60 To 675 + 85
680 + 50 To 680 + 75
686 + 00 To 686 + 25

Bituminous Grouted Stone Gutter
Item No. 563
RT. LT.

Bituminous Concrete Curb
Item No. 555
RT. LT.

Three-Cable Guard Rail With Steel Posts
Item No. 114 MOD.
674 + 00 To 675 + 00 RT.
674 + 00 To 675 + 00 LT.
685 + 75 To 686 + 00 RT.
685 + 75 To 686 + 00 LT.

DRILLING AND BLASTING OF SOLID ROCK SUBGRADE
ITEM 114 MOD.
689 + 50 To 689 + 50 LT.

PLAN NO.	STATE	FED. AID PROJECT NO.	SHEET NO.	TOTAL SHEETS
1	VT.	1-91-1(9)	34	530

CONSTRUCT R.O.W. FENCE
ACCORDING TO PLANS AND SPECIFICATIONS
BEFORE CONSTRUCTION IS BEGUN
674 + 00 - 689 + 00 RT.
672 + 50

CURVE DATA
INTERSTATE
 $\Delta = 55^\circ - 27' - 00''$ LL
 $D = 2'$
 $R = 28513'$
 $T = 15339'$
 $L = 30677'$
 $E = 15333'$
BANK 11/16" PER FT.

Property Line Fence With Steel Posts
Item No. 583 - B
674 + 00 to 680 + 00 RT.
674 + 00 to 680 + 00 LT.

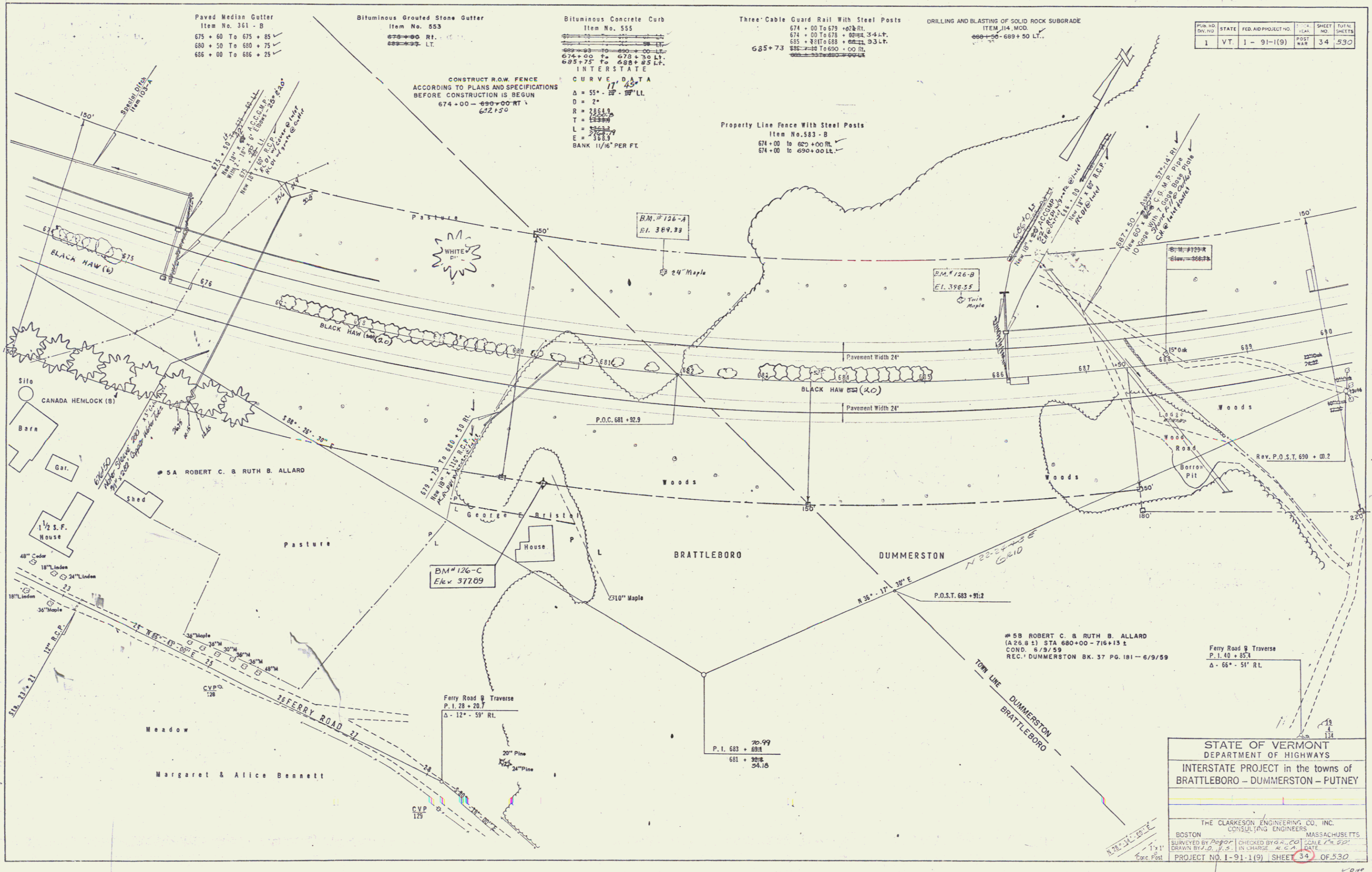

STATE OF VERMONT
DEPARTMENT OF HIGHWAYS
INTERSTATE PROJECT in the towns of
BRATTLEBORO - DUMMERSTON - PUTNEY

THE CLARKSON ENGINEERING CO., INC.
CONSULTING ENGINEERS
BOSTON MASSACHUSETTS
SURVEYED BY [Name] CHECKED BY [Name] SCALE 1" = 20'
DRAWN BY [Name] IN CHARGE [Name] DATE [Date]
PROJECT NO. 1-91-1(9) SHEET 34 OF 530