

* STANDARD STEEL BEAM
GUARD RAIL W/ STEEL
POSTS, ITEM 545-A
N.B. 3617+98 - 3619+52 Lt
S.B. 3619+38 - 3620+00 Lt

DRILLING AND BLASTING
SOLID ROCK SUBGRADE
ITEM 115
N.B. 3607+50 - 3609+00

* THREE CABLE GUARD RAIL W/ LIGHT
STEEL POSTS, ITEM 538
N.B. 3604+00 - 3604+49 Rt.

21P-RAP FOR BANK PROTECTION
FOR CULVERT ENDS, Item 513-B
S.B. 3619+30 Lt.
N.B. 3619+00 Rt.
PROPERTY LINE FENCE
ITEM 585, II, MOD
3604+00 Lt - 3620+00 Lt
3604+00 Lt - 3620+00 Rt

* BITUM CONC SURF FOR
GUTTERS AND TRAFFIC
ISLANDS, ITEM 554
3609+75 - 3610+00 Med
3609+75 - 3610+00 S.B. Lt
3609+75 - 3610+00 N.B. Rt
3613+75 - 3614+00 Med
3617+75 - 3618+00 Med

STA.	LOC.	OFFSET	DESCRIPT.
BL 3613+00	RT.	600'	FARM POND
BL 3614+00	LT.	2000'	DUG WELL
BL 3618+00	LT.	1500'	DUG SPRING

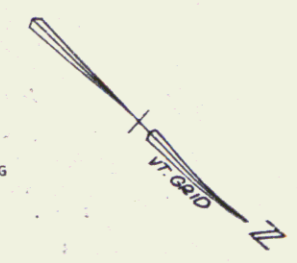

* STAGE II CONSTRUCTION ITEM

PLAN	REVISION	DATE	BY	CHKD
1	1			
2	1			
3	1			
4	1			
5	1			

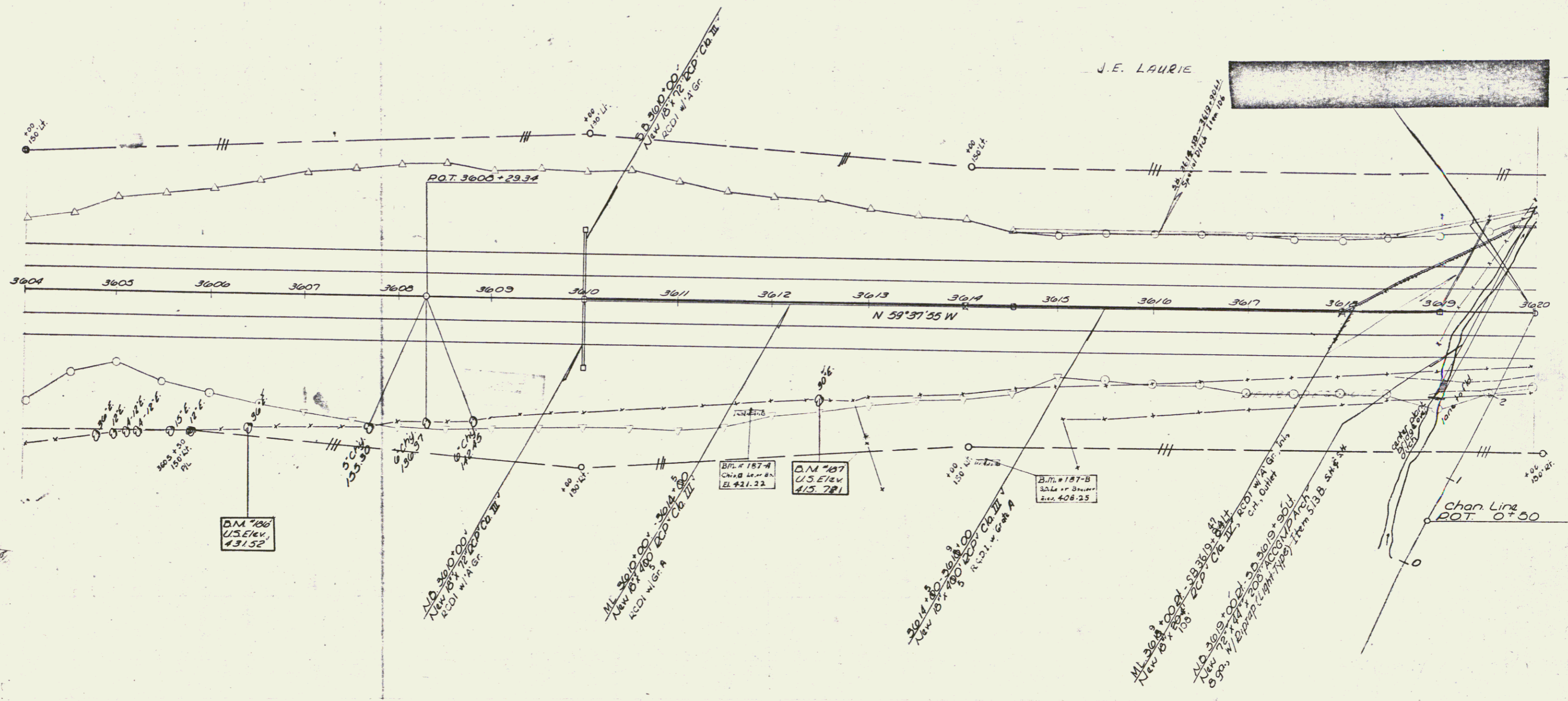

J.E. LAURIE

CONTROL OF ACCESS COMPLETE ON THIS SHEET

Stage 2 Construction
ST ALBANS - SWANTON
I 89 - 5/30/42
Sheet 50 of 153

64