

THREE CABLE GUARD RAIL w/ STEEL POSTS
ITEM
 NB 3572+00 - 3582+63 Q1
 NB 3582+28 - 3582+58 Lt
 NB 3584+67 - 3584+97 Lt
 NB 3584+62 - 3584+00 Q1
 SB 3577+27 - 3582+63 Lt
 SB 3582+28 - 3582+58 Q1
 SB 3584+67 - 3584+97 Q1
 SB 3584+62 - 3584+00 Lt

Circular Curve Data
 Δ 65° 08' 15" Lt
 D 2° 30'
 L 2291.83
 T 1483.95
 L 2605.50
 C 427.92
 bank 1 1/8" per ft

Spiral Curve Data

PLAN
 DRAWN BY: [illegible]
 CHECKED BY: [illegible]
 DATE: [illegible]

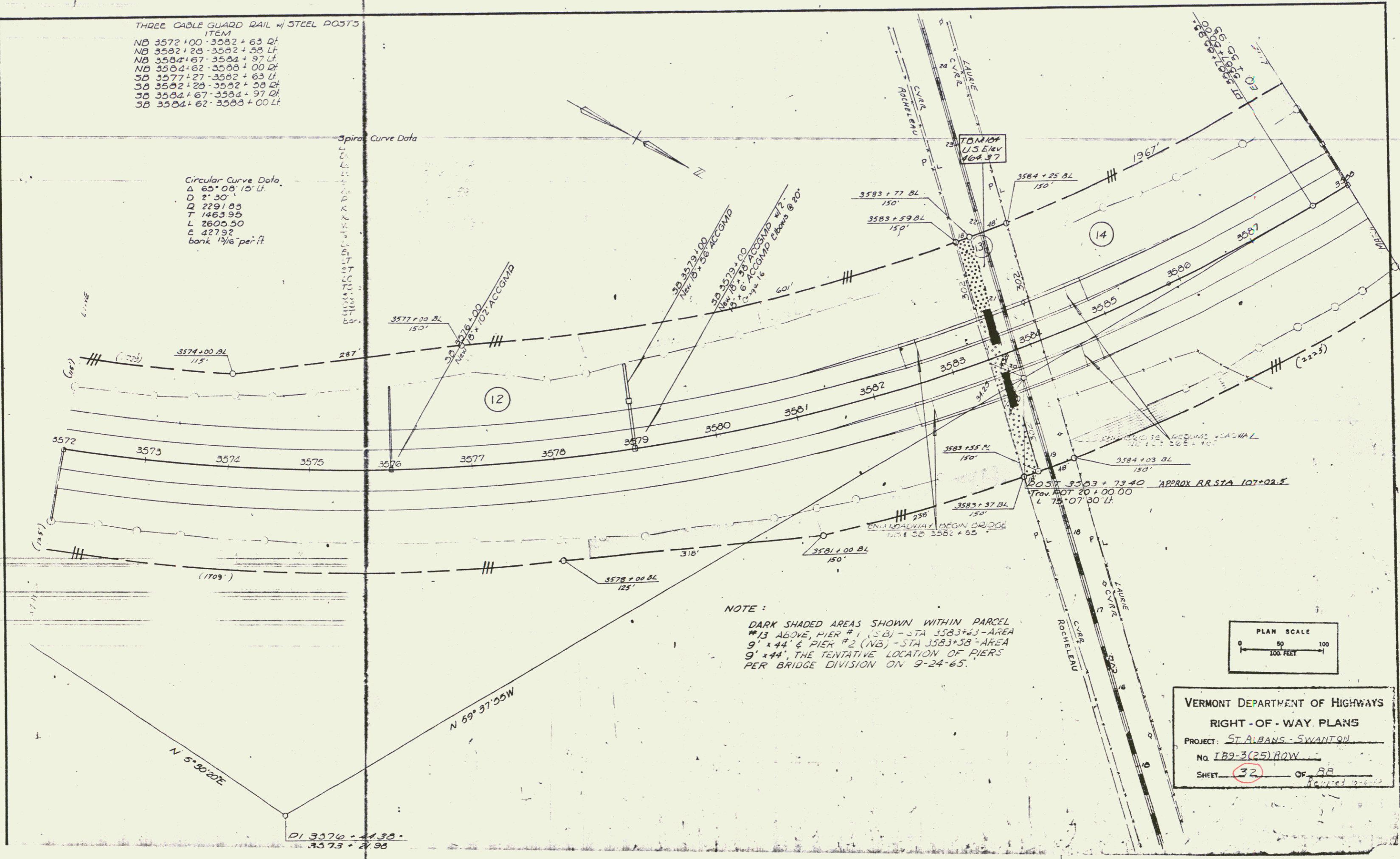

NOTE:
 DARK SHADED AREAS SHOWN WITHIN PARCEL
 #13 ABOVE, PIER #1 (SB) - STA 3583+63 - AREA
 9' x 44' & PIER #2 (NB) - STA 3583+58 - AREA
 9' x 44', THE TENTATIVE LOCATION OF PIERS
 PER BRIDGE DIVISION ON 9-24-65.

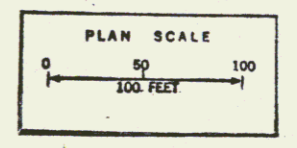

VERMONT DEPARTMENT OF HIGHWAYS
 RIGHT-OF-WAY PLANS
 PROJECT: ST ALBANS - SWANTON
 No. 189-3(25) ROW
 SHEET 32 OF 88