

KEITH, PETER, & KATHERINE (PRATT) JENNISON  
 I-89-3(25) PARCEL No. 25  
 TOTAL ACREAGE 450.0A ±  
 TAKING 1.7A ±  
 REMAINING 448.3 A ±  
 LOSS OF ACCESS 0.0A.



W. PALSTON & ECHO M. DECKER  
 I-89-3(25) PARCEL No. 24  
 TOTAL ACREAGE 150.0 A ±  
 TAKING 15.5 A ±  
 REMAINING 134.5 A ±  
 LOSS OF ACCESS 12.8 A ±



KENNETH F. & IRENE L. CASEY  
 I-89-3(25) PARCEL No. 26  
 TOTAL ACREAGE 136.0 A ±  
 TAKING 15.2 A ±  
 REMAINING 120.8 A ±  
 LOSS OF ACCESS 0.0A.

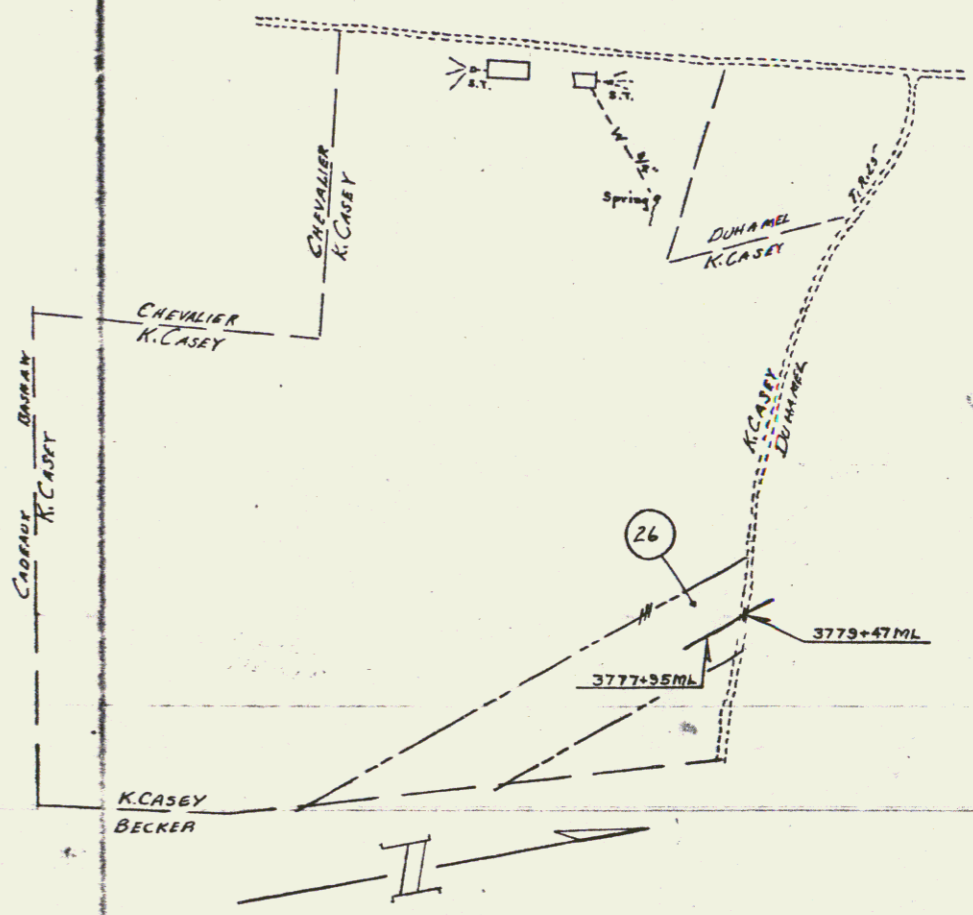

VERMONT DEPARTMENT OF HIGHWAYS  
 RIGHT OF WAY PLANS  
 PROJECT ST. ALBANS-SWANTON  
 No. I-89-3(25)  
 SHEET 16 OF 88