

THREE CABLE GUARD RAIL W/ LIGHT STEEL POSTS  
 ITEM 533  
 Ramp 'D' 0+00 - 10+00 Rt. 14  
 3426+00 NB Df - 3441+00 NB Df  
 3426+00 SB Lt - 3430+00 SB Lt  
 3437+80 S.B.Lt - 3444+64 S.B.Lt  
 0+00 Ramp 'D' - 10+00 Rt.  
 BITUMINOUS CONCRETE CURB - ITEM 550 Type II  
 0+00 Ramp 'D' Lt. 10+00 Ramp 'D' Rt.

BITUMINOUS CONCRETE SURFACE EG  
 GUTTERS and TRAFFIC ISLANDS, Item 554 Mod  
 3442+70 - 3442+80 (Median)

JUTE MATTING - ITEM 623  
 Ramp 'D' 4+75 - 8+75 Median

STONE FILL for SLOPE PROTECTION  
 ITEM 512  
 3428+00 - 3432+70 NB Df  
 3432+80 - 3435+00 NB Df

PROPERTY LINE FENCE w/ STEEL  
 POSTS MOD. ITEM 583-II  
 SB 3428+00 - 3444+00 Lt.  
 NB 3428+00 - 3444+00 Rt.

TREATED TIMBER CURB, ITEM 550  
 Ramp 'D' 0+00 - 10+00 Rt.

INDIVIDUAL WATER SOURCES

CONC. COLLECT. CISTERN	N.B.L.	3430±	800' RT
DUG SPRING	N.B.L.	3432±	1000' RT
FARM POND	B.L.	3432±	BL ±
DUG SPRING	N.B.L.	3435±	2500' RT
DUG SPRING	N.B.L.	3438±	2400' RT
DUG SPRING	N.B.L.	3438±	2600' RT

NOTE: \* DENOTES ITEMS TO BE INCLUDED IN STAGE II CONSTRUCTION.

Construct U Turn  
 3443+85

CONTROL OF ACCESS IS COMPLETE ON THIS SHEET.

NB & SB Curve Data  
 Δ 19° 45' 30" Lt  
 D 1° 00' 00"  
 R 5729.50  
 T 997.85  
 L 1975.84  
 E 86.24

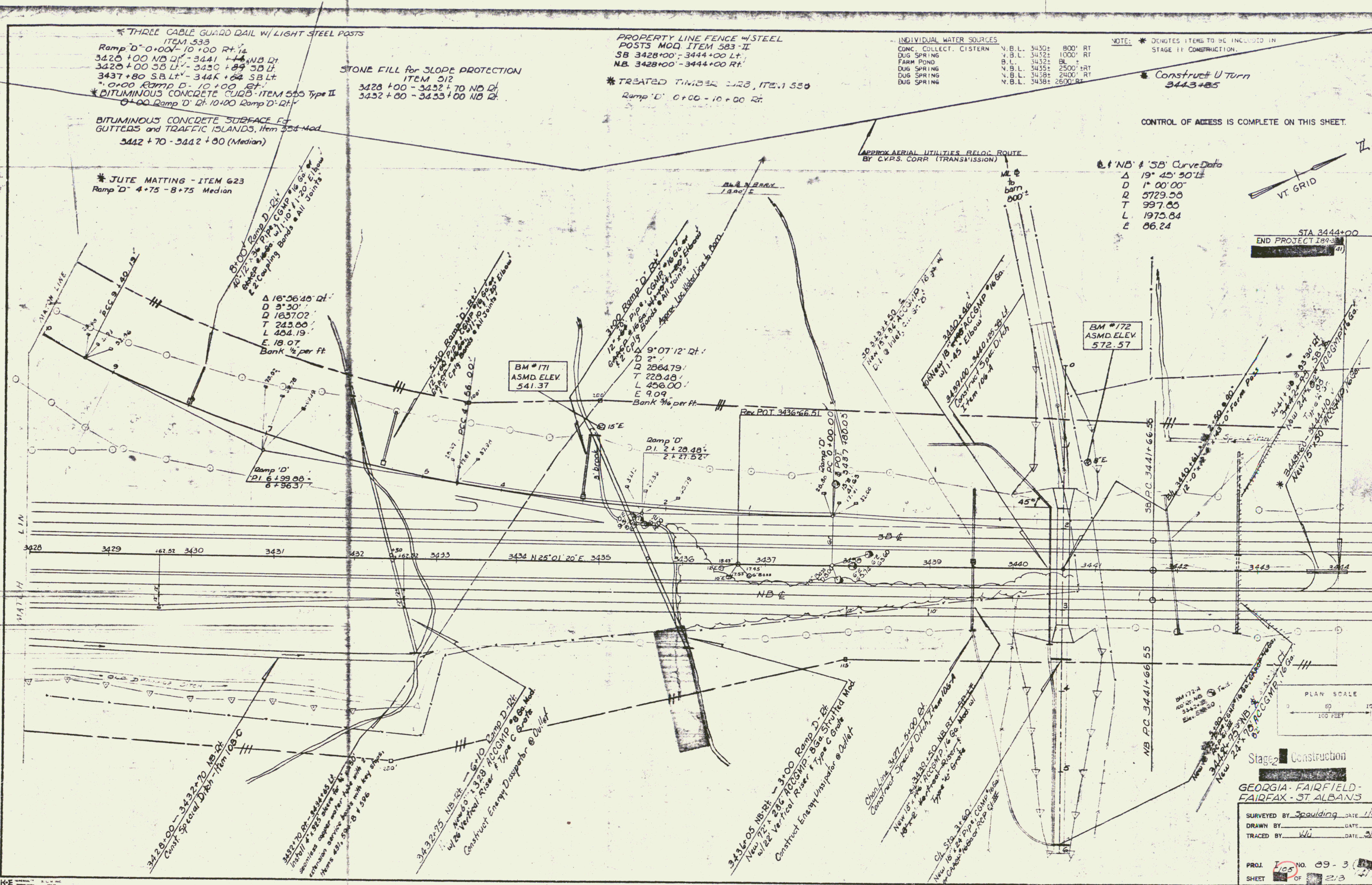
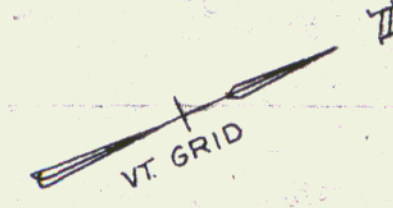

END PROJECT 189-3  
 STA 3444+00

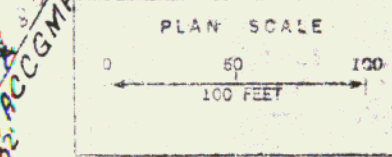

Stage 2 Construction  
 GEORGIA - FAIRFIELD - FAIRFAX - ST. ALBANS

SURVEYED BY Spaulding DATE 1/63  
 DRAWN BY DATE  
 TRACED BY Wu DATE 3/64

PROJ. 105 NO. 89-3 (2)  
 SHEET OF 2/3

87  
 Row