

PROPERTY LINE FENCE W/ STEEL POSTS, MOD. * THREE CABLE GUARD RAIL W/ ITEM 583-II
 LIGHT STEEL POSTS ITEM 538
 S.B. 3284+00-3296+40 Lt.
 N.B. 3284+00-3296+40 Rt.
 S.B. 3297+60-3300+00 Lt.
 N.B. 3297+60-3300+00 Rt.

DRILLING & BLASTING OF SOLID
 ROCK SUBGRADE, ITEM 115
 S.B. 3284+00-3285+60

* BITUMINOUS CONCRETE
 CURB - ITEM 555 TYPE II
 S.B. 3287+50-3296+33 Lt.
 8' x 8'

* JUTE MATTING - ITEM 623
 S.B. 3284+00-3287+00 Lt.
 N.B. 3285+00-3288+00 Rt.
 N.B. 3285+00-3288+00 Lt.
 N.B. 3297+00-3300+00 Lt.

INDIVIDUAL WATER SOURCES

ST. ALBANS CITY WATER
 BL 3297+60 Ask. - BL Ask.
 SBL 3286+ - 550' LT.
 Rev. N.B.
 Δ 4°36'42" Lt.
 D 0°14'05"
 E 24323.231
 T 779.42
 L 1957.79
 E 19.71
 Bank by Penetr. R.C.

NOTE: * DENOTES ITEMS TO BE INCLUDED IN STAGE II CONSTRUCTION

Curve Data
 Δ 5°29'00" Lt.
 D 0°15'00"
 R 22918.52
 T 1097.46
 L 2193.33
 E 26.13

N.B. 3298+54-3300+00 Rt.

STD. STEEL BEAM GUARD
 RAIL W/ STEEL POSTS ITEM 545-A (6'3" c/c)
 Vt. #104 29+25 - 30+75 Lt. Stage I Constr.
 Vt. #104 29+25 - 30+75 Rt.
 * S.B. 3296+34 Rt. - N.B. 3296+47 Lt. Stage II
 * S.B. 3298+17 Rt. - N.B. 3298+30 Lt. (6'3" c/c)

* Construct U Turn
 3288+50

CONTROL OF ACCESS IS COMPLETE ON THIS SHEET.

PLAN	REVISED	BY	DATE
		Consulting	
		Company	
		Alignment	
		Checked	
		Drawn	
		Tracked	
		Field	

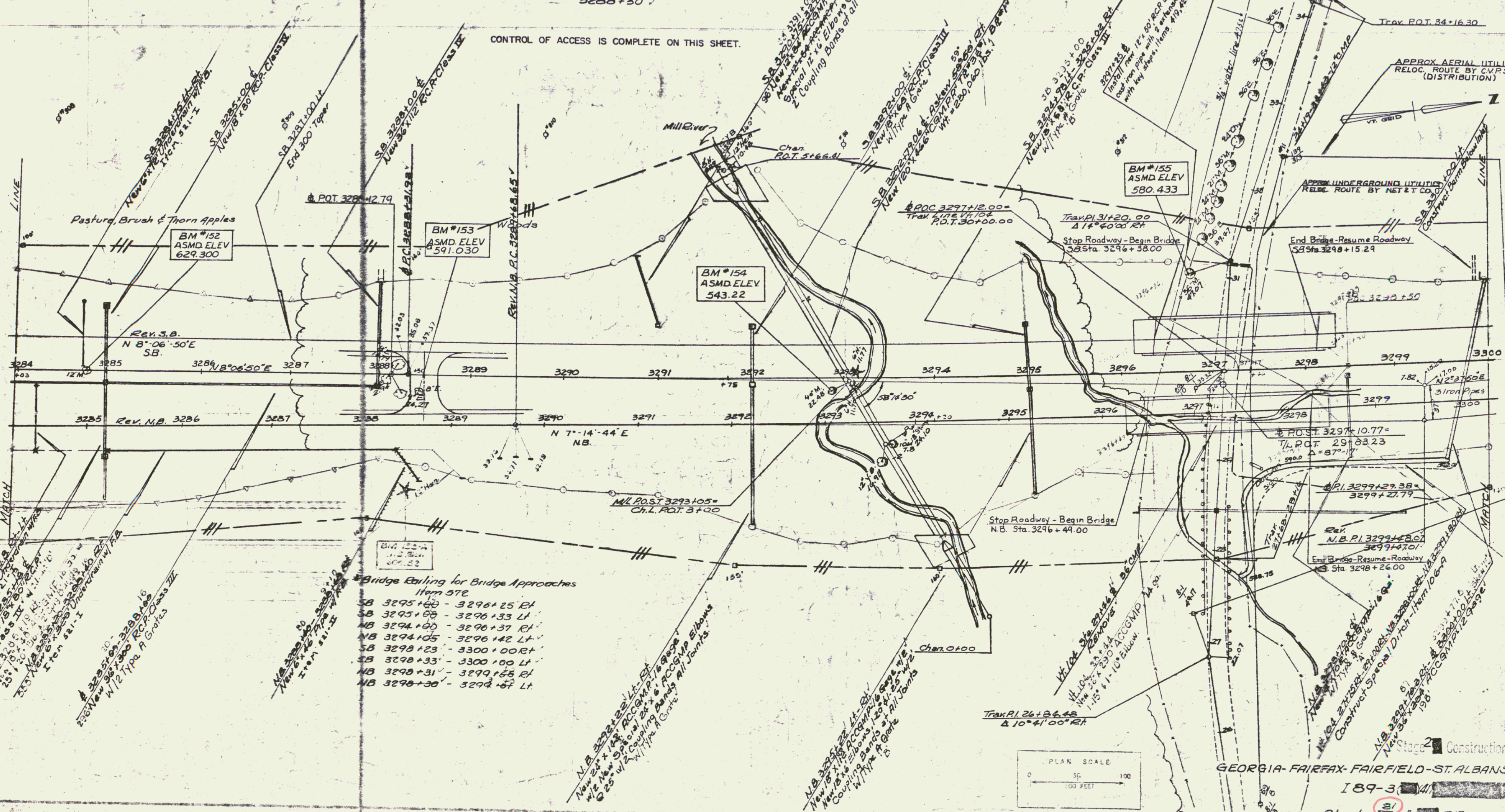

Bridge Railing for Bridge Approaches
 Item 572
 S.B. 3295+60 - 3296+25 Rt.
 S.B. 3295+60 - 3296+33 Lt.
 N.B. 3294+00 - 3296+37 Rt.
 N.B. 3294+05 - 3296+42 Lt.
 S.B. 3298+23 - 3300+00 Rt.
 S.B. 3298+33 - 3300+00 Lt.
 N.B. 3298+31 - 3299+65 Rt.
 N.B. 3298+30 - 3299+67 Lt.

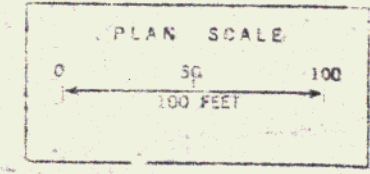

GEORGIA-FAIRFAX-FAIRFIELD-ST. ALBANS
 I 89-3
 Sheet 31 of 213