

DATE	BY
APPROVED	DESIGNED
NOTED	CHECKED
REVISIONS	PLACED
NO.	FILE

DRILLING & BLASTING OF SOLID
ROCK SUBGRADE, ITEM 115
N.D. 3273+00-3277+00
S.D. 3272+00-3284+00
N.D. 3279+00-3284+25.00
S.D. 3274+01-3282+52
N.D. 3280+75-3283+00

PROPERTY LINE FENCE w/ STEEL POSTS, MOD
Item 583-II
S.B. 3268+00-3284+00 Lt.
N.B. 3268+00-3284+00 Rt.

JUTE MATTING-ITEM 623
S.B. 3268+00-3270+50 Rt.
S.B. 3283+00-3284+00 Lt.

INDIVIDUAL WATER SOURCES
DOG SPRING S.B.L. 3274± - 700'± LT
WATER POOL S.B.L. 3279± - 700'± LT
NOTE: * DENOTES ITEMS TO BE
INCLUDED IN STAGE II CONSTRUCTION.

REV. S.B.
A 3°19'00" Lt.
D 0°15'00"
R 2298.52
T 668.52
L 1326.67
E 9.51
Bank 1/4" per ft.

FOR CONSTRUCTION DETAILS OF UTILITY RELOCATION
AND REST AREA, SEE FOLLOWING SHEET

BM #150
ASMD ELEV
649.689

BM #151
ASMD ELEV
651.949

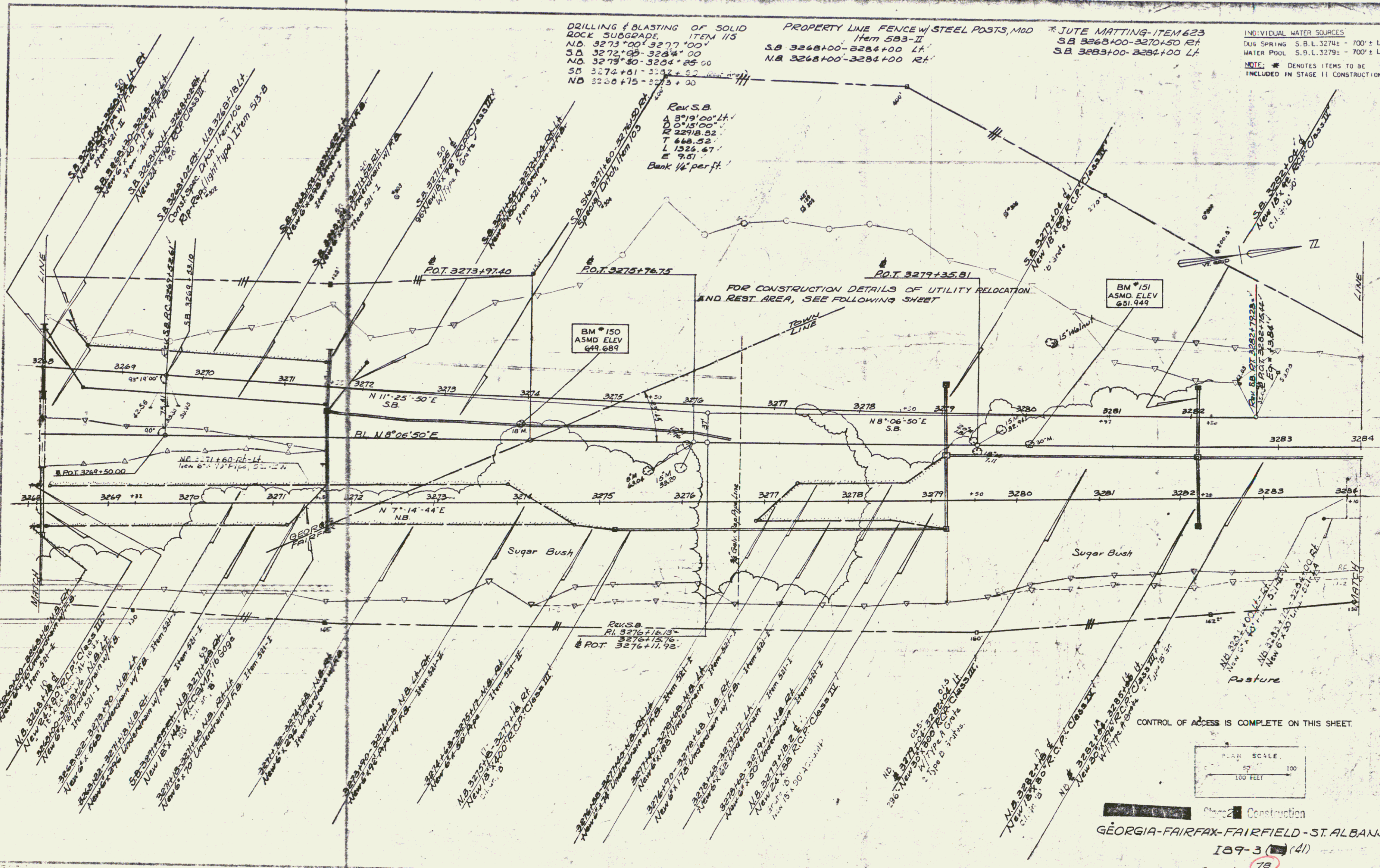

CONTROL OF ACCESS IS COMPLETE ON THIS SHEET.

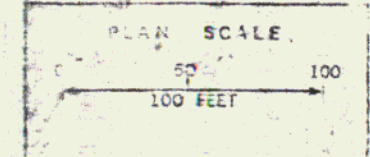

Class 2 Construction
GEORGIA-FAIRFAX-FAIRFIELD-ST. ALBANS
189-3 (41)
Sheet 78 of 213