

PLAN	SUBMITTED	DATE
NO.	BY	12/02
	SCHEMATIC	
	DESIGNED	
	CHECKED	
	DATE	1/1/03

THREE CABLE GUARD RAIL W/  
LIGHT STEEL POSTS ITEM 538  
NB 3252+00 - 3262+45 Lt.

PROPERTY LINE FENCE W/STEEL POSTS, MOD. \* JUTE MATTING- ITEM 623  
S.B. 3252+00-3268+00 Lt.  
N.B. 3252+00-3268+00 Rt.

INDIVIDUAL WATER SOURCES  
DUG SPRING S.B.L. 3263+50 - 600'± LT  
DUG FARM PAST. POND S.B.L. 3266+20 - 465'± LT  
NOTE: \* DENOTES ITEMS TO BE INCLUDED IN  
STAGE III CONSTRUCTION.

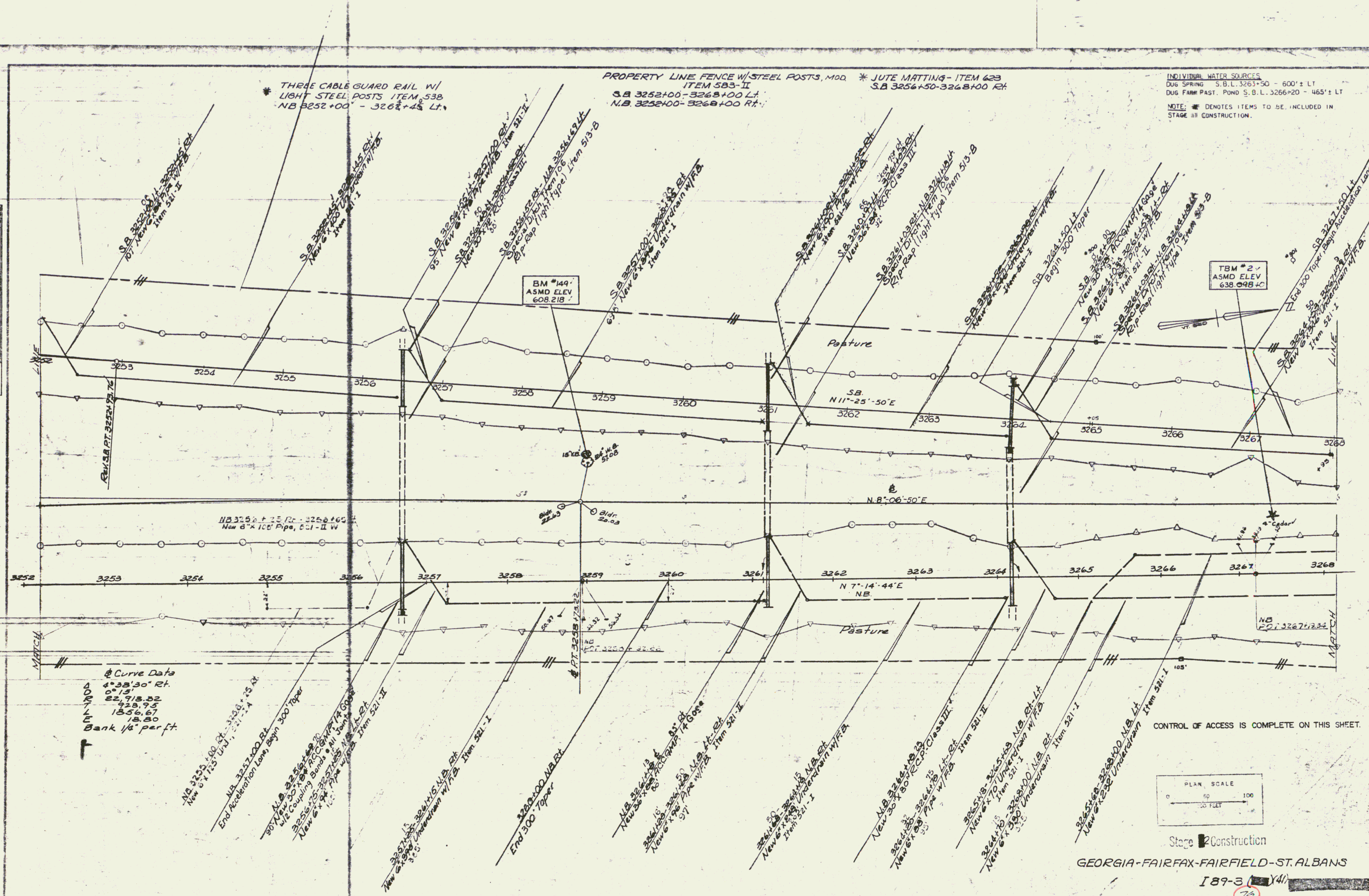

Curve Data  
4°38'30" Rt.  
0.15'  
22.918.52  
328.95  
1856.67  
18.80  
Bank 1/4" per ft.

CONTROL OF ACCESS IS COMPLETE ON THIS SHEET.

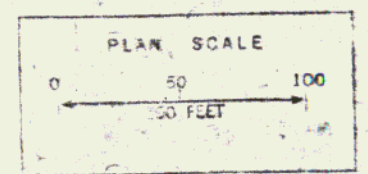

Stage II Construction  
GEORGIA-FAIRFAX-FAIRFIELD-ST. ALBANS  
189-3 (Y41)  
Sheet 76 of 213