

PLANK GUARD RAIL  
ITEM 540  
NB 3137+75-R

DEMOLITION AND DISPOSAL  
OF BUILDING, ITEM 586  
3126+25-NB Lt.  
3126+25-NB E

PROPERTY LINE FENCE w/  
STEEL POSTS, MOD. ITEM 583-II  
S.D. 3125+00-3141+00 Lt.  
N.B. 3131+00-3139+00 Rt.

\*THREE CABLE GUARD RAIL w/  
LIGHT STEEL POSTS ITEM 538  
S.D. 3126+50-3141+00 Lt.  
NB 3125+00-3125+95 Lt.  
\*DITUMINOUS CONCRETE  
CURB, ITEM 555 TYPE II  
S.B. 3127+50-3133+51 Lt.  
\*TREATED TIMBER CURB  
ITEM 558  
S.B. 3127+48-3133+54

DRILLING & BLASTING OF SOLID  
ROCK SUBGRADE ITEM 115  
NB 3126+00-3136+50 Rt.  
S.D. 3125+00-3130+00 Lt.  
S.B. 3136+00-3138+50 Lt.  
S.B. 3134+50-3136+50 (Item 114)  
DRILLING & BLASTING OF  
SOLID ROCK ITEM 114  
S.D. 3135+50-3141+00 Lt.

\*JUTE MATTING  
ITEM 623  
S.D. 3138+25-3141+00 Rt.

NOTE: \* DENOTES ITEMS  
TO BE INCLUDED IN STAGE  
II CONSTRUCTION.

INDIVIDUAL WATER SOURCES  
DUG SPRING S.B.L. 3130+40 - 20' LT  
NAT. SPRING N.B.L. 3141+ - 500' CRT

CONTROL OF ACCESS IS COMPLETE ON THIS SHEET.

STANDARD STEEL BEAM GUARD RAIL  
W/ LIGHT STEEL POSTS (12'-6" H)  
3136+98 - 3138+52 Lt.

DATE	BY
10/22	Coalingby
10/23	Coalingby
11/23	Coalingby
12/23	Coalingby
1/24	Coalingby
2/24	Coalingby
3/24	Coalingby
4/24	Coalingby
5/24	Coalingby
6/24	Coalingby
7/24	Coalingby
8/24	Coalingby
9/24	Coalingby
10/24	Coalingby
11/24	Coalingby
12/24	Coalingby
1/25	Coalingby
2/25	Coalingby
3/25	Coalingby
4/25	Coalingby
5/25	Coalingby
6/25	Coalingby
7/25	Coalingby
8/25	Coalingby
9/25	Coalingby
10/25	Coalingby
11/25	Coalingby
12/25	Coalingby
1/26	Coalingby
2/26	Coalingby
3/26	Coalingby
4/26	Coalingby
5/26	Coalingby
6/26	Coalingby
7/26	Coalingby
8/26	Coalingby
9/26	Coalingby
10/26	Coalingby
11/26	Coalingby
12/26	Coalingby
1/27	Coalingby
2/27	Coalingby
3/27	Coalingby
4/27	Coalingby
5/27	Coalingby
6/27	Coalingby
7/27	Coalingby
8/27	Coalingby
9/27	Coalingby
10/27	Coalingby
11/27	Coalingby
12/27	Coalingby
1/28	Coalingby
2/28	Coalingby
3/28	Coalingby
4/28	Coalingby
5/28	Coalingby
6/28	Coalingby
7/28	Coalingby
8/28	Coalingby
9/28	Coalingby
10/28	Coalingby
11/28	Coalingby
12/28	Coalingby
1/29	Coalingby
2/29	Coalingby
3/29	Coalingby
4/29	Coalingby
5/29	Coalingby
6/29	Coalingby
7/29	Coalingby
8/29	Coalingby
9/29	Coalingby
10/29	Coalingby
11/29	Coalingby
12/29	Coalingby
1/30	Coalingby
2/30	Coalingby
3/30	Coalingby
4/30	Coalingby
5/30	Coalingby
6/30	Coalingby
7/30	Coalingby
8/30	Coalingby
9/30	Coalingby
10/30	Coalingby
11/30	Coalingby
12/30	Coalingby
1/31	Coalingby
2/31	Coalingby
3/31	Coalingby
4/31	Coalingby
5/31	Coalingby
6/31	Coalingby
7/31	Coalingby
8/31	Coalingby
9/31	Coalingby
10/31	Coalingby
11/31	Coalingby
12/31	Coalingby
1/32	Coalingby
2/32	Coalingby
3/32	Coalingby
4/32	Coalingby
5/32	Coalingby
6/32	Coalingby
7/32	Coalingby
8/32	Coalingby
9/32	Coalingby
10/32	Coalingby
11/32	Coalingby
12/32	Coalingby
1/33	Coalingby
2/33	Coalingby
3/33	Coalingby
4/33	Coalingby
5/33	Coalingby
6/33	Coalingby
7/33	Coalingby
8/33	Coalingby
9/33	Coalingby
10/33	Coalingby
11/33	Coalingby
12/33	Coalingby
1/34	Coalingby
2/34	Coalingby
3/34	Coalingby
4/34	Coalingby
5/34	Coalingby
6/34	Coalingby
7/34	Coalingby
8/34	Coalingby
9/34	Coalingby
10/34	Coalingby
11/34	Coalingby
12/34	Coalingby
1/35	Coalingby
2/35	Coalingby
3/35	Coalingby
4/35	Coalingby
5/35	Coalingby
6/35	Coalingby
7/35	Coalingby
8/35	Coalingby
9/35	Coalingby
10/35	Coalingby
11/35	Coalingby
12/35	Coalingby
1/36	Coalingby
2/36	Coalingby
3/36	Coalingby
4/36	Coalingby
5/36	Coalingby
6/36	Coalingby
7/36	Coalingby
8/36	Coalingby
9/36	Coalingby
10/36	Coalingby
11/36	Coalingby
12/36	Coalingby
1/37	Coalingby
2/37	Coalingby
3/37	Coalingby
4/37	Coalingby
5/37	Coalingby
6/37	Coalingby
7/37	Coalingby
8/37	Coalingby
9/37	Coalingby
10/37	Coalingby
11/37	Coalingby
12/37	Coalingby
1/38	Coalingby
2/38	Coalingby
3/38	Coalingby
4/38	Coalingby
5/38	Coalingby
6/38	Coalingby
7/38	Coalingby
8/38	Coalingby
9/38	Coalingby
10/38	Coalingby
11/38	Coalingby
12/38	Coalingby
1/39	Coalingby
2/39	Coalingby
3/39	Coalingby
4/39	Coalingby
5/39	Coalingby
6/39	Coalingby
7/39	Coalingby
8/39	Coalingby
9/39	Coalingby
10/39	Coalingby
11/39	Coalingby
12/39	Coalingby
1/40	Coalingby
2/40	Coalingby
3/40	Coalingby
4/40	Coalingby
5/40	Coalingby
6/40	Coalingby
7/40	Coalingby
8/40	Coalingby
9/40	Coalingby
10/40	Coalingby
11/40	Coalingby
12/40	Coalingby
1/41	Coalingby
2/41	Coalingby
3/41	Coalingby
4/41	Coalingby
5/41	Coalingby
6/41	Coalingby
7/41	Coalingby
8/41	Coalingby
9/41	Coalingby
10/41	Coalingby
11/41	Coalingby
12/41	Coalingby
1/42	Coalingby
2/42	Coalingby
3/42	Coalingby
4/42	Coalingby
5/42	Coalingby
6/42	Coalingby
7/42	Coalingby
8/42	Coalingby
9/42	Coalingby
10/42	Coalingby
11/42	Coalingby
12/42	Coalingby
1/43	Coalingby
2/43	Coalingby
3/43	Coalingby
4/43	Coalingby
5/43	Coalingby
6/43	Coalingby
7/43	Coalingby
8/43	Coalingby
9/43	Coalingby
10/43	Coalingby
11/43	Coalingby
12/43	Coalingby
1/44	Coalingby
2/44	Coalingby
3/44	Coalingby
4/44	Coalingby
5/44	Coalingby
6/44	Coalingby
7/44	Coalingby
8/44	Coalingby
9/44	Coalingby
10/44	Coalingby
11/44	Coalingby
12/44	Coalingby
1/45	Coalingby
2/45	Coalingby
3/45	Coalingby
4/45	Coalingby
5/45	Coalingby
6/45	Coalingby
7/45	Coalingby
8/45	Coalingby
9/45	Coalingby
10/45	Coalingby
11/45	Coalingby
12/45	Coalingby
1/46	Coalingby
2/46	Coalingby
3/46	Coalingby
4/46	Coalingby
5/46	Coalingby
6/46	Coalingby
7/46	Coalingby
8/46	Coalingby
9/46	Coalingby
10/46	Coalingby
11/46	Coalingby
12/46	Coalingby
1/47	Coalingby
2/47	Coalingby
3/47	Coalingby
4/47	Coalingby
5/47	Coalingby
6/47	Coalingby
7/47	Coalingby
8/47	Coalingby
9/47	Coalingby
10/47	Coalingby
11/47	Coalingby
12/47	Coalingby
1/48	Coalingby
2/48	Coalingby
3/48	Coalingby
4/48	Coalingby
5/48	Coalingby
6/48	Coalingby
7/48	Coalingby
8/48	Coalingby
9/48	Coalingby
10/48	Coalingby
11/48	Coalingby
12/48	Coalingby
1/49	Coalingby
2/49	Coalingby
3/49	Coalingby
4/49	Coalingby
5/49	Coalingby
6/49	Coalingby
7/49	Coalingby
8/49	Coalingby
9/49	Coalingby
10/49	Coalingby
11/49	Coalingby
12/49	Coalingby
1/50	Coalingby
2/50	Coalingby
3/50	Coalingby
4/50	Coalingby
5/50	Coalingby
6/50	Coalingby
7/50	Coalingby
8/50	Coalingby
9/50	Coalingby
10/50	Coalingby
11/50	Coalingby
12/50	Coalingby

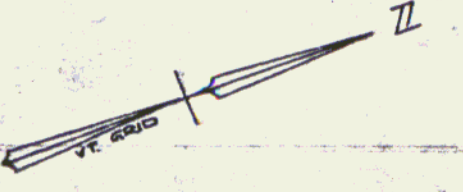
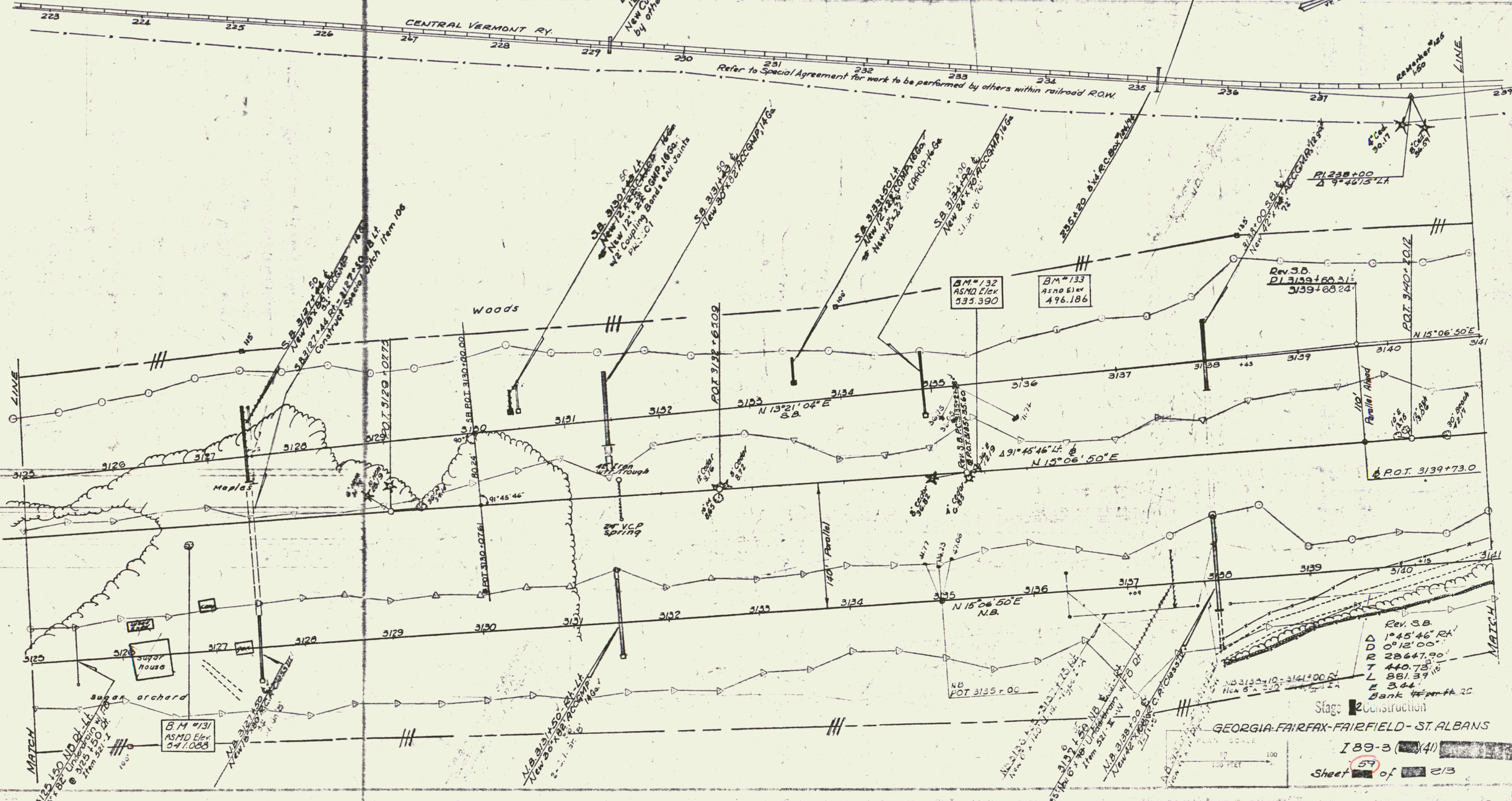

Rev. S.B.  
 $\Delta$  1° 45' 46" RA  
 $\Delta$  0° 12' 00"  
 $R$  28647.90'  
 $T$  440.73'  
 $L$  881.39'  
 $E$  3.44'  
 Bank 4 ft from 25'  
 Stage 2 Construction  
 GEORGIA-FAIRFAX-FAIRFIELD-ST. ALBANS  
 189-3 (141)  
 Sheet 59 of 213