

THREE CABLE GUARD RAIL
w/STEEL POSTS, ITEM 522
NB 3332+00 - 3343+00 LT
SB 3332+00 - 3343+00 LT

STD STEEL BEAM GUARD RAIL
w/STEEL POSTS, ITEM 522 A
SB 3334+16 - 3334+70 RT
NB 3335+05 - 3335+59 RT

STONE FILL FOR SLOPE
PROTECTION, ITEM 522
SB 3334+16 - 3334+36 RT
SB 3334+44 - 3334+69 RT
NB 3335+20 - 3335+50 RT

RIPRAP FOR BANK PROTECTION
MOD FOR CULVERT ENDS, ITEM 526
SB 3334+36 - 3334+44 RT
SB 3339+00 - 3339+10 RT

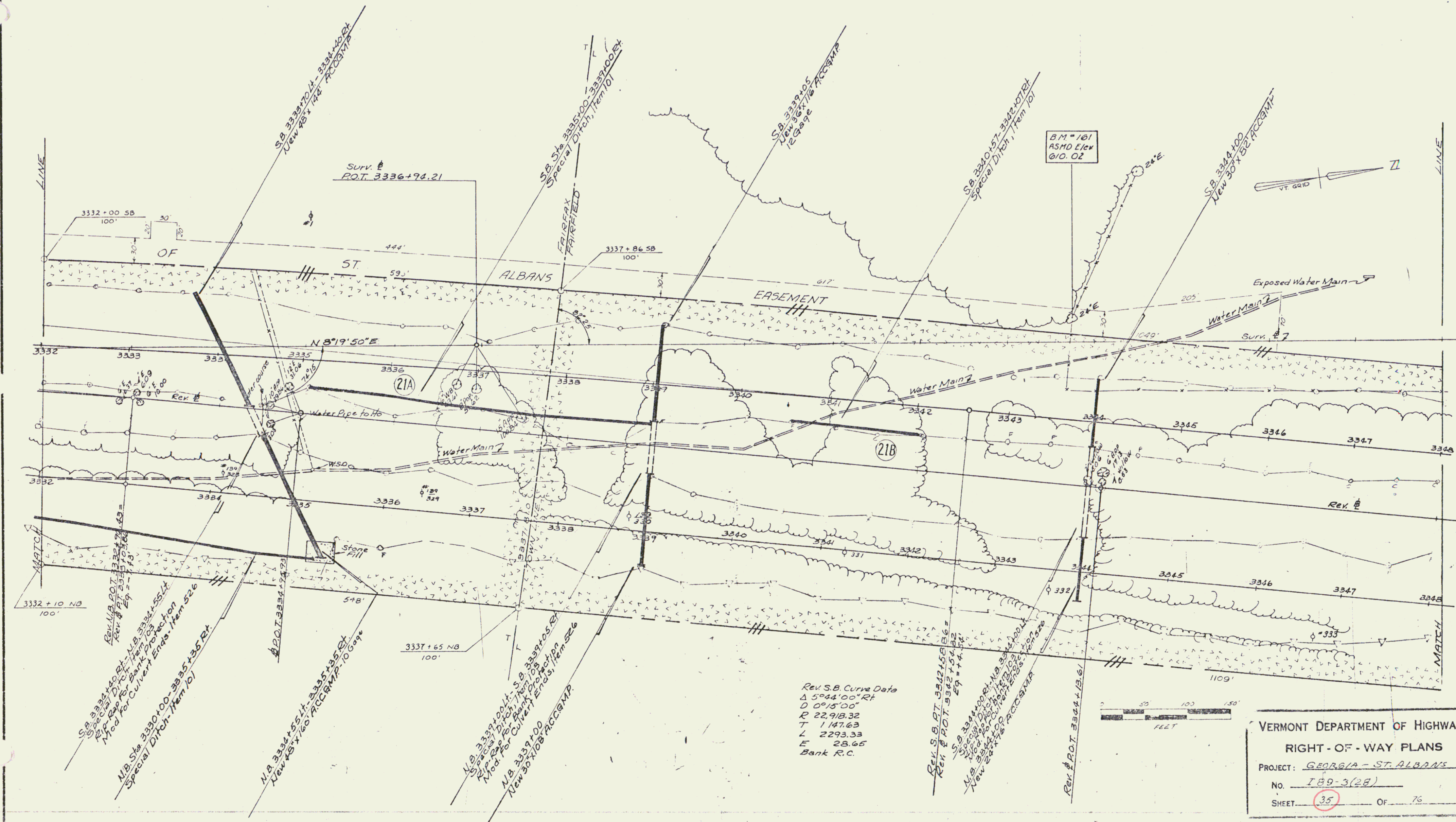

B.M. #101
ASMO Elev
@10.02

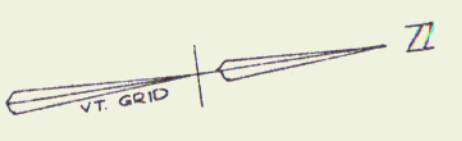

Rev S.B. Curve Data
Δ 5°44'00" Rt
D 0°15'00"
R 22,918.32
T 1,147.63
L 2293.33
E 28.65
Bank R.C.

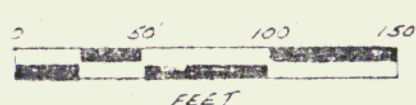

VERMONT DEPARTMENT OF HIGHWAYS
RIGHT-OF-WAY PLANS
PROJECT: GEORGIA - ST. ALBANS
NO. 189-3(28)
SHEET 35 OF 76