

PLAN
 DATE: 1/25/54
 DRAWN BY: [illegible]
 CHECKED BY: [illegible]
 NO. 2/63

THREE CABLE GUARD RAIL
 W/ STEEL POSTS ITEM 515
 NB 3289+00 - 3300+00 Lt
 SB 3287+41 - 3296+45 Lt
 SB 3297+85 - 3300+00 Lt

DRILLING & BLASTING OF SOLID
 ROCK SUBGRADE, ITEM 119
 NB 3284+00 - 3285+00
 SB 3284+00 - 3285+00

BITUMINOUS CONCRETE
 CURB ITEM 515
 SB 3287+50 - 3296+46 Lt

STD STEEL BEAM GUARD
 RAIL W/ STEEL POSTS, ITEM 517
 15' ON EACH SIDE OF RTE.
 #104 UNDER BRIDGE

BITUMINOUS CONCRETE
 GUTTER USING ITEM 119
 SB 3291+75 - 3292+96 Lt
 SB 3293+04 - 3295+00 Lt

STONE FILL FOR SLOPE
 PROTECTION, ITEM 120
 SB 3292+96 - 3293+04 Lt

Rev. N.B.
 $\Delta 4^{\circ}36'42''$ Lt
 $D 0^{\circ}14'08''$
 $R 24,323.14$
 $T 979.42$
 $L 1757.79$
 $E 19.71$
 Bank RC.

Curve Data
 $\Delta 5^{\circ}29'00''$ Lt
 $D 0^{\circ}15'00''$
 $R 22918.52$
 $T 1097.46$
 $L 2193.33$
 $E 26.13$
 Bank $1/4''$ per Ft.

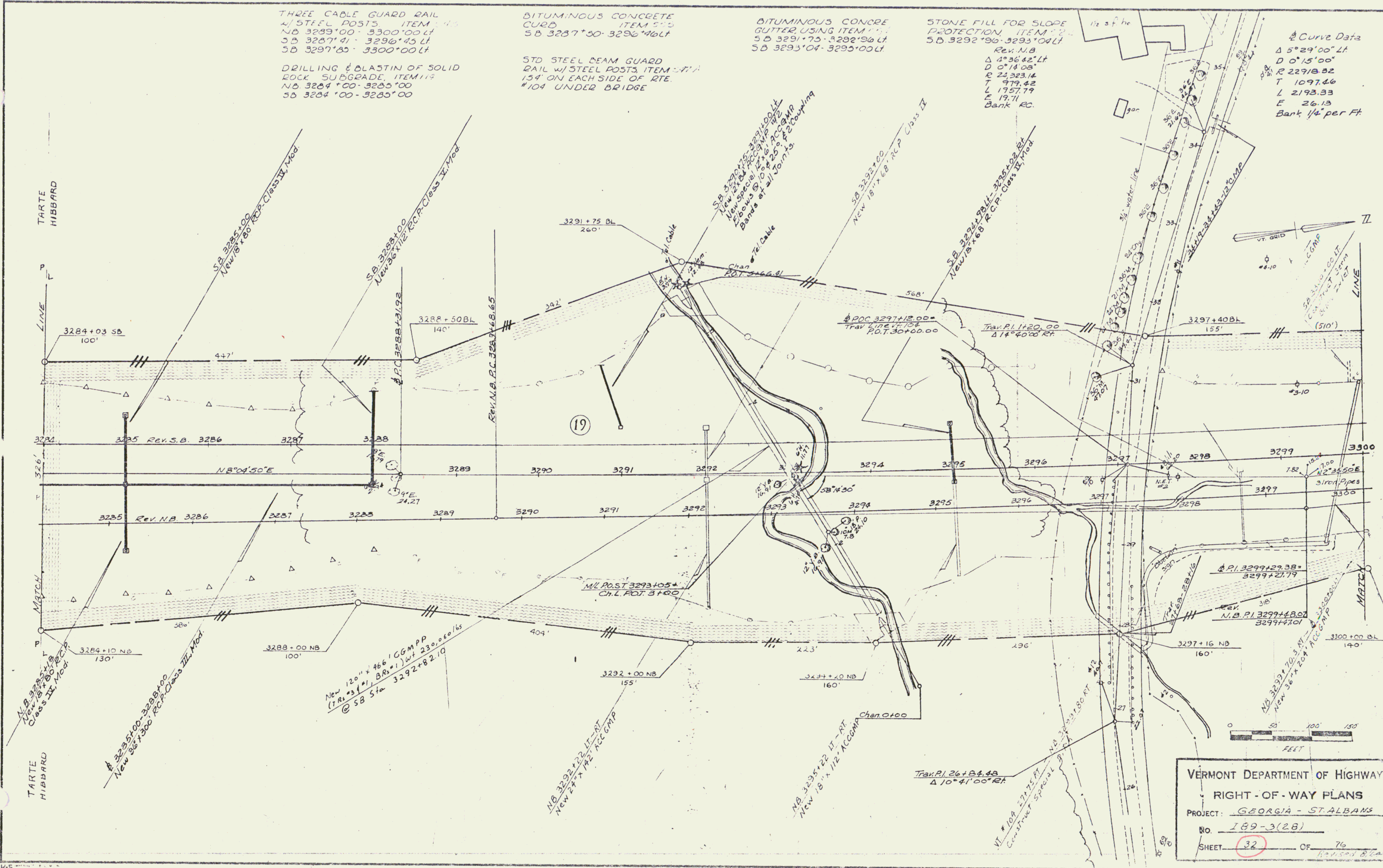

VERMONT DEPARTMENT OF HIGHWAYS
 RIGHT-OF-WAY PLANS
 PROJECT: GEORGIA - ST. ALBANS
 No. 189-3(28)
 SHEET 32 OF 76