

PAUL L & ALINE GATES  
 1-89-3 (28) PARCEL NO. 16  
 TOTAL ACREAGE 419.0A±  
 TAKING 60.9A±  
 REMAINING 358.1A±  
 LOSS OF ACCESS 118.2A±

(GATES-LESSEE)  
 TRUSTEES OF THE DIOCESE OF VERMONT  
 1-89-3 (28) PARCEL NO. 15  
 TOTAL ACREAGE 75.0A±  
 TAKING 9.0A±  
 REMAINING 66.0A±  
 LOSS OF ACCESS 60.5A±

ROY C. & HILDRED C. HICKOK  
 1-89-3 (28) PARCEL NO. 17  
 TOTAL ACREAGE 100.0A±  
 TAKING 15.3A±  
 REMAINING 84.7A±  
 LOSS OF ACCESS 19.7A±

SYLVIO & ELENNE TARTE  
 1-89-3 (28) PARCEL NO. 18A & B  
 TOTAL ACREAGE 145.0A±  
 TAKING 21.2A±  
 REMAINING 123.8A±  
 LOSS OF ACCESS 7.1A±

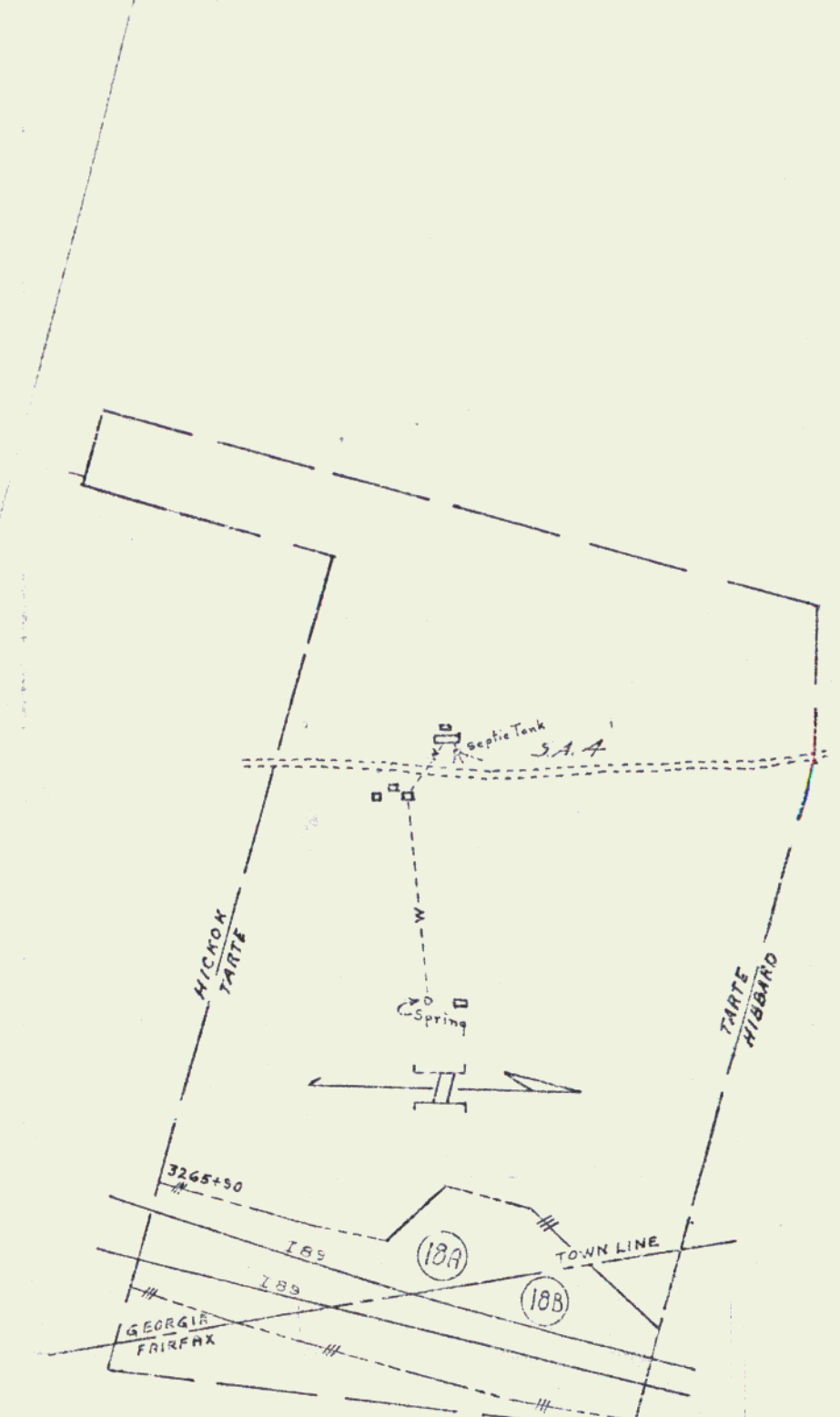
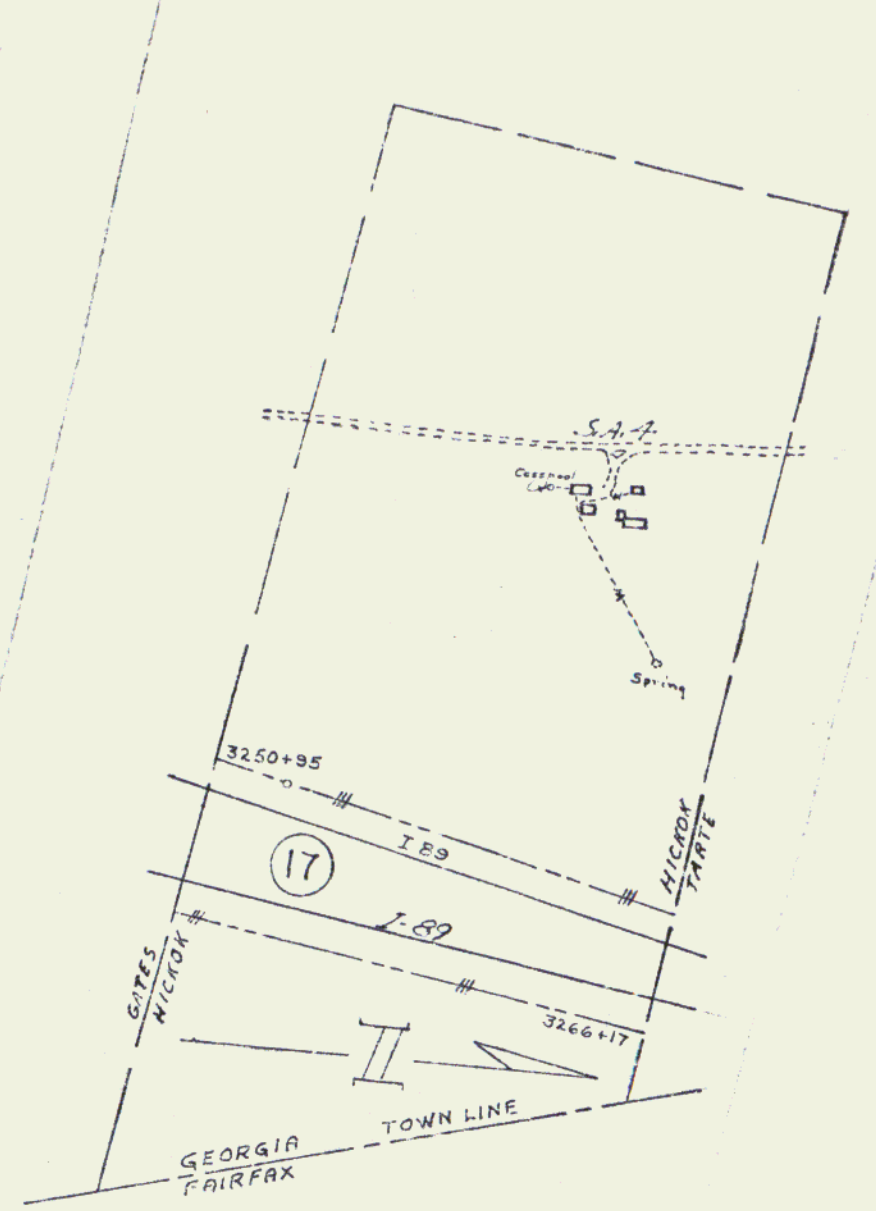
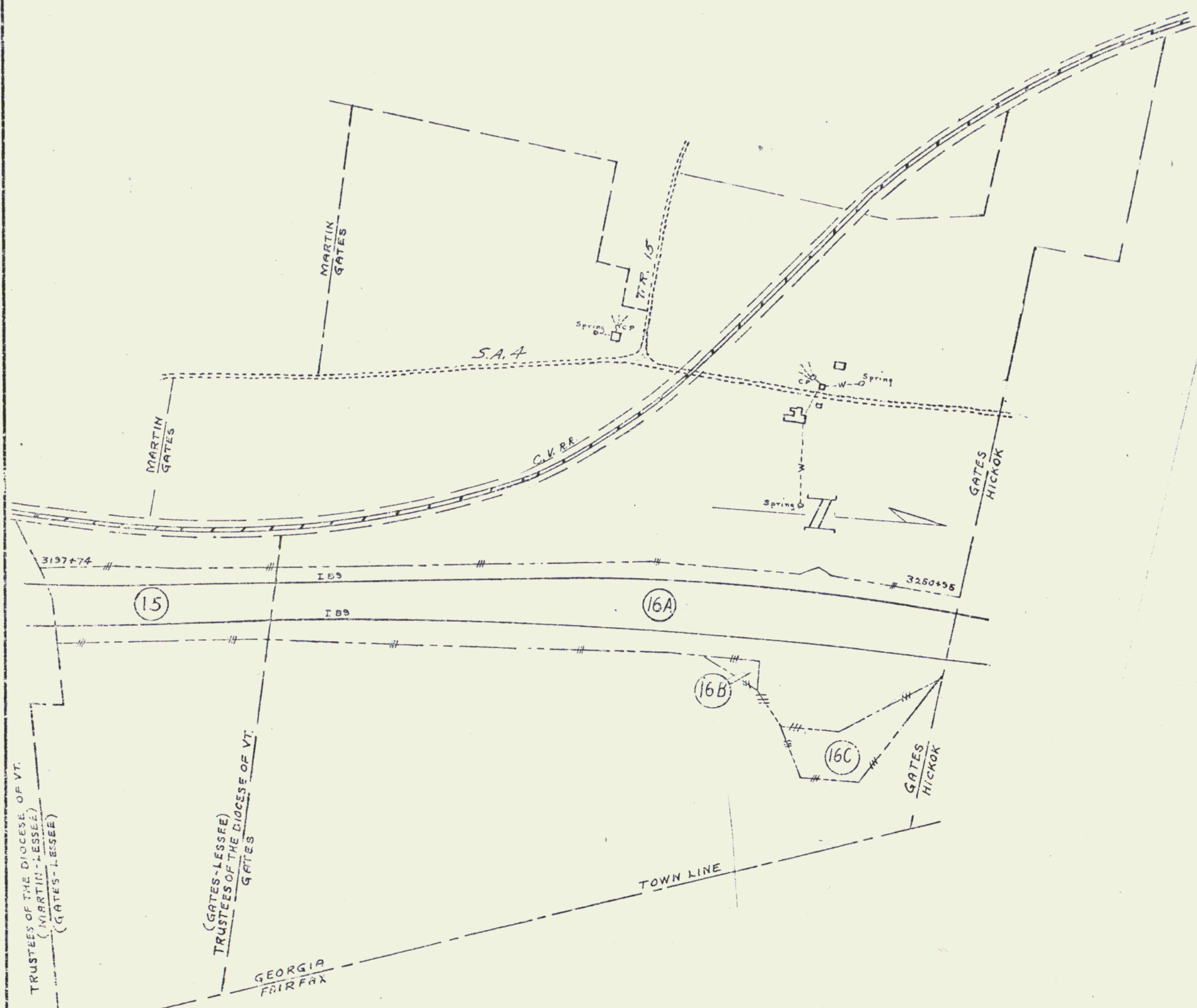

|                          |            |
|--------------------------|------------|
| SURVEYED BY _____        | DATE _____ |
| DRAWN BY _____           | DATE _____ |
| TRACED BY _____          | DATE _____ |
| PROJ. I NO. 89-3(23) ROW |            |
| SHEET 13                 | OF 76      |