

THREE CABLE GUARD RAIL
w/ STEEL POSTS, ITEM 542
92+48.01-72.31 0+47.01
Ramp B' 0+75.01-UST 100+59.11

WATER SOURCES
Type Station Offset
Dug well 90+15 110' Lt
Dug well 90+90 17' Rt

* Slope Edging, Item 556
Ramp A' 3+08.7-0+50.7 Lt
Ramp B' 0+30.7-0+72.7 Lt
Ramp B' 0+96.04-1+21.04 (Hepar)
Ramp B' 1+21.04-7+00.99 Lt

* Stage 2 Construction

TREATED TIMBER CURB
ITEM 503
US Rte 7 93+00-97+50 Rt ✓
Ramp B' 0+75.01-UST 100+59.11 ✓
93+50-100+82 Rt ✓
CONSTRUCT DRIVE
91+15 Rt 92+87-93+27 Lt

PROPERTY LINE FENCE w/ J
STEEL POSTS, MOD, ITEM 583-II
Ramp A' 2+00 Rt - US 7 90+00 Lt ✓
US 7 90+00 Rt - 97+67 Rt ✓
Note: US 7 93+17 Rt - 97+67 Rt
Prop. L. Fence to be constructed
prior to other work in area.

Bituminous Concrete Gutter-Item 554
US 7 51+90+25-91+00 Rt 2' Lt

Granite Slope Edging, Item 556-A (for traffic Island)
91+95+40-97+60 Lt ✓

DAMP A
Δ 64° 10' 38" Rt.
D 425.00'
T 260.48'
L 476.04'
E 76.64'
Bank 0.063 ft/ft
3/4" ft.

RAMP A
Δ 26° 38' 32" Lt
D 300.00'
T 78.60'
L 150.00'
E 90.3'
Bank 0.063 ft/ft
3/4" ft.

RAMP B'
Δ 144° 28' 20" Rt.
D 230.00'
T 717.92'
L 579.95'
E 323.06'
Bank 0.063 ft/ft
3/4" ft.

PLAN	DATE	BY
REVISED		
BY		
DATE		

AVERAGE DAILY TRAFFIC
0000 1965
0000 1985

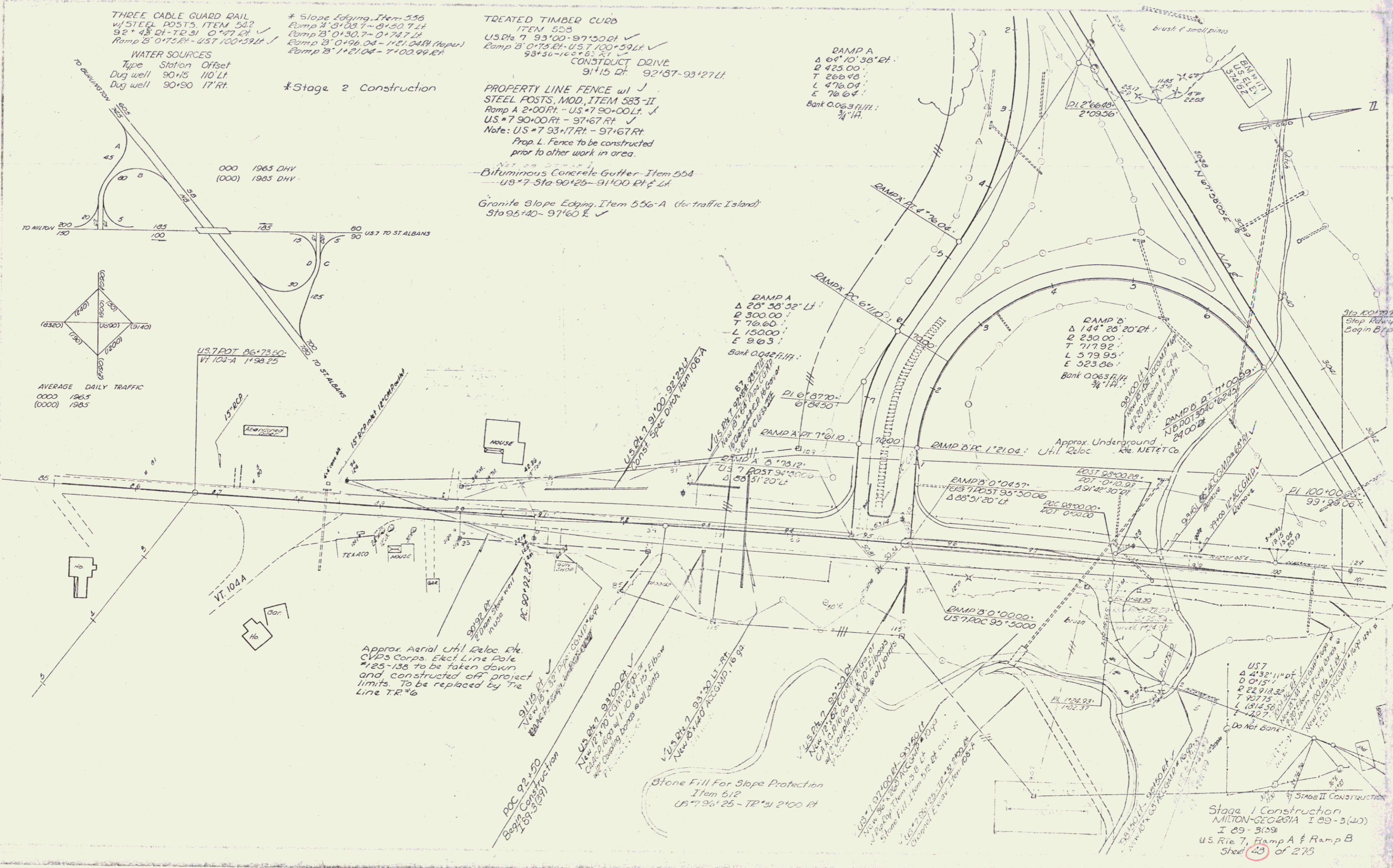

Approx. Aerial Utl Reloc. Rte.
CIVIS Corps. Elect Line Pole
#125-138 to be taken down
and constructed off project
limits. To be replaced by Tr
Line TR#6

Stone Fill For Slope Protection
Item 512
US 7 90+25-TR 21 2'00 Rt

Stage I Construction
MILTON-GEORGIA I 89-3(40)
I 89-3(09)
US Rte 7, Ramp A & Ramp B
Sheet 40 of 273