

TWO CABLE GUARD RAIL
TR#12 16+42-16+66 LT
TR#12 16+34-16+38 RT

*JUTE MATTING, ITEM 023
NB 2947+00-2948+00 (Med.)

MUCE EXCAVATION
ITEM 110
N D 2940+00-2940+25
S B 2946+25-2948+00

*THREE CABLE GUARD
RAIL W/ STEEL POSTS, ITEM 542
NB 2944+35 LT-2946+55 LT
SB 2946+48 LT-2948+00 LT

*BITUMINOUS CONCRETE
CURB
ITEM 500
SB 2946+50-2948+00 LT

WATER SOURCES

Type	Station	Offset
Dug well	NB 2945+80	490' RT
Dug well	NB 2951+60	425' RT
Dug well	NB 2954+20	510' RT

Standard Steel Beam Guard Rail, Item 545-A
TR#12 Sta 1788-18125
Sta 18125-19+035
Sta 20+21-20+25 LT
Sta 20+63-21+45 RT

JD
Δ 5'00" LT
D 0'15"
R 22910.32
T 600.14
L 1200.00
E 7.86
Bnk 0.021 ft / 1 ft
1/4" = 1'

PROPERTY LINE FENCE, MOD.
ITEM 503-II 5'±
NB 2940+00-2948+00 LT
SB 2940+00-2948+00 LT
NB 2946+10-2948+00 RT

*STAGE 2 CONSTRUCTION

END RELINQUISHMENT NO.VII
BEGIN MAINT. AGREE. AREA NO. 3
T.H.12 17+60 C (405')

PLAN

DATE	11/11/89
BY	W. J. WILSON
CHECKED BY	W. J. WILSON
SCALE	AS SHOWN
PROJECT	COLCHESTER 2-MILTON
SHEET NO.	99

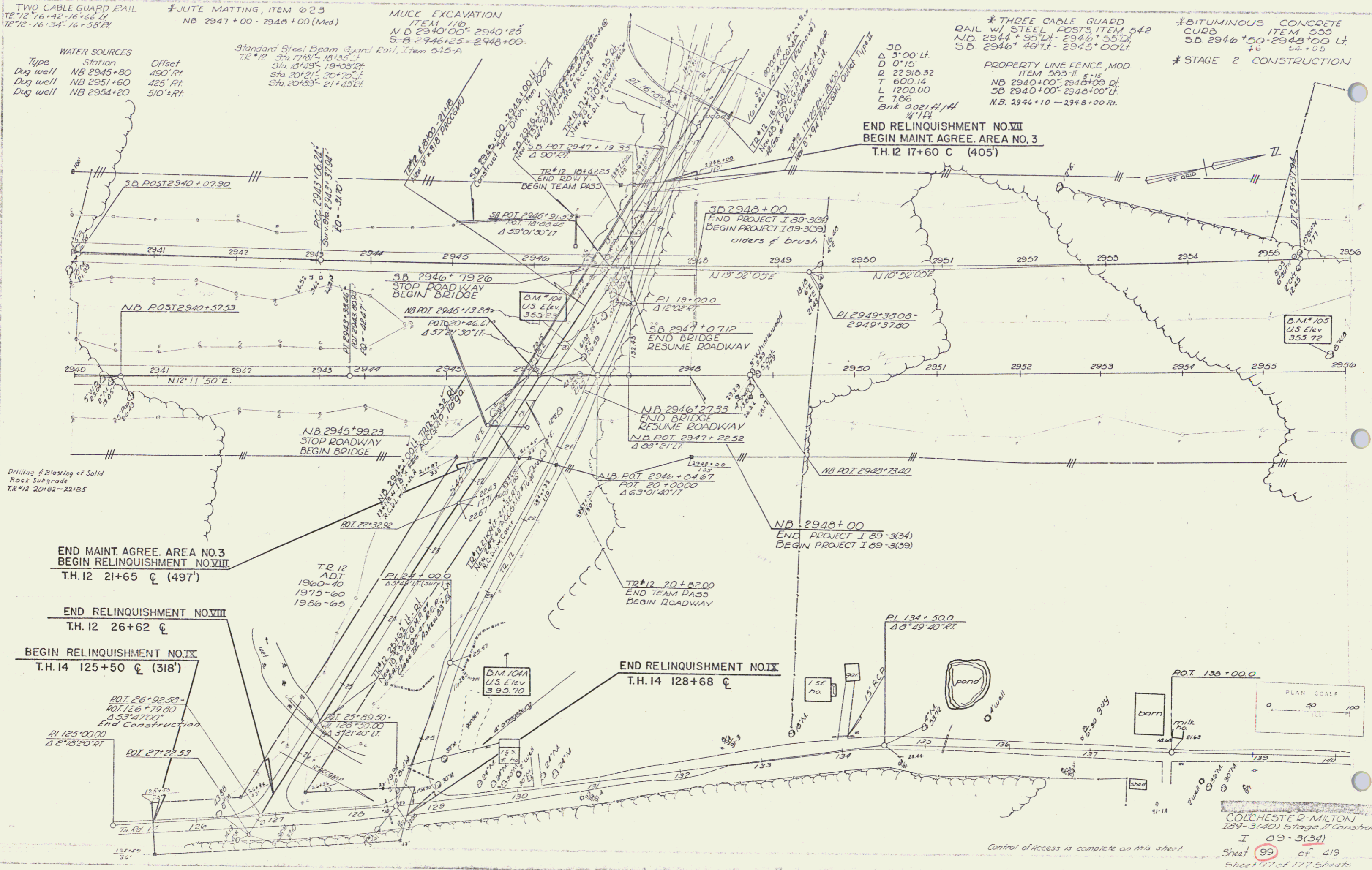

COLCHESTER 2-MILTON
189-3(40) Stage 2 Construction
I 89-3(3d)
Sheet 99 of 419
Sheet 97 of 117 Sheets