

PLAN
 SURVEYED
 BY
 DATE

* STAGE 2 CONSTRUCTION

WATER SOURCES

Type	Station	Offset
Small beaver ponds	BL 2866	Rt. & Lt.
Old spring	BL 2866+50	1050'± Rt.
Dug well	BL 2867	1000'± Rt.
Dug well	BL 2867	1100'± Rt.
Spring	BL 2870	1800'± Lt.

SUB-BASE OF SAND
 ITEM 202
 2861+00 - 2863+30 NB
 2861+00 - 2863+00 S.D.

* JUTE MATTING
 ITEM 623
 N.D. 2861+00 - 2863+50 Rt.
 Med. 2861+00 - 2863+00

* THREE CABLE GUARD RAIL
 W/ STEEL POSTS, ITEM 342
 2863+27 - 2866+16 S.D. Lt.
 2864+04 - 2866+20 S.D. NB Rt.

TWO CABLE GUARD RAIL, ITEM
 S.A.#3 3:28 - 8:39 Rt.
 5:68 - 8:48 Lt.
 11:16 - 13:58 Rt.
 11:12 - 13:58 Lt.

* BITUMINOUS CONCRETE
 CURB, ITEM 555
 S.D. 2863+20 - 2866+76 Lt.
 N.D. 2864+04 - 2866+20 Rt.

Muck Excavation
 2865+50 - 2866+00

Approx Aerial U/I
 Reloc. Joint NETET
 Co. & CVPS Corp.

END RELINQUISHMENT NO. V
 BEGIN MAINT. AGREE. AREA NO. 2
 S.A. 3 7+73 C (410')

Bituminous Concrete Surface for
 Gutters & Traffic Islands
 S.A.#3 4:07 Rt.
 13:53 Lt.

PROPERTY LINE FENCE, MOD
 ITEM 553-249, 34
 N.D. 2861+00 - 2875+30 Lt.
 S.D. 2861+00 - 2863+70 Lt.
 N.D. 2870+50 - 2876+00 Lt.
 S.D. 2869+50 - 2876+00 Lt.
 Note: 2869+50 - 2869+50 Lt. &
 2870+05 - 2869+00 Lt., to be
 constructed prior to other
 work in area.

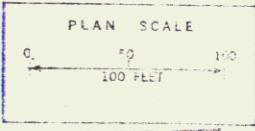
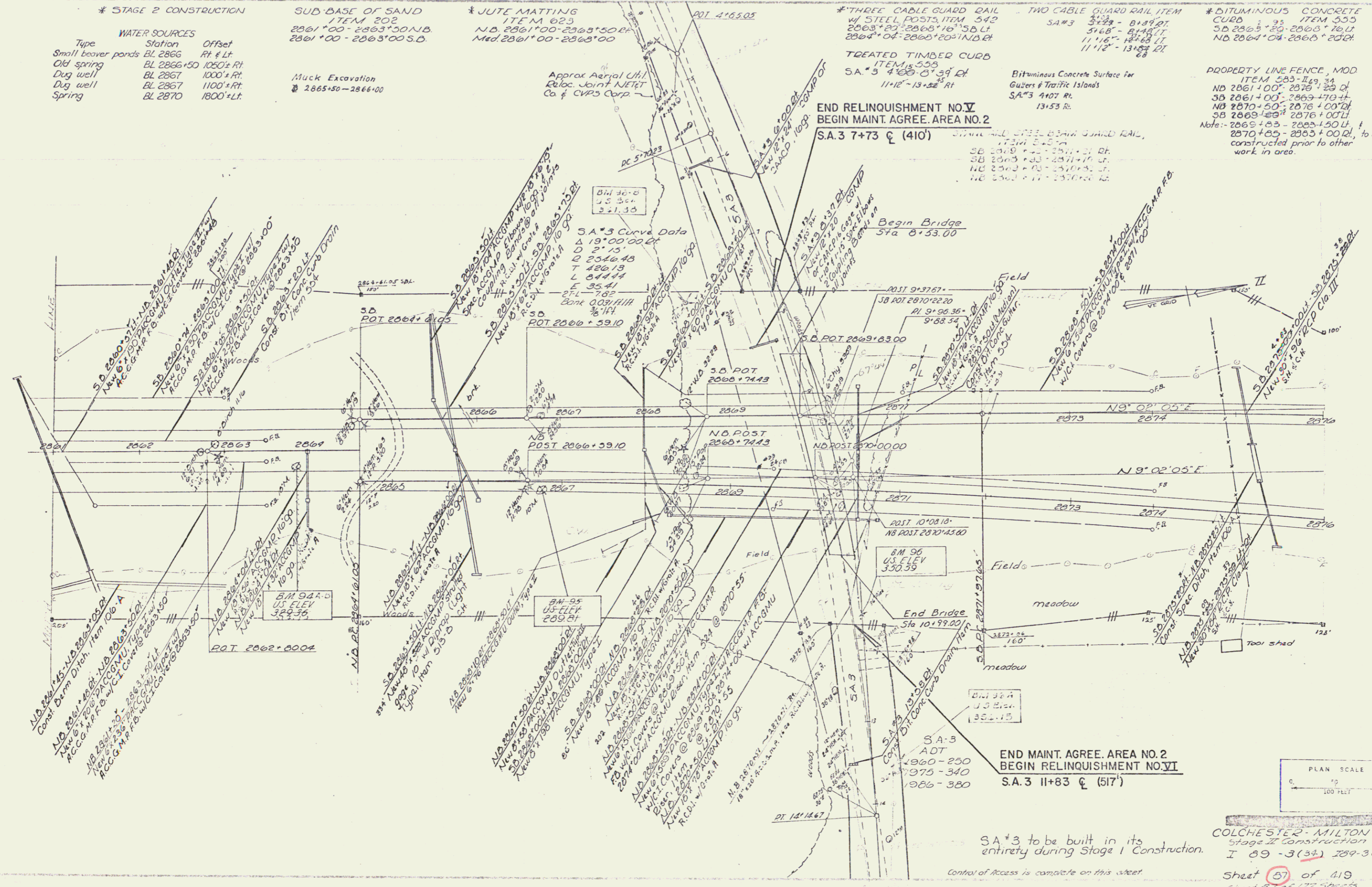

SA#3 to be built in its
 entirety during Stage 1 construction.
 Control of Access is complete on this street.

COLCHESTER - MILTON
 Stage II Construction
 I 89 - 3(34) 289-3(40)
 Sheet 57 of 119
 Sheet 87 of 177 Sheets