

July, 1937
 SB 2153100-2154000
 NB 2153100-2154750

PLAN	30' = 1" (1:30)
SECTION	1" = 10'
PROFILES	1" = 10'
NOTES	SEE GENERAL NOTES
DATE	1937
BY	CHAS. W. CHASE
CHECKED	CHAS. W. CHASE
SCALE	AS SHOWN

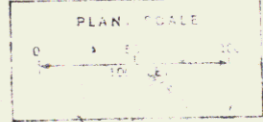
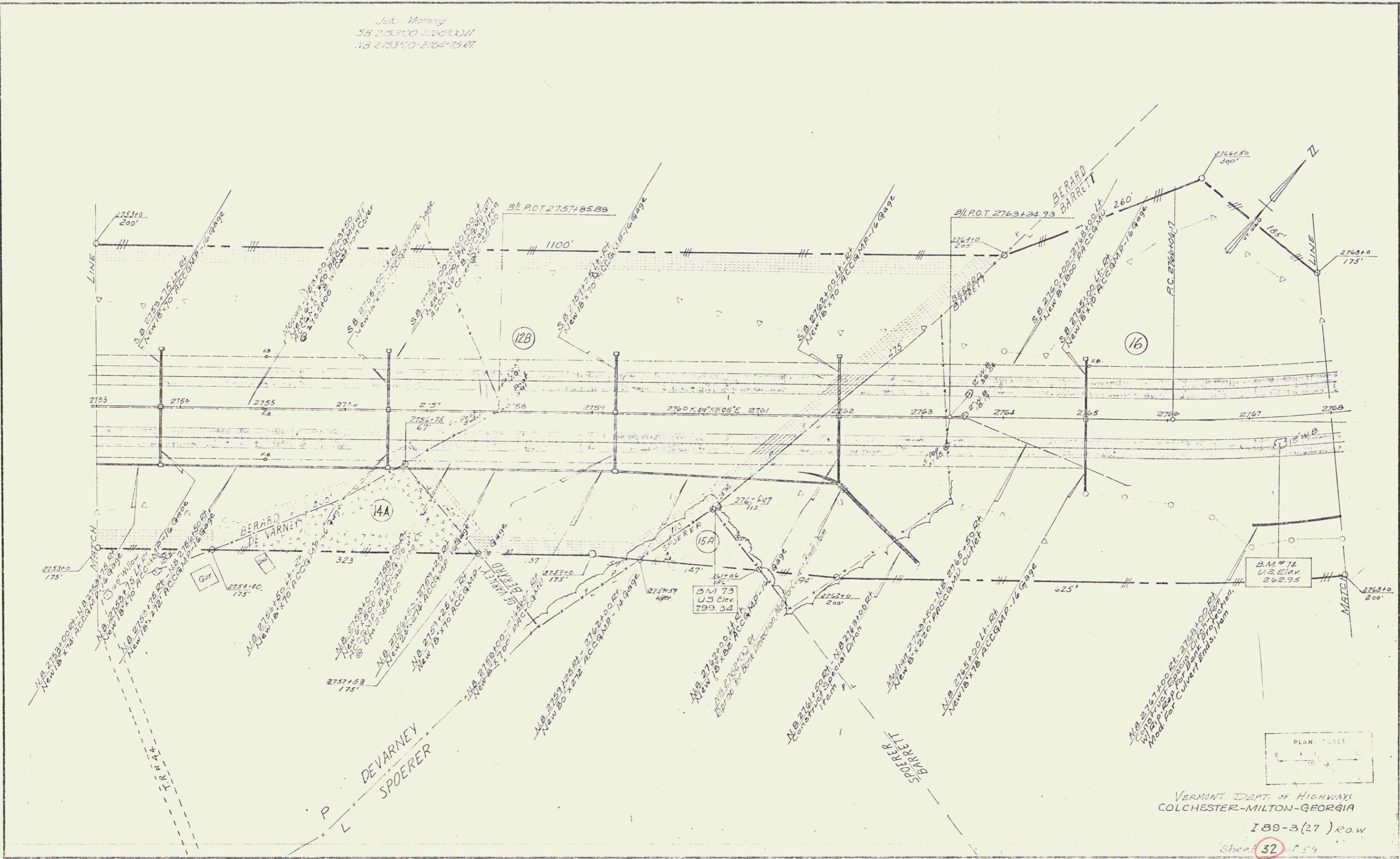

VERMONT DEPT. OF HIGHWAYS
 COLCHESTER-MILTON-GEORGIA

189-3(27) R.O.W.

Sheet 32 of 54