

DATE	
BY	
PLAN	DESIGNED
	CHECKED
	IN CHARGE
	BY
	DATE

PAVED DITCH ITEM 554 *

2222+75 TO 2223+27 MED.
2227+73 TO 2227+98 MED.
2231+73 TO 2231+98 MED.
2235+25 TO 2235+75 MED.

THREE C/BLF GUARD RAIL *
WITH STEEL POSTS ITEM 543

STA 2221+00 TO 2222+25 NB RT.

PROPERTY LINE FENCE
ITEM 503

STA 2229+07 TO 2237+00 RT
R.O.W. FENCE TO BE ERECTED
PRIOR TO CONSTRUCTION

STA 2221+00 TO 2229+07 RT
2221+00 2237+00 LT

FED. ROAD DIV. No.	STATE	FEDERAL PROJECT No.	SHEET	TOTAL SHEETS
1	VERMONT	1-89-3(15)	13	150

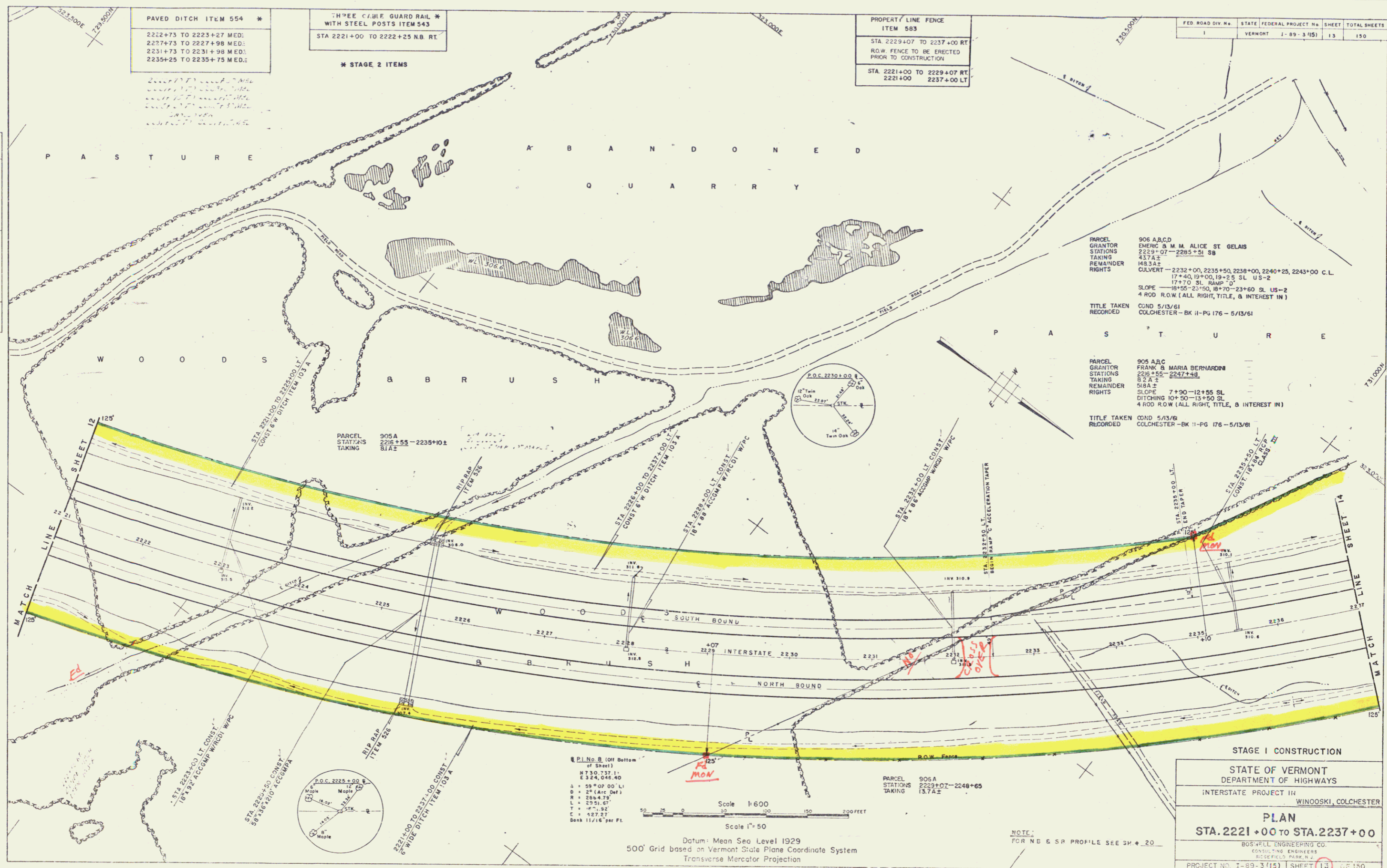

PARCEL 906 A,B,C,D
GRANTOR EMERG & M.M. ALICE ST GELAIS
STATIONS 2229+07 - 2285+51 SB
TAKING 437 A.E.
REMAINDER 1483 A.E.
RIGHTS CULVERT - 2232+00, 2235+50, 2238+00, 2240+25, 2243+00 C.L.
17+40, 19+00, 19+25 SL US-2
SLOPE 17+70 SL RAMP 'D'
18+50-23+50, 18+70-23+60 SL US-2
4 ROD R.O.W. (ALL RIGHT, TITLE, & INTEREST IN)

TITLE TAKEN COND 5/13/61
RECORDED COLCHESTER - BK II-PG 176 - 5/13/61

PARCEL 905 A,B,C
GRANTOR FRANK & MARIA BERNARDINI
STATIONS 226+55 - 2247+48
TAKING 512 A.E.
REMAINDER 518 A.E.
RIGHTS SLOPE 7+90 - 12+55 SL
DITCHING 10+50 - 13+50 SL
4 ROD R.O.W. (ALL RIGHT, TITLE, & INTEREST IN)

TITLE TAKEN COND 5/13/61
RECORDED COLCHESTER - BK II-PG 176 - 5/13/61

PARCEL 906 A
STATIONS 2229+07 - 2248+65
TAKING 137 A.Z.

Q.P.C. No. 8 (Off Bottom
of Sheet)

N 73.0 - 73.1
E 324, 045.40

A = 59' 00" 00' Lt
B = 25' (acc. out)
R = 286.479'
L = 25.51, 67'
T = 16' 1.92'
C = 127.27'
Bank 11/16' per Ft.

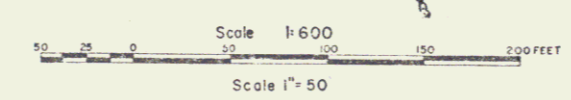

Datum: Mean Sea Level 1929
500' Grid based on Vermont State Plane Coordinate System
Transverse Mercator Projection

NOTE:
FOR NB & SB PROFILE SEE SH. # 20

STAGE I CONSTRUCTION

STATE OF VERMONT
DEPARTMENT OF HIGHWAYS

INTERSTATE PROJECT III
WINOOSKI, COLCHESTER

PLAN
STA. 2221+00 TO STA. 2237+00

BOSWELL ENGINEERING CO.
CONSULTING ENGINEERS
ROCHESTER, VERMONT

PROJECT NO. 1-89-3(15) | SHEET 13 OF 150
STAGE 2 CONSTRUCTION 1-89-3(22)
SHEET 11 OF 65