

DATE	BY
PLAN	SUBMITTED
	APPROVED
	BY
	DATE
	BY
	DATE

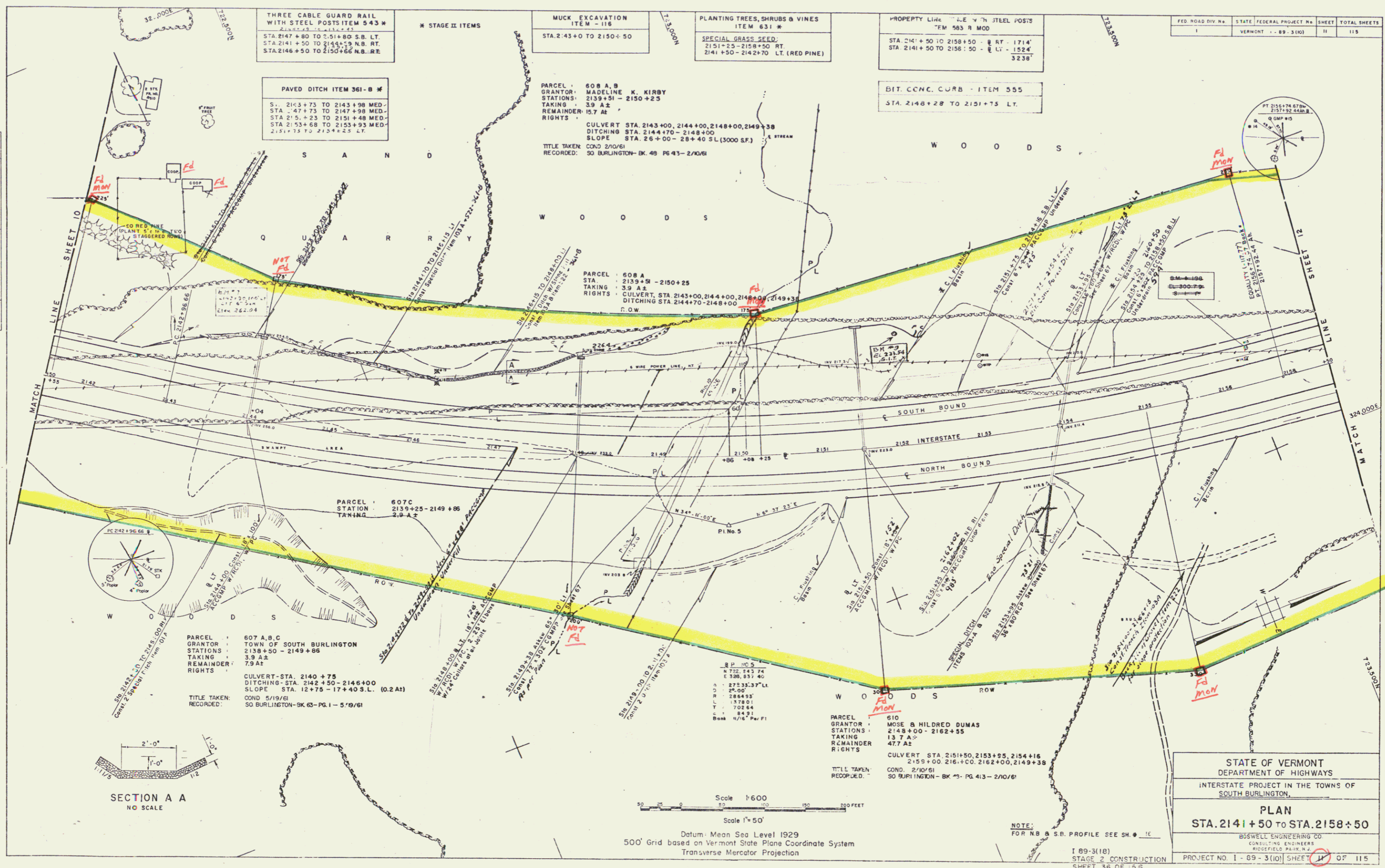

THREE CABLE GUARD RAIL WITH STEEL POSTS ITEM 543 *
STA. 2147+80 TO 2151+80 S.B. LT.
STA. 2141+50 TO 2146+50 N.B. RT.
STA. 2146+50 TO 2150+50 N.B. RE

M STAGE II ITEMS

MUCK EXCAVATION ITEM - 116
STA. 2143+00 TO 2150+50

PLANTING TREES, SHRUBS & VINES ITEM 631 *
SPECIAL GRASS SEED:
2151+25 - 2158+50 RT
2141+50 - 2142+70 LT. (RED PINE)

PROPERTY LINE 1/2" E W 1/4" STEEL POSTS ITEM 563 R MOD
STA. 2141+50 TO 2158+50 E RT - 1714'
STA. 2141+50 TO 2158+50 E LT - 1524'
3238'

FED. ROAD DIV. NO.	STATE	FEDERAL PROJECT NO.	SHEET	TOTAL SHEETS
1	VERMONT	- 89-31(1)	11	115

PAVED DITCH ITEM 361-B *
S. 2143+75 TO 2143+98 MED.
STA. 147+75 TO 2147+98 MED.
STA. 215+25 TO 2151+48 MED.
STA. 2153+68 TO 2153+93 MED.
2151+75 TO 2154+25 LT.

PARCEL 608 A, B
GRANTOR: MADELINE K. KIRBY
STATIONS: 2139+51 - 2150+23
TAKING: 3.9 A, Z
REMAINDER: 15.7 A
RIGHTS:
CULVERT STA. 2143+00, 2144+00, 2148+00, 2149+38
DITCHING STA. 2144+70 - 2148+00
SLOPE STA. 26+00 - 28+40 S.L. (3000 SF.)
TITLE TAKEN: COND. 210/61
RECORDED: 30 BURLINGTON - BK. 48 PG. 43 - 2/10/61

BIT. CONC. CURB - ITEM 355
STA. 2146+28 TO 2151+75 LT.

PARCEL 608 A
STA. 2139+51 - 2150+25
TAKING: 3.9 A, Z
RIGHTS:
CULVERT STA. 2143+00, 2144+00, 2148+00, 2149+38
DITCHING STA. 2144+70 - 2148+00
D.W.

PARCEL 607 C
STATION 2139+25 - 2149+86
TAKING 2.9 A, Z

PARCEL 607 A, B, C
GRANTOR: TOWN OF SOUTH BURLINGTON
STATIONS: 2138+50 - 2149+86
TAKING: 3.9 A, Z
REMAINDER: 7.8 A
RIGHTS:
CULVERT - STA. 2140+75
DITCHING - STA. 2142+50 - 2146+00
SLOPE - STA. 12+75 - 17+40 S.L. (0.2 A)
TITLE TAKEN: COND. 2119/61
RECORDED: 30 BURLINGTON - BK. 63 - PG. 1 - 5/9/61

PARCEL 610
GRANTOR: MOSE B. HILDRED DUMAS
STATIONS: 2148+00 - 2162+55
TAKING: 13.7 A, W
REMAINDER: 47.7 A
RIGHTS:
CULVERT STA. 2151+50, 2153+55, 2154+16
2159+00, 216+00, 2162+00, 2149+38
COND. 210/61
RECORDED: 30 BURLINGTON - BK. 43 - PG. 43 - 2/10/61

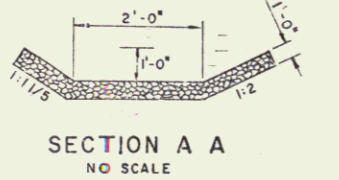

Scale 1" = 600
Scale 1" = 50'
Datum: Mean Sea Level 1929
500' Grid based on Vermont State Plane Coordinate System
Transverse Mercator Projection

STATE OF VERMONT
DEPARTMENT OF HIGHWAYS
INTERSTATE PROJECT IN THE TOWNS OF
SOUTH BURLINGTON

PLAN
STA. 2141+50 TO STA. 2158+50

BOSWELL ENGINEERING CO.
CONSULTING ENGINEERS
RISFIELD PLACE, N.Y.

PROJECT NO. 1 - 89 - 31(1) SHEET 11 OF 115
STAGE 1 CONTRACT 2

Const + R.O.W. 7