

PLAN	EXTRACTED	DATE
BY		
DATE		
BY		
DATE		

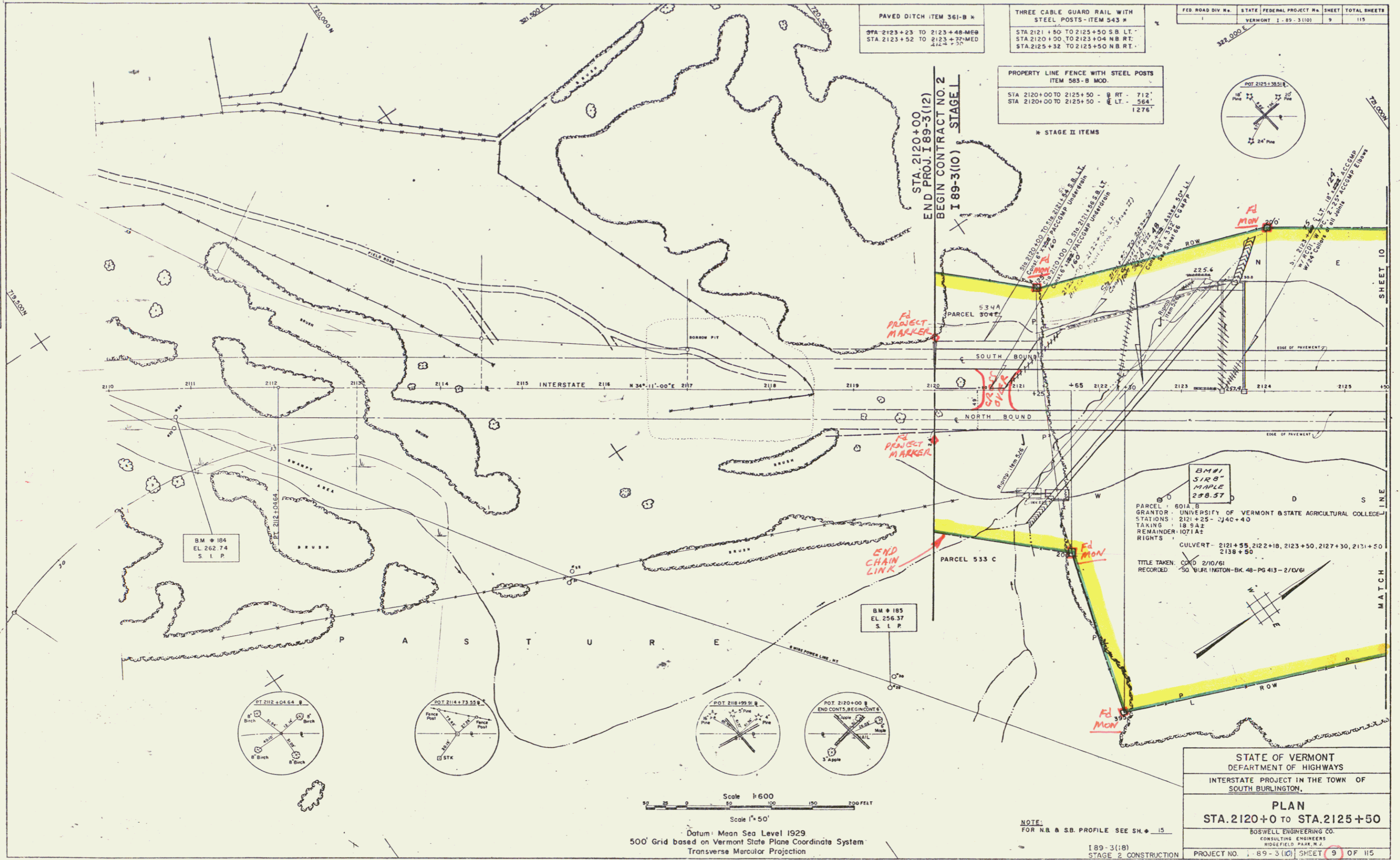

PAVED DITCH - ITEM 361-B *

STA 2123+23 TO 2123+48-MEB
STA 2123+52 TO 2123+77-MED
1:2" = 1' 50"

THREE CABLE GUARD RAIL WITH STEEL POSTS - ITEM 543 *

STA 2121+80 TO 2125+50 S.B. LT.
STA 2120+00 TO 2123+04 N.B. RT.
STA 2125+32 TO 2125+50 N.B. RT.

FED. ROAD DIV. NO.	STATE PROJECT NO.	SHEET	TOTAL SHEETS
1	VERMONT 1-89-3101	9	115

PROPERTY LINE FENCE WITH STEEL POSTS - ITEM 583-B MOD.

STA 2120+00 TO 2125+50 - 8 FT. - 712'
STA 2120+00 TO 2125+50 - 6 FT. - 364'
1:276'

* STAGE II ITEMS

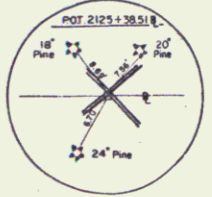

STA. 2120+00
END PROJ. 189-3(1/2)
BEGIN CONTRACT NO. 2
189-3(10) STAGE I

BM#1
518-B
MAPLE
288.57

PARCEL 601A-B
GRANTOR: UNIVERSITY OF VERMONT & STATE AGRICULTURAL COLLEGE
STATIONS: 2121+25 - 2140+40
TAKING: 18-942
REMAINDER: 1071A2
RIGHTS: CULVERT - 2121+55, 2122+10, 2123+50, 2127+30, 2131+50, 2138+50
TITLE TAKEN: CO'D 2/10/61
RECORDED: 50 BUR. INGTON-BK. 48-PG 413-2/D/61

BM # 184
EL. 262.74
S.I.P.

BM # 185
EL. 256.37
S.I.P.

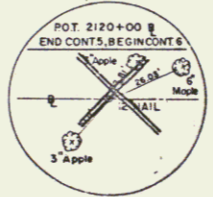
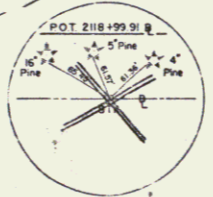
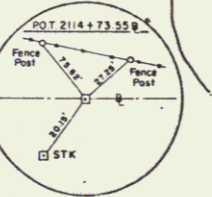
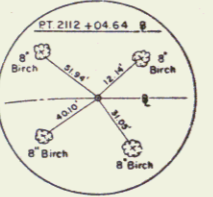

Scale 1" = 600'

Scale 1" = 50'

Datum: Mean Sea Level 1929
500' Grid based on Vermont State Plane Coordinate System
Transverse Mercator Projection

NOTE:
FOR N.B. & S.B. PROFILE SEE SH. # 15

189-3(18)
STAGE 2 CONSTRUCTION
SHEET 9 OF 156

STATE OF VERMONT DEPARTMENT OF HIGHWAYS	
INTERSTATE PROJECT IN THE TOWN OF SOUTH BURLINGTON.	
PLAN	
STA. 2120+00 TO STA. 2125+50	
BOSWELL ENGINEERING CO. CONSULTING ENGINEERS WINDFIELD PARK, N.J.	
PROJECT NO. 189-3(10)	SHEET 9 OF 115
STAGE 1	CONTRACT 2