

PLAN	EXHIBITED	DATE
DATE	BY	
REVISIONS		
1. AS NOTED		
2. BY: [Signature]		
3. BY: [Signature]		
4. BY: [Signature]		
5. BY: [Signature]		
6. BY: [Signature]		
7. BY: [Signature]		
8. BY: [Signature]		
9. BY: [Signature]		
10. BY: [Signature]		
11. BY: [Signature]		
12. BY: [Signature]		
13. BY: [Signature]		
14. BY: [Signature]		
15. BY: [Signature]		
16. BY: [Signature]		
17. BY: [Signature]		
18. BY: [Signature]		
19. BY: [Signature]		
20. BY: [Signature]		
21. BY: [Signature]		
22. BY: [Signature]		
23. BY: [Signature]		
24. BY: [Signature]		
25. BY: [Signature]		
26. BY: [Signature]		
27. BY: [Signature]		
28. BY: [Signature]		
29. BY: [Signature]		
30. BY: [Signature]		
31. BY: [Signature]		
32. BY: [Signature]		
33. BY: [Signature]		
34. BY: [Signature]		
35. BY: [Signature]		
36. BY: [Signature]		
37. BY: [Signature]		
38. BY: [Signature]		
39. BY: [Signature]		
40. BY: [Signature]		
41. BY: [Signature]		
42. BY: [Signature]		
43. BY: [Signature]		
44. BY: [Signature]		
45. BY: [Signature]		
46. BY: [Signature]		
47. BY: [Signature]		
48. BY: [Signature]		
49. BY: [Signature]		
50. BY: [Signature]		

CURVE DATA					
NO.	Δ	R	L	T	BANK
RAMP C					
C-3	23°-14'-36"	818.51'	532.03'	168.34'	L
RAMP H					
H-3	35°-26'-04"	300.00'	483.74'	262.70'	L

GRANITE SLOPE EDGING ITEM 556-A *
 STA 34+18 TO 37+50 LT RAMP "C"
 Ramp "C" Bull nose STA. 212+94.5 LT -
 STA. 30+90 TO 34+00 RT RAMP "H"

STANDARD STEEL BEAM GUARD RAIL WITH STEEL POSTS-ITEM 547-A *
 Ramp "C" STA. 33+03 TO 34+32 RT
 STA. 212+95 TO 213+55 LT & RT

THREE CABLE GUARD RAIL WITH STEEL POSTS-ITEM 543 *
 STA. 2110+00 TO 2111+84 SB LT
 STA. 2110+00 TO 2110+50 NB RT
 STA. 2119+52 TO 2120+00 NB RT

Ramp "C" 33+00 - 35+50 RT
 Ramp "H" STA. 31+00 TO 31+50 LT
 Ramp "H" STA. 30+90 TO 30+28 RT

CHAIN LINK FENCE (ALUMINUM) ITEM 590-A 6' HIGH
 RAMP "C" STA. 29+54 TO 212+00 R N° 117° 4'
 RA "C" STA. 32+60 TO 212+00 L LT. 11.60° 2334'

MUCK EXCAVATION ITEM 116
 STA. 2110+00 TO 2111+30.69

PAVED DITCH - ITEM 361-B *
 STA. 2113+50 TO 2120+00 LT
 STA. 2113+73 TO 2113+98 Med.
 STA. 2119+23 TO 2119+48 Med.
 RAMP "C" 33+00 - 35+50 LT
 RAMP "H" 30+90 - 31+30 LT
 * STAGE II ITEMS

FED. ROAD DIV. NO.	STATE	FEDERAL PROJECT NO.	SHEET	TOTAL SHEETS
1	VERMONT	1-89-3(12)	17	175

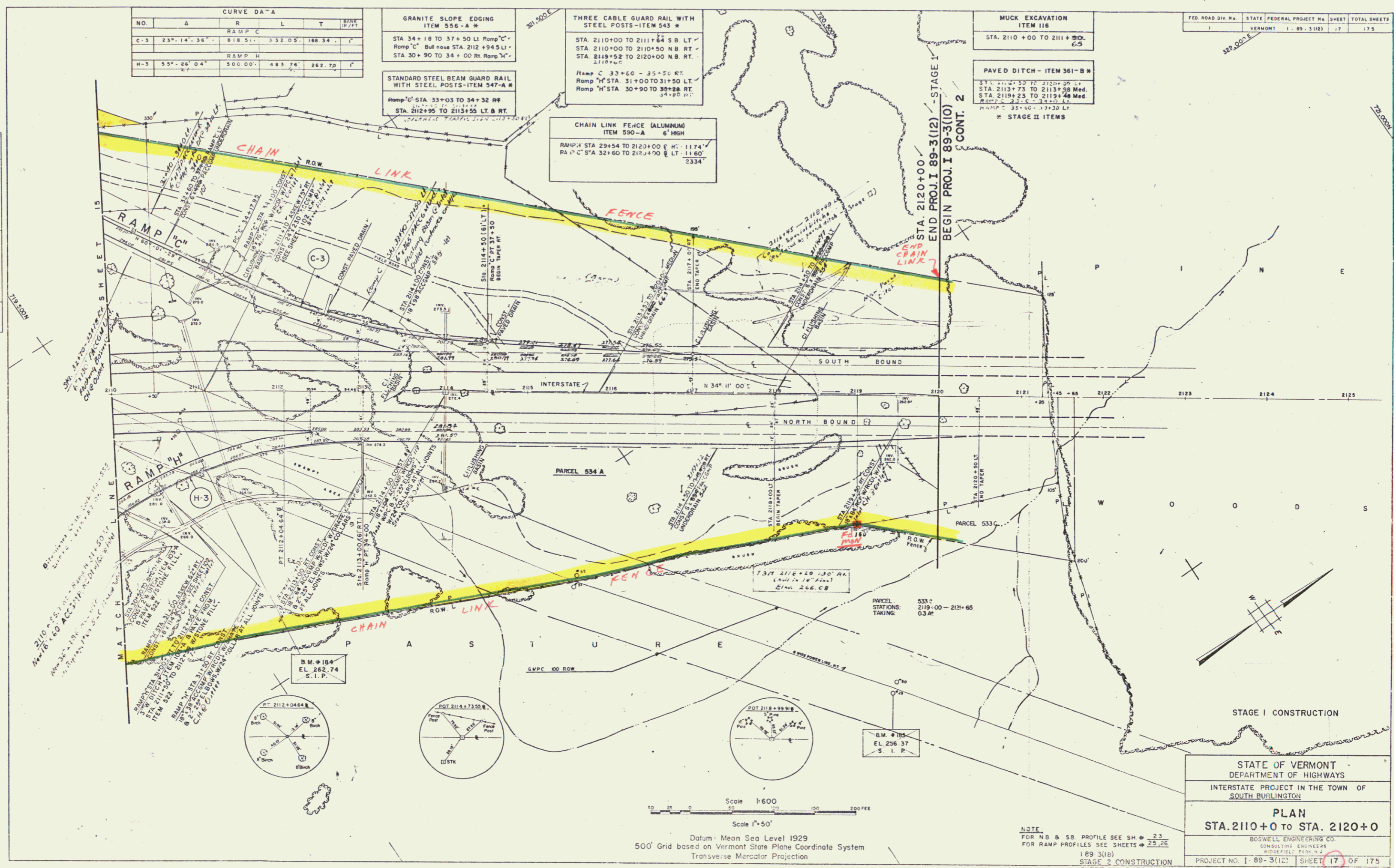

STAGE I CONSTRUCTION

STATE OF VERMONT
 DEPARTMENT OF HIGHWAYS
 INTERSTATE PROJECT IN THE TOWN OF
 SOUTH BURLINGTON

PLAN
STA. 2110+0 TO STA. 2120+0

BOSWELL ENGINEERING CO.
 CONSULTING ENGINEERS
 189-3(12)
 STAGE 2 CONSTRUCTION
 SHEET 33 OF 156

PROJECT NO. 1-89-3(12) SHEET 17 OF 175

Scale 1"=50'
 Scale 1"=600'

Datum: Mean Sea Level 1929
 500' Grid based on Vermont State Plane Coordinate System
 Transverse Mercator Projection

NOTE
 FOR NB & SB PROFILE SEE SH # 23
 FOR RAMP PROFILES SEE SHEETS # 25, 26
 189-3(12)
 STAGE 2 CONSTRUCTION
 SHEET 33 OF 156

35