

DRILLING & BLASTING OF SOLID ROCK SUBGRADE - MOD - ITEM 11-6
STA. 2080+00 TO 2081+50 - E

GRANITE SLOPE EDGING
ITEM 556-A M
STA 14 + 75 TO 15 + 05 Lt Ramp "A"
STA 11 + 50 TO 14 + 02 Rt Ramp "F"
Ramp "F" Bull nose Sta 2092 + 07 Rt.

PAVED DITCH - ITEM 361-B M
STA 2083+02 TO 2083+27 Med
STA. 2088+02 TO 2088+27 Med

CHAIN LINK FENCE (ALUMINUM)
ITEM 550-A 6' HIGH
STA. 2080+00 TO 2081+00 8 RT - 1280'
STA. 2080+00 TO 2081+00 8 LT - 1280'

STANDARD STEEL BEAM
GUARD RAIL - ITEM 547A
STA. 2080+95 TO 2081+55 LT & RT W.A.
(CHECK SIGN LOCATION)

FED. ROAD DIST. No. STATE FEDERAL PROJECT No. SHEET TOTAL SHEETS
1 VERMONT 1-89-3(12) 13 175

EXACT LOCATION IS TO BE CHECKED WITH SO. BURLINGTON WATER DEPT.

PLAN	DATE
DESIGNED	
PLOTTED	
CHECKED	
IN CHARGE	
BY	
DATE	

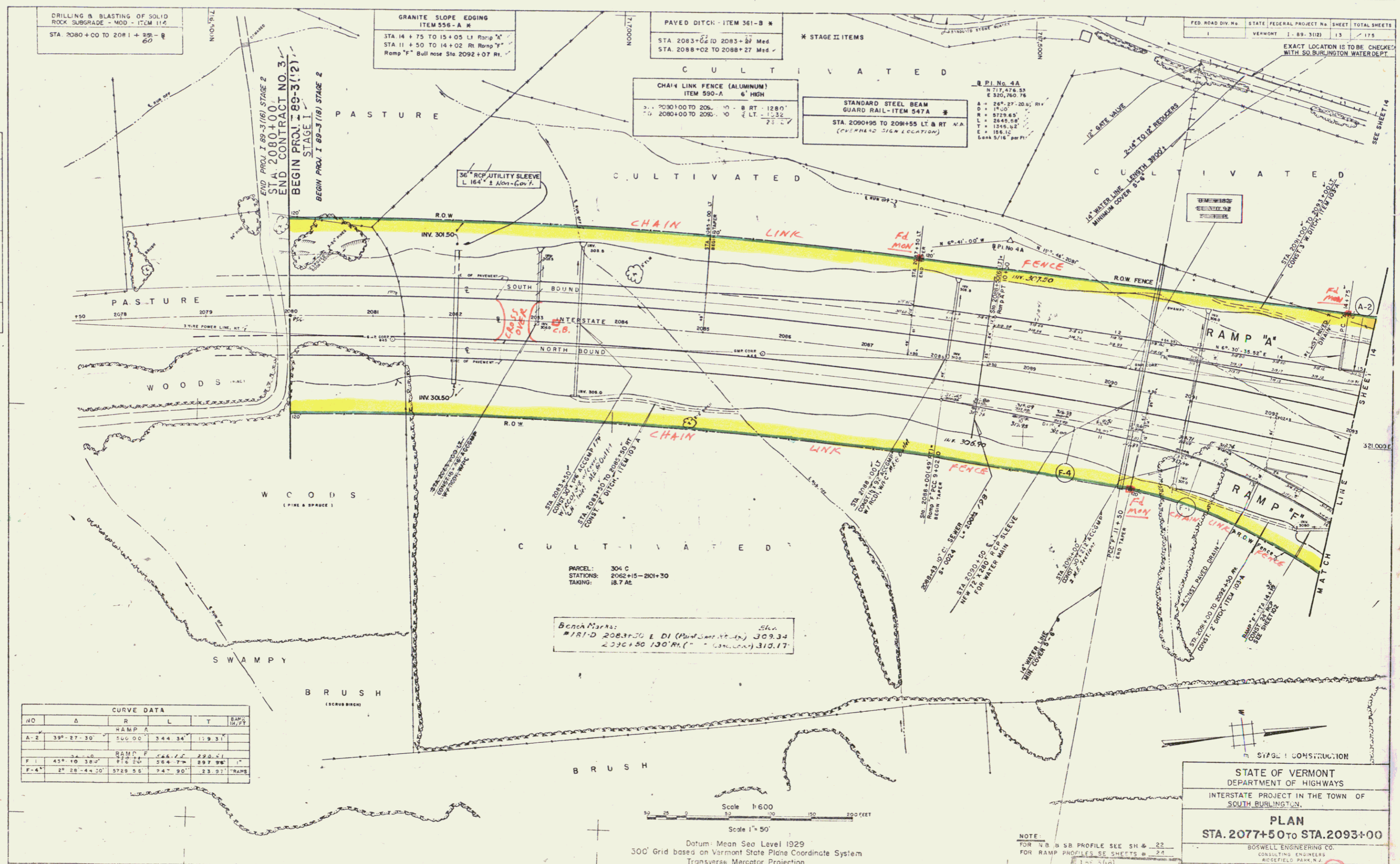

CURVE DATA				
NO.	A	R	L	T
RAMP A				
A-2	39°-27'-30"	500.00'	344.34'	13.93'
RAMP F				
F-1	43°-10'-30"	778.24'	564.77'	22.81'
F-4	2°-28'-44'-30"	5789.55'	247.90'	23.97'

Parcel: 304 C
STATIONS: 2062+15-2101+30
TAKING: 18.7 AC

Benches:
#181-D 2083+20 E DI (Plan Sheet No.) 309.34
2390+50 130' W.C. (Plan Sheet No.) 310.17

Scale 1" = 600'
Scale 1" = 50'

Datum: Mean Sea Level 1929
300' Grid based on Vermont State Plane Coordinate System
Transverse Mercator Projection

NOTE:
FOR NB & SB PROFILE SEE SH & 22
FOR RAMP PROFILES SEE SHEETS # 24
1-1-89
STAGE I CONSTRUCTION
SHEET 29 OF 106

STATE OF VERMONT
DEPARTMENT OF HIGHWAYS
INTERSTATE PROJECT IN THE TOWN OF
SOUTH BURLINGTON.

PLAN
STA. 2077+50 TO STA. 2093+00

BOSWELL ENGINEERING CO.
CONSULTING ENGINEERS
WESTFIELD PARK, N.J.

PROJECT NO. 1-89-3(12) SHEET 13 OF 175