

PLAN	1/8" = 100'
PROFILES	1" = 20'
SECTION	1" = 20'
ASPHALT	1" = 100'
GRAVEL	1" = 100'
CONCRETE	1" = 100'
STEEL	1" = 100'
WOOD	1" = 100'
TRACED	1" = 100'

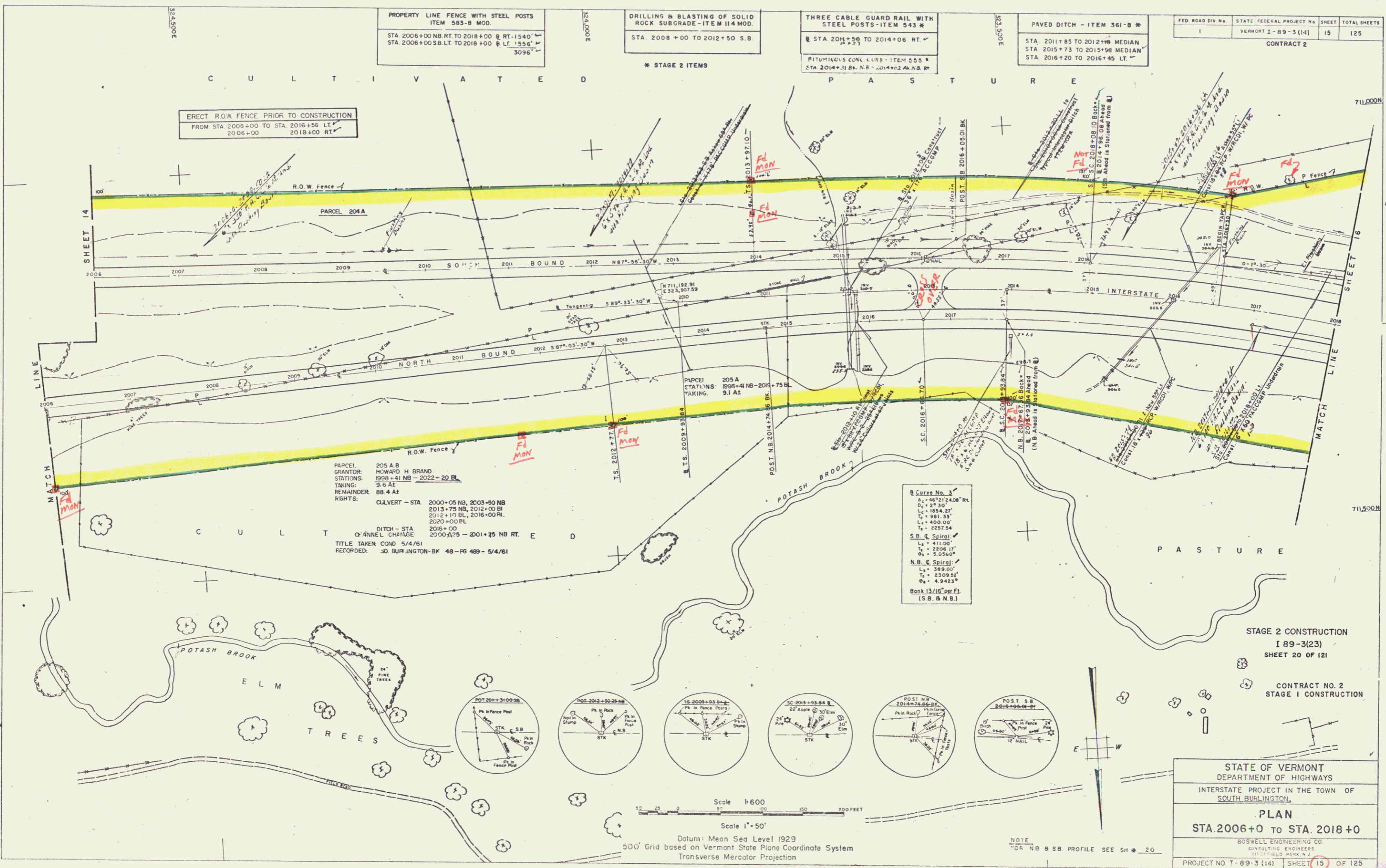

PROPERTY LINE FENCE WITH STEEL POSTS  
ITEM 583-B MOD.  
STA 2006+00 NB RT TO 2018+00 @ RT-1540'  
STA 2006+00 SB LT TO 2018+00 @ LT-1556'  
3096'

DRILLING & BLASTING OF SOLID  
ROCK SUBGRADE-ITEM 114 MOD.  
STA. 2008+00 TO 2012+50 S.B.

THREE CABLE GUARD RAIL WITH  
STEEL POSTS-ITEM 543 \*  
STA 2011+50 TO 2014+06 RT.  
PITUMINOUS CONC. CURB-ITEM 555 \*  
STA 2014+31 BL N.B.-2014+02 A.N.B. RT.

PAVED DITCH - ITEM 361-B \*  
STA 2011+85 TO 2012+10 MEDIAN  
STA 2015+73 TO 2015+98 MEDIAN  
STA 2016+20 TO 2016+45 LT.

FED. ROAD DIV. No.	STATE FEDERAL PROJECT No.	SHEET	TOTAL SHEETS
1	VERMONT I-89-3(14)	15	125
CONTRACT 2			

ERECT ROW FENCE PRIOR TO CONSTRUCTION  
FROM STA 2006+00 TO STA 2018+56 LT.  
2006+00 2018+00

PARCEL 205 A B  
GRANTOR: HOWARD H BRAND  
STATIONS: 898+41 NB - 2022 - 20 BL  
TAKING: 3 6/4 E  
REMAINDER: 88 4 A  
RIGHTS: CULVERT - STA 2000+05 NB, 2003+50 NB  
2013+75 NB, 2012+00 BI  
2012+10 BL, 2016+00 BL  
2020+00 BL  
DITCH - STA 2016+00  
QUINCY CHANGE 2000A'S - 2001+25 NB RT. E D  
TITLE TAKEN COND 5/4/61  
RECORDED: SO BURLINGTON-BK 48-PG 489-5/4/61

Cutline No. 3

A <sub>c</sub>	46712.08' Rt
A <sub>s</sub>	25.50'
L <sub>c</sub>	1854.23'
L <sub>s</sub>	981.23'
L <sub>t</sub>	400.00'
L <sub>b</sub>	2237.54'
S.B. & Spiral:	
L <sub>s</sub>	411.00'
L <sub>t</sub>	2204.17'
A <sub>s</sub>	5.50000'
N.B. & Spiral:	
L <sub>s</sub>	388.00'
L <sub>t</sub>	2309.55'
A <sub>s</sub>	4.94233'
Bank 13/18' per Ft	
(S.B. & N.B.)	

STAGE 2 CONSTRUCTION  
I 89-3(23)  
SHEET 20 OF 121

CONTRACT NO. 2  
STAGE 1 CONSTRUCTION

STATE OF VERMONT  
DEPARTMENT OF HIGHWAYS  
INTERSTATE PROJECT IN THE TOWN OF  
SOUTH BURLINGTON,  
PLAN  
STA. 2006+0 TO STA. 2018+0  
BOSWELL ENGINEERING CO.  
CONSULTING ENGINEERS  
SOUTHFIELD PARK, N.J.  
PROJECT NO. I-89-3(14) SHEET 15 OF 125

Scale 1" = 50'  
Scale 1/8" = 100'  
Dotum: Mean Sea Level 1929  
500' Grid based on Vermont State Plane Coordinate System  
Transverse Mercator Projection

NOTE  
FOR NB & SB PROFILE SEE SH # 20.

Const + Row