

PLAN	DESIGNED	BY	SK
	CHECKED		
	DATE		
	BY		
	DATE		

ERECT ROW FENCE PRIOR TO CONSTRUCTION
FROM STA 1991+00 TO STA 2006+00 L.P.
1998+55 2006+00 RT

PROPERTY LINE FENCE WITH STEEL POSTS
ITEM 583-B MOD.
STA 1991+00 TO 2006+00 - N.B. RT - 1626' ✓
STA 1991+00 TO 2006+00 - S.B. LT - 1774' ✓
3400'

STANDARD STEEL BEAM GUARD RAIL
ITEM 547-A W
STA 1999+54 TO 2000+08 NB LT ✓
STA 1999+84 TO 2000+38 NB RT ✓
STA 1997+22 TO 1997+76 SB LT ✓
STA 1997+62 TO 1998+16 SB RT ✓

MUCK EXCAVATION
ITEM 66
STA 1992+08 TO 1995+50 NB
STA 2004+00 TO 2004+50 NB
STA 1991+00 TO 1994+50 SB
STA 1994+08 TO 1998+00 SB
Sta. 2004+00 to Sta. 2004+50 NB,
Sta. -002+39 to Sta. +00+00 MB

FED. ROAD DIV. NO.	STATE	FEDERAL PROJECT NO.	SHEET	TOTAL SHEETS
1	VERMONT	I-89-3(14)	14	125

CONTRACT 2
PARCEL: 204 A,B
GRANTOR: NELLIE M BRAND, MYRA M BRAND & HOWARD H BRAND
STATIONS: 1997+30 SB - 2001+00 BL
TAPING: 11.4 AL
REMAINDER: 110.6 At
RIGHTS: NONE

TITLE TAKEN
RECORDED: COND 5/4/61
SO. BURLINGTON - BK. 48 - PG 489 - 5/4/61

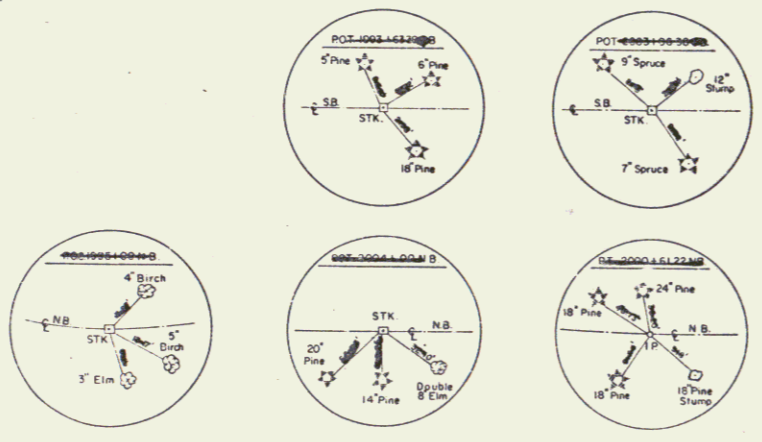
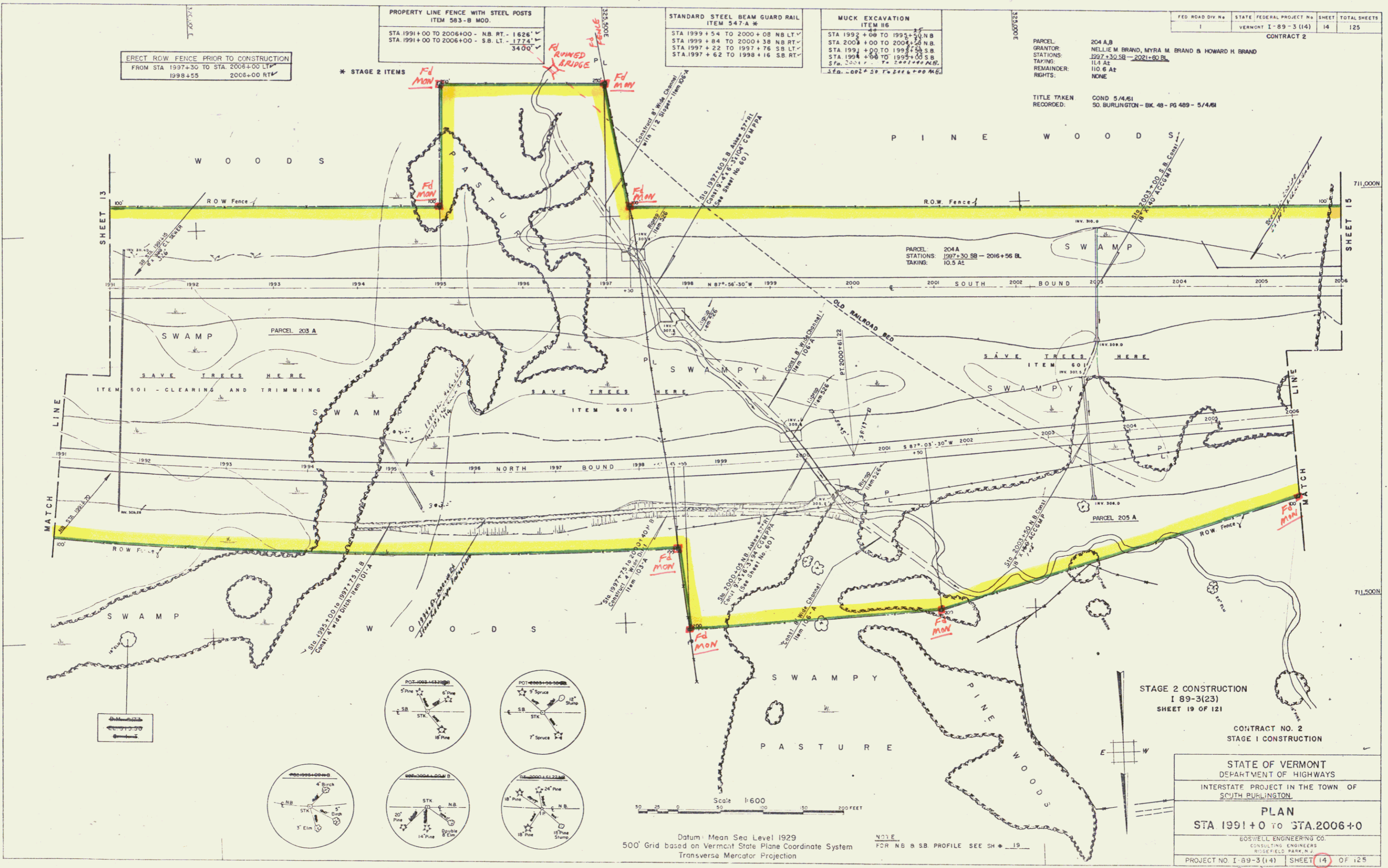

Datum: Mean Sea Level 1929
500' Grid based on Vermont State Plane Coordinate System
Transverse Mercator Projection

Scale 1:600
FOR NB & SB PROFILE SEE SH # 19

STAGE 2 CONSTRUCTION
I 89-3(23)
SHEET 19 OF 121

CONTRACT NO. 2
STAGE 1 CONSTRUCTION

STATE OF VERMONT
DEPARTMENT OF HIGHWAYS
INTERSTATE PROJECT IN THE TOWN OF
SOUTH BURLINGTON
PLAN
STA 1991+0 TO STA 2006+0
BOSWELL ENGINEERING CO.
CONSULTING ENGINEERS
RUSSELL PARK, N.J.
PROJECT NO. I-89-3(14) | SHEET 14 OF 125
const & Row