

STANDARD STEEL BEAM GUARD RAIL - ITEM 547A *
 STA 1943+75 TO STA 1944+29 NB RT.
 STA 1943+75 TO STA 1944+29 SB LT.
 STA 1943+34 TO STA 1943+88 SB LT.
 STA 1943+44 TO STA 1943+98 SB RT.

MUCK EXCAVATION ITEM 116
 STA 1943+00 TO STA 1944+00

DRILLING & BLASTING OF SOLID ROCK SUBGRADE MOD - ITEM 114
 STA 1930+00 TO STA 1935+00 NB
 STA 1930+00 TO STA 1935+00 SB

PLANTING TREES, SHRUBS AND VINES - ITEM 631 MOD. *
 SEE SHADED AREA AND QUANTITY SHEET

PROPERTY LINE FENCE WITH STEEL POSTS ITEM 583-B MOD
 STA 1930+00 TO 1945+00 N.B. RT. - 1460'
 STA 1930+00 TO 1945+00 S.B. LT. - 1470'
 2950'
 2848'

FED. ROAD DIV. No.	STATE	FEDERAL PROJECT No.	SHEET	TOTAL SHEETS
1	VERMONT	1-89-3(14)	15	115

BY	DATE
DESIGNED	
CHECKED	
IN CHARGE	
DATE	

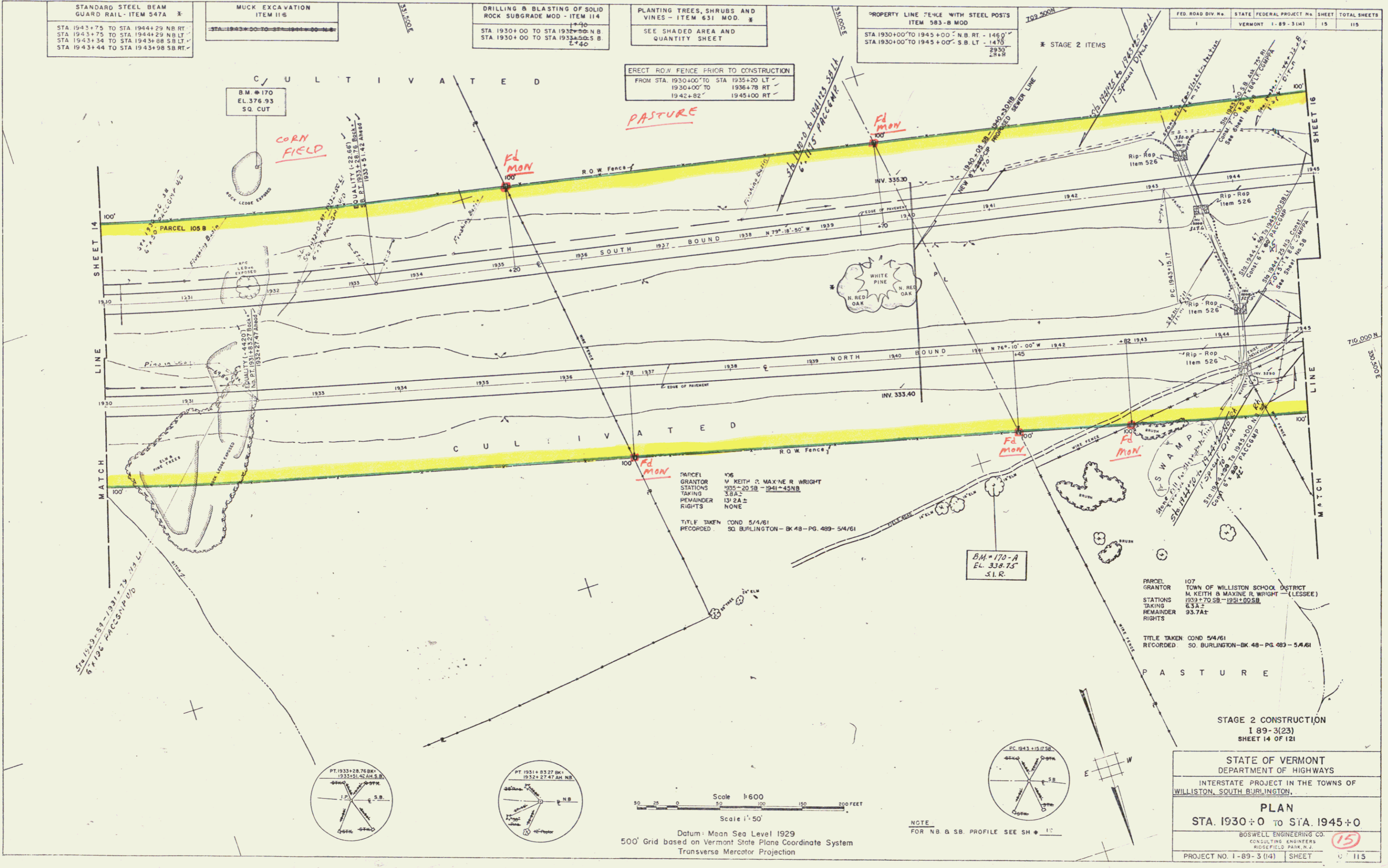

Datum: Mean Sea Level 1929
 500' Grid based on Vermont State Plane Coordinate System
 Transverse Mercator Projection

NOTE
 FOR NB & SB. PROFILE SEE SH # 11

STAGE 2 CONSTRUCTION
 1 89-3(23)
 SHEET 14 OF 121

STATE OF VERMONT
 DEPARTMENT OF HIGHWAYS
 INTERSTATE PROJECT IN THE TOWNS OF
 WILLISTON, SOUTH BURLINGTON.

PLAN
 STA. 1930+0 TO STA. 1945+0

BOSWELL ENGINEERING CO.
 CONSULTING ENGINEERS
 ROSELAND PARK, N.J.

PROJECT NO. 1-89-3(14) SHEET 15 OF 115

STAGE 1 CONTRACT 1
 Const & Row
 8