

INDEX OF SHEETS

1-TITLE SHEET
2-DATA SHEET
3-SECTION 3 (CONCRETE PAVEMENT)

4-SECTION 4 (CONCRETE PAVEMENT)

5-SECTION 5 (CONCRETE PAVEMENT)

6-SECTION 6 (CONCRETE PAVEMENT)

7-SECTION 7 (CONCRETE PAVEMENT)

8-SECTION 8 (CONCRETE PAVEMENT)

9-SECTION 9 (CONCRETE PAVEMENT)

10-SECTION 10 (CONCRETE PAVEMENT)

11-SECTION 11 (CONCRETE PAVEMENT)

12-SECTION 12 (CONCRETE PAVEMENT)

13-SECTION 13 (CONCRETE PAVEMENT)

14-SECTION 14 (CONCRETE PAVEMENT)

15-SECTION 15 (CONCRETE PAVEMENT)

16-SECTION 16 (CONCRETE PAVEMENT)

17-SECTION 17 (CONCRETE PAVEMENT)

18-SECTION 18 (CONCRETE PAVEMENT)

19-SECTION 19 (CONCRETE PAVEMENT)

20-SECTION 20 (CONCRETE PAVEMENT)

21-SECTION 21 (CONCRETE PAVEMENT)

22-SECTION 22 (CONCRETE PAVEMENT)

23-SECTION 23 (CONCRETE PAVEMENT)

24-SECTION 24 (CONCRETE PAVEMENT)

25-SECTION 25 (CONCRETE PAVEMENT)

26-SECTION 26 (CONCRETE PAVEMENT)

27-SECTION 27 (CONCRETE PAVEMENT)

28-SECTION 28 (CONCRETE PAVEMENT)

29-SECTION 29 (CONCRETE PAVEMENT)

30-SECTION 30 (CONCRETE PAVEMENT)

31-SECTION 31 (CONCRETE PAVEMENT)

32-SECTION 32 (CONCRETE PAVEMENT)

33-SECTION 33 (CONCRETE PAVEMENT)

34-SECTION 34 (CONCRETE PAVEMENT)

35-SECTION 35 (CONCRETE PAVEMENT)

36-SECTION 36 (CONCRETE PAVEMENT)

37-SECTION 37 (CONCRETE PAVEMENT)

38-SECTION 38 (CONCRETE PAVEMENT)

39-SECTION 39 (CONCRETE PAVEMENT)

40-SECTION 40 (CONCRETE PAVEMENT)

41-SECTION 41 (CONCRETE PAVEMENT)

42-SECTION 42 (CONCRETE PAVEMENT)

43-SECTION 43 (CONCRETE PAVEMENT)

44-SECTION 44 (CONCRETE PAVEMENT)

45-SECTION 45 (CONCRETE PAVEMENT)

46-SECTION 46 (CONCRETE PAVEMENT)

47-SECTION 47 (CONCRETE PAVEMENT)

48-SECTION 48 (CONCRETE PAVEMENT)

49-SECTION 49 (CONCRETE PAVEMENT)

50-SECTION 50 (CONCRETE PAVEMENT)

51-SECTION 51 (CONCRETE PAVEMENT)

52-SECTION 52 (CONCRETE PAVEMENT)

53-SECTION 53 (CONCRETE PAVEMENT)

54-SECTION 54 (CONCRETE PAVEMENT)

55-SECTION 55 (CONCRETE PAVEMENT)

56-SECTION 56 (CONCRETE PAVEMENT)

57-SECTION 57 (CONCRETE PAVEMENT)

58-SECTION 58 (CONCRETE PAVEMENT)

59-SECTION 59 (CONCRETE PAVEMENT)

60-SECTION 60 (CONCRETE PAVEMENT)

61-SECTION 61 (CONCRETE PAVEMENT)

62-SECTION 62 (CONCRETE PAVEMENT)

63-SECTION 63 (CONCRETE PAVEMENT)

64-SECTION 64 (CONCRETE PAVEMENT)

65-SECTION 65 (CONCRETE PAVEMENT)

66-SECTION 66 (CONCRETE PAVEMENT)

67-SECTION 67 (CONCRETE PAVEMENT)

68-SECTION 68 (CONCRETE PAVEMENT)

69-SECTION 69 (CONCRETE PAVEMENT)

70-SECTION 70 (CONCRETE PAVEMENT)

71-SECTION 71 (CONCRETE PAVEMENT)

72-SECTION 72 (CONCRETE PAVEMENT)

73-SECTION 73 (CONCRETE PAVEMENT)

74-SECTION 74 (CONCRETE PAVEMENT)

75-SECTION 75 (CONCRETE PAVEMENT)

76-SECTION 76 (CONCRETE PAVEMENT)

77-SECTION 77 (CONCRETE PAVEMENT)

78-SECTION 78 (CONCRETE PAVEMENT)

79-SECTION 79 (CONCRETE PAVEMENT)

80-SECTION 80 (CONCRETE PAVEMENT)

81-SECTION 81 (CONCRETE PAVEMENT)

82-SECTION 82 (CONCRETE PAVEMENT)

83-SECTION 83 (CONCRETE PAVEMENT)

84-SECTION 84 (CONCRETE PAVEMENT)

85-SECTION 85 (CONCRETE PAVEMENT)

86-SECTION 86 (CONCRETE PAVEMENT)

87-SECTION 87 (CONCRETE PAVEMENT)

88-SECTION 88 (CONCRETE PAVEMENT)

89-SECTION 89 (CONCRETE PAVEMENT)

90-SECTION 90 (CONCRETE PAVEMENT)

91-SECTION 91 (CONCRETE PAVEMENT)

92-SECTION 92 (CONCRETE PAVEMENT)

93-SECTION 93 (CONCRETE PAVEMENT)

94-SECTION 94 (CONCRETE PAVEMENT)

95-SECTION 95 (CONCRETE PAVEMENT)

96-SECTION 96 (CONCRETE PAVEMENT)

97-SECTION 97 (CONCRETE PAVEMENT)

98-SECTION 98 (CONCRETE PAVEMENT)

99-SECTION 99 (CONCRETE PAVEMENT)

100-SECTION 100 (CONCRETE PAVEMENT)

STATE OF VERMONT
DEPARTMENT OF HIGHWAYS

PROPOSED IMPROVEMENT

CITY OF BURLINGTON-TOWN OF SO. BURLINGTON

COUNTY OF CHITTENDEN

PROJECT I-89-3(16) STAGE 2
BEGINNING AT A POINT IN SOUTH BURLINGTON 2.268 MILES WEST OF THE WILLISTON-SOUTH BURLINGTON TOWN LINE AT MUDDY BROOK AND EXTENDING NORTHERLY FOR A DISTANCE OF 1.042 MILES.

LENGTH OF ROADWAY 5,327.96 FEET or 1.009 MILES
LENGTH OF BRIDGES 172.04 FEET or 0.033 MILE
LENGTH OF PROJECT 5,500.00 FEET or 1.042 MILES

DESIGN	DESIGNATION
ADT	1959 4520
ADT	1975 1450
DHV	1975 2075
D	5%
V	11%
	70 MPH

PROJECT I-189-3(17) STAGE 2 (Construction #4)
BEGINNING AT A POINT APPROXIMATELY 0.217 MILE WEST OF THE CITY OF BURLINGTON AND THE TOWN OF SOUTH BURLINGTON TOWN LINE ON U.S. ROUTE 7 AND EXTENDING EASTERLY 1.367 MILES.

LENGTH OF ROADWAY 6,871.45 FEET or 1.301 MILES
LENGTH OF BRIDGES 348.00 FEET or 0.066 MILE
LENGTH OF PROJECT 7,219.45 FEET or 1.367 MILES

DESIGN	DESIGNATION
ADT	1959 4450
ADT	1975 850
DHV	1250
D	5%
V	11%
	60 MPH

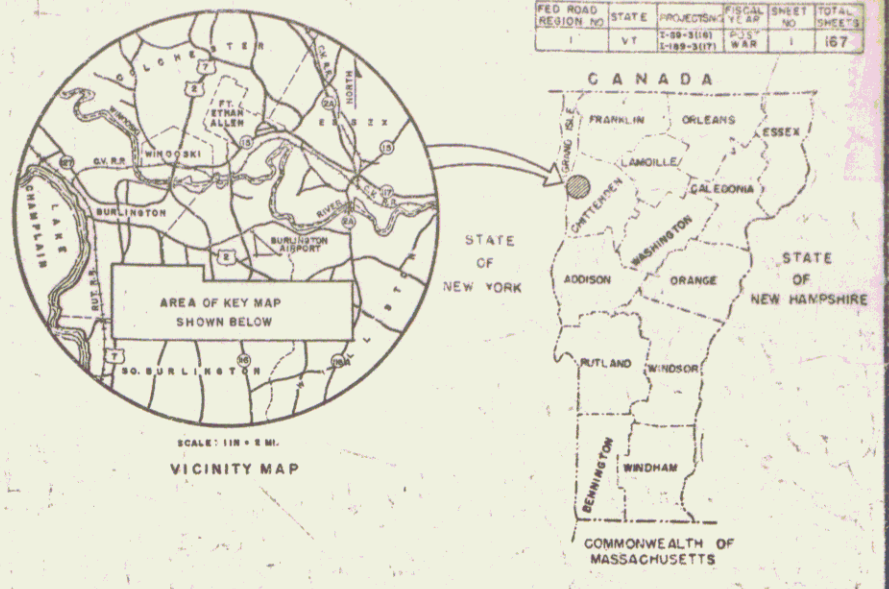

PROJECT NAME & NUMBER	TYPE	PAVEMENT AREA
BURLINGTON-SO. 1-89-3(16)	BITUMINOUS	29,333 S.Y.
BURLINGTON 1-189-3(17)	CONCRETE	38,504 S.Y.

RECORD PLANS

MATERIALS

GRAVEL BACKFILL - CASEY PIT - VERMONT.
SUB BASE OF CRUSHED ROCK, CRUSHED STONE
AGGREGATE CRUSHED STONE BASE COURSE
AGGREGATE CRUSHED STONE - WINDOSKI
PITS - DEMERS QUARRY - WINDOSKI
SAND CUSHION - U.V.N. PIT & L. PLOUGH PIT
ST. GELAIS PIT - COLCHES
OUTBACK ASPH. & ASPH. CEMENT - TRIM JOINT BIT.
TAR EMULSION FOR BRIDGE FLOORS - KOFFERS PROC.
BITUMINOUS CONCRETE - L.M. PIKE & SON INC.
JOINT SEALER - HOT POURED ELASTIC TYPE - SERV.
CONCRETE CLASS "B" - ST. GRISWOLD & CO. INC. -
REIN. STEEL, STEEL CABLE, BEAM & PILE FOR
MARKER POSTS - BETHLEHEM STEEL CO. - PETH
ASPH. GID. CORR. GALV. MET. PIPE & ELBOWS, C.I.P.
DRAIN FLUSHING
BASINS - NEW ENGLAND METAL PIPE CO. - WHITE
STEEL DROP INLET GRATES - VERMONT STRUCTURAL
GRANITE SLOPE EDGING - BARRETT TO GRANITE CO.
TRAFFIC SIGNS - STANDARD SIGNS & SIGNAL CO. - CL.
OVERHEAD TRAFFIC SIGN SUPPORTS - PLAVNET CORP.
DELINEATORS - ELIZABETH DIV. ELASTIC SHOP - NAT.
SEEDING (SLOPES) - JOHN D. LYONS - CAMBRIDGE
COMMERCIAL FERTILIZER - BURLINGTON RENDERING
CONTRACTOR - THE LAF. CONSTRUCTION CORP. C.
MERIDIAN CON. SEPTEMBER 28, 1961
INSPECTOR - J. STEARNS WAYNE JARVIS, A. APRIL 19, 1962
ELWOOD, G. M. J. & R. P. RYAN, D. NOV. 29, 1962
RECORD PLANS - JAMES W. STEARNS, NOVEMBER 29, 1962

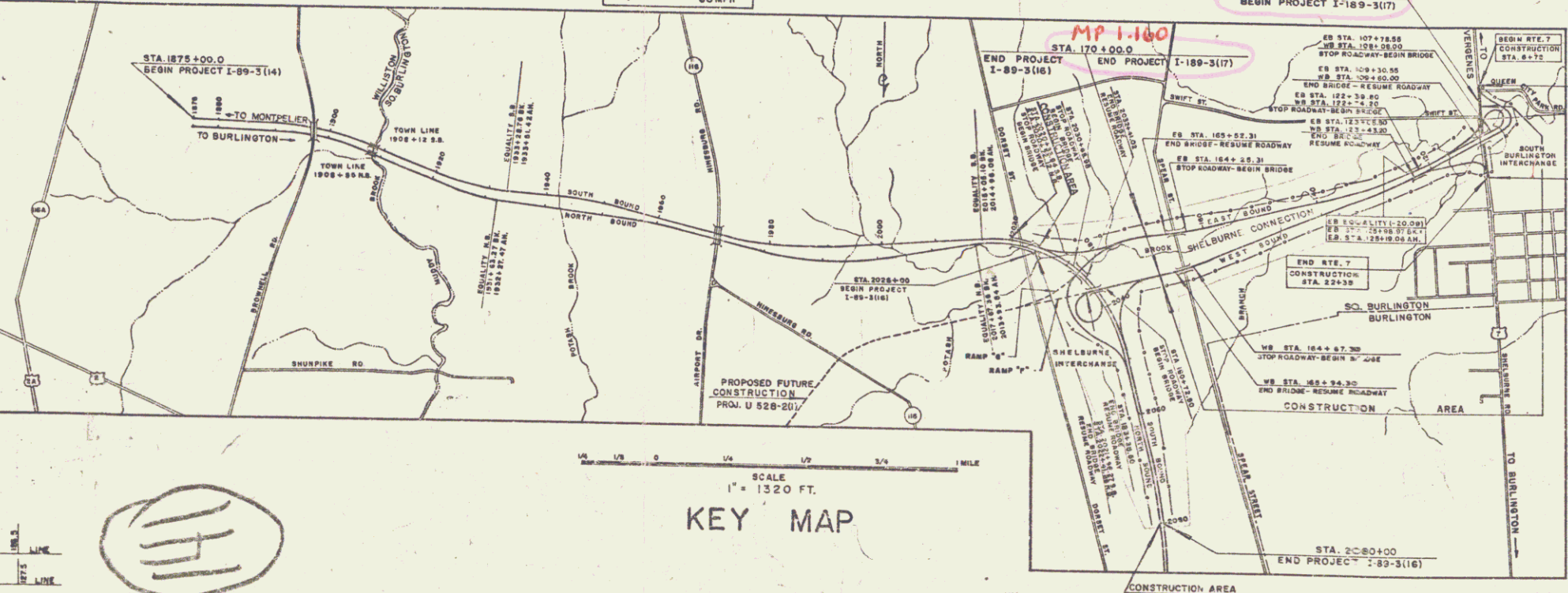

CONVENTIONAL SIGNS

R.O.W. FENCE
COUNTY LINE
FENCE LINE
STONE WALL
UNFENCED PROPERTY
GUARD RAIL
TRAVELED WAY
DRAINAGE
POWER POLE
TELEPHONE POLE
TREES
MIDGE

ELEVATION DATUM
ELEVATION DATUM
CURVE DATA
OF ANGLE
OF CURVE
OF CURVE
DISTANCE
OF CURVE
TANGENT
INTERSECTION
CURVE
TANGENT



SCALES

TITLE	1" = 1320 FT.
TYPICAL	1" = As Shown
PLAN	1" = 30 FT.
PROFILE HORIZONTAL	1" = 50 FT.
PROFILE VERTICAL	1" = 10 FT.
CROSS-SECTIONS	1" = 10' or 5'

APPROVED	APPROVED	APPROVED	APPROVED	APPROVED	APPROVED
SECONDARY ENGINEER	CONSTRUCTION ENGINEER	BRIDGE ENGINEER	DISTRICT ENGINEER	HIGHWAY ENGINEER	CONTRACT ENGINEER
DATE	DATE July 14, 1961	DATE July 17, 1961	DATE July 19, 1961	DATE July 13, 1961	DATE July 12, 1961

STAGE 2 CONSTRUCTION

DEPARTMENT OF COMMERCE
BUREAU OF PUBLIC ROADS

APPROVED

DIVISION ENGINEER DATE

PROJECT I NO. 189-3(17)

SHEET D OF 167 SHEETS

Pin # 99202D
Project I-189-3(17)
Route I-189

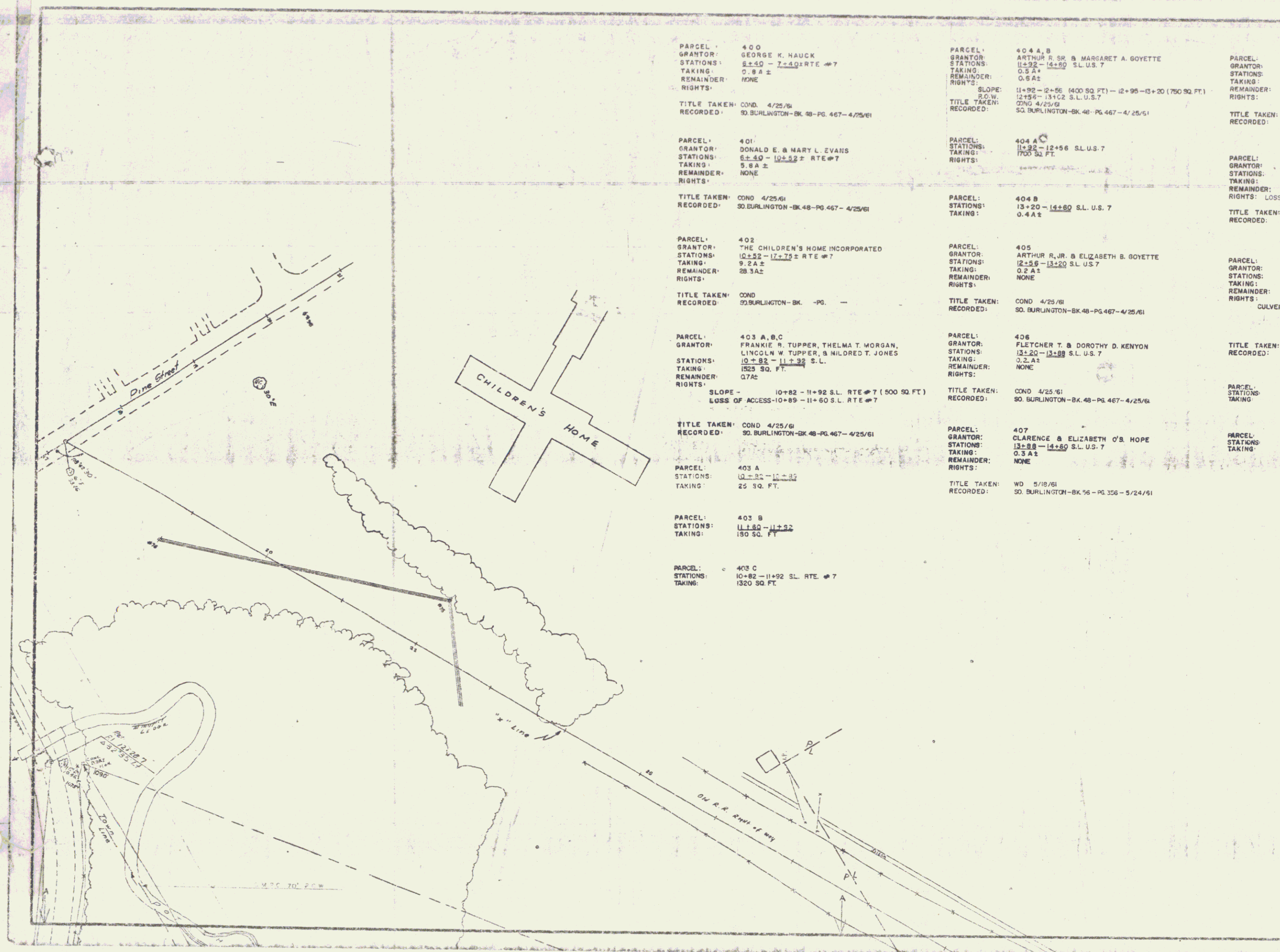

PARCEL: 400
 GRANTOR: GEORGE K. HAUCK
 STATIONS: 8±50 - 7±40 RTE #7
 TAKING: D. 8 A ±
 REMAINDER: NONE
 RIGHTS:
 TITLE TAKEN: COND. 4/25/61
 RECORDED: SO. BURLINGTON-BK. 48-PG. 467-4/25/61

PARCEL: 401
 GRANTOR: DONALD E. & MARY L. ZVARS
 STATIONS: 6±50 - 10±52± RTE #7
 TAKING: 5. 8 A ±
 REMAINDER: NONE
 RIGHTS:
 TITLE TAKEN: COND. 4/25/61
 RECORDED: SO. BURLINGTON-BK. 48-PG. 467-4/25/61

PARCEL: 402
 GRANTOR: THE CHILDREN'S HOME INCORPORATED
 STATIONS: 10±52 - 17±75± RTE #7
 TAKING: 9. 2 A ±
 REMAINDER: 28. 3 A ±
 RIGHTS:
 TITLE TAKEN: COND. 4/25/61
 RECORDED: SO. BURLINGTON-BK. -PG. -

PARCEL: 403 A, B, C
 GRANTOR: FRANKIE R. TUPPER, THELMA T. MORGAN, LINCOLN W. TUPPER, & MILDRED T. JONES
 STATIONS: 10±82 - 11±92 S.L.
 TAKING: 1223 SQ. FT.
 REMAINDER: 0.7 A ±
 RIGHTS: SLOPE - 10±82 - 11±92 S.L. RTE #7 (500 SQ. FT.)
 LOSS OF ACCESS-10±89 - 11±60 S.L. RTE #7

PARCEL: 403 A
 GRANTOR:
 STATIONS: 10±82 - 11±92
 TAKING: 25 SQ. FT.

PARCEL: 403 B
 GRANTOR:
 STATIONS: 11±80 - 11±92
 TAKING: 130 SQ. FT.

PARCEL: 403 C
 GRANTOR:
 STATIONS: 10±82 - 11±92 S.L. RTE. #7
 TAKING: 1320 SQ. FT.

PARCEL: 404 A, B
 GRANTOR: ARTHUR R. JR. & MARGARET A. GOYETTE
 STATIONS: 11±92 - 14±60 S.L. U.S. 7
 TAKING: 0.5 A ±
 REMAINDER: 0.6 A ±
 RIGHTS: SLOPE: 11±92 - 2±55 (400 SQ. FT.) - 12±95 - 13±20 (750 SQ. FT.)
 S.O.W. 12±55 - 13±52 S.L. U.S. 7
 TITLE TAKEN: COND. 4/25/61
 RECORDED: SO. BURLINGTON-BK. 48-PG. 467-4/25/61

PARCEL: 404 A
 GRANTOR:
 STATIONS: 11±92 - 12±56 S.L. U.S. 7
 TAKING: 1700 SQ. FT.
 RIGHTS:
 PARCEL: 404 B
 GRANTOR:
 STATIONS: 13±20 - 14±60 S.L. U.S. 7
 TAKING: 0.4 A ±

PARCEL: 405
 GRANTOR: ARTHUR R. JR. & ELIZABETH B. GOYETTE
 STATIONS: 12±55 - 13±20 S.L. U.S. 7
 TAKING: 0.2 A ±
 REMAINDER: NONE
 RIGHTS:
 TITLE TAKEN: COND. 4/25/61
 RECORDED: SO. BURLINGTON-BK. 48-PG. 467-4/25/61

PARCEL: 406
 GRANTOR: FLETCHER T. & DOROTHY D. KENYON
 STATIONS: 13±20 - 13±88 S.L. U.S. 7
 TAKING: 0.2 A ±
 REMAINDER: NONE
 RIGHTS:
 TITLE TAKEN: COND. 4/25/61
 RECORDED: SO. BURLINGTON-BK. 48-PG. 467-4/25/61

PARCEL: 407
 GRANTOR: CLARENCE & ELIZABETH O'S HOPE
 STATIONS: 13±88 - 14±60 S.L. U.S. 7
 TAKING: 0.3 A ±
 REMAINDER: NONE
 RIGHTS:
 TITLE TAKEN: WD. 5/19/61
 RECORDED: SO. BURLINGTON-BK. 56-PG. 356-5/24/61

PARCEL: 408
 GRANTOR: HELEN V. COPP, ROBERT D. COPP, & STILLMAN V. COPP
 STATIONS: 11±75 - 11±60 E.B.
 TAKING: 1800 SQ. FT. C
 REMAINDER: 0.6 A ±
 RIGHTS:
 TITLE TAKEN: COND. 4/25/61
 RECORDED: SO. BURLINGTON-BK. 48-PG. 467-4/25/61

PARCEL: 409
 GRANTOR: SEAWAY SHIPPING CENTER, CORP.
 STATIONS: 11±53 - 11±59 W.B.
 TAKING: 0.3 A ±
 REMAINDER: 8.2 A ±
 RIGHTS: LOSS OF ACCESS-STA. 20±25 - 22±00 S.L. U.S. 7
 TITLE TAKEN: COND. 3/16/61
 RECORDED: SO. BURLINGTON-BK. 48-PG. 425-3/16/61

PARCEL: 410 A
 GRANTOR: THOMAS A. FARRELL
 STATIONS: 12±5 - 12±57 W.B.
 TAKING: 12.5 A ±
 REMAINDER: 41.9 A ±
 RIGHTS: CULVERT-STA. 124±36 W.B., 119±00 E.B., 119±50 E.B.

PARCEL: 410 A
 GRANTOR:
 STATIONS: 12±5 - 12±57 W.B.
 TAKING: 10.8 A ±

PARCEL: 410 B
 GRANTOR:
 STATIONS: 122±49 E.B. - 125±57 W.B.
 TAKING: 2.0 A ±

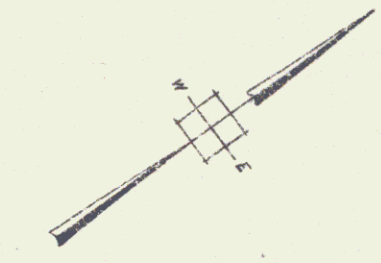

STATE OF VERMONT
 DEPARTMENT OF HIGHWAYS
 INTERSTATE PROJECT IN THE TOWNS OF
 BURLINGTON, SOUTH BURLINGTON
 PLAN
 SOUTH BURLINGTON INTERCHANGE
 BOSWELL ENGINEERING CO. RICHFIELD VILLAGE, N.H.
 DRAWN BY: V.R.K. | CHECKED BY: R.J. [unclear] | SCALE: 1"=40'
 PROJECT NO. I-193-3(11) SHEET 15 OF 200

119 2

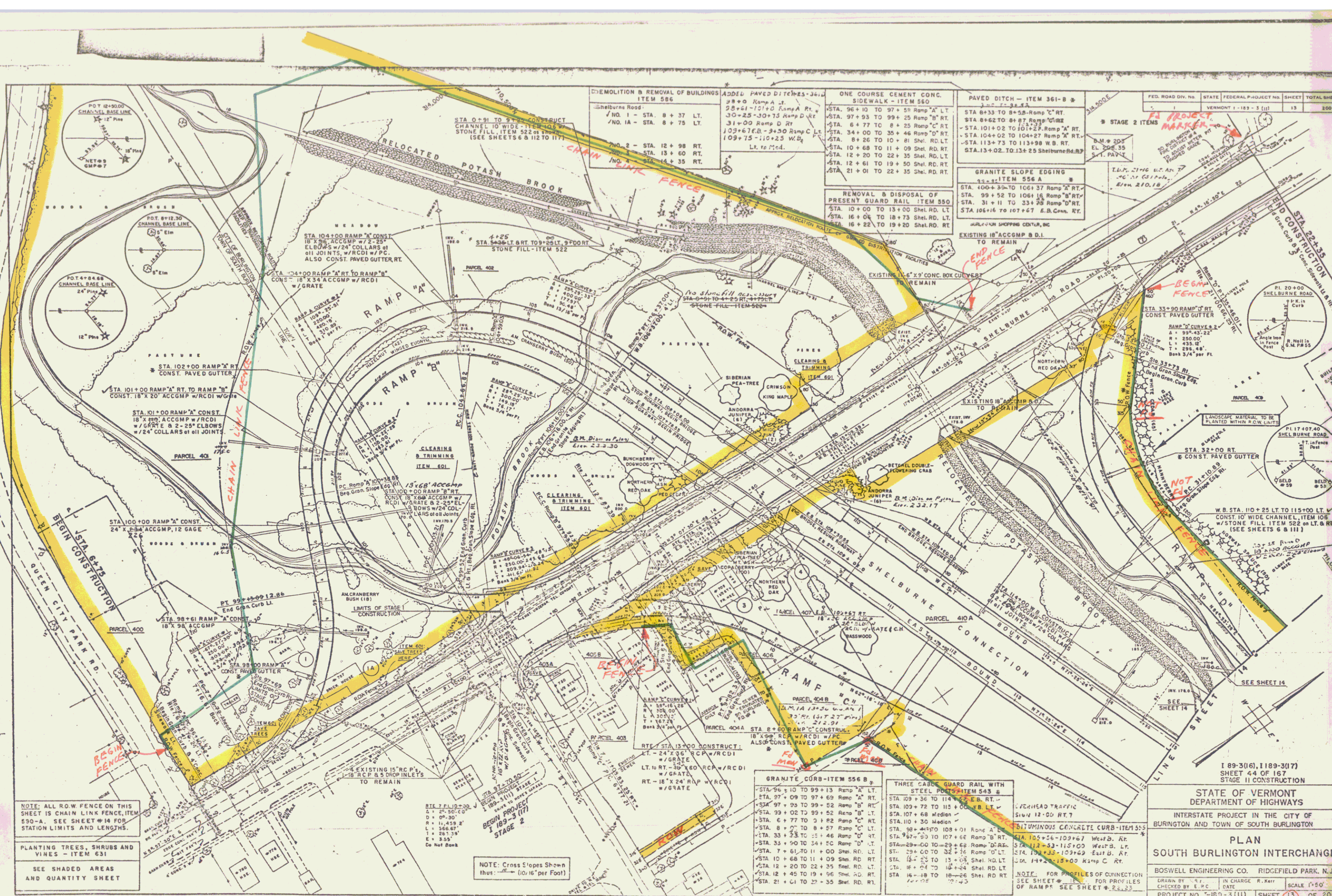

NOTE: ALL ROW FENCE ON THIS SHEET IS CHAIN LINK FENCE, ITEM 530-A. SEE SHEET #14 FOR STATION LIMITS AND LENGTHS.

PLANTING TREES, SHRUBS AND VINES - ITEM 431
SEE SHADDED AREAS AND QUANTITY SHEET

NOTE: Cross Slopes Shown thus: (0.16' per Foot)

DEMOLITION & REMOVAL OF BUILDINGS
ITEM 586
Shelburne Road
/NO. 1 - STA. 8 + 37 LT.
/NO. 1A - STA. 8 + 75 LT.
/NO. 2 - STA. 12 + 98 RT.
/NO. 3 - STA. 13 + 60 RT.
/NO. 4 - STA. 14 + 35 RT.

ADDED PAVED DITCHES - JAIL
28+00 Ramp A LT.
28+41-12+00 Ramp A RT.
30+25-30+75 Ramp D RT.
31+00 Ramp D RT.
109+75-110+25 W.B.
LT. to 170.4.

ONE COURSE CEMENT CONC.
SIDEWALK - ITEM 560
STA. 96 + 10 TO 97 + 58 Ramp "A" LT.
STA. 97 + 93 TO 99 + 25 Ramp "B" RT.
STA. 64 + 77 TO 8 + 25 Ramp "C" RT.
STA. 34 + 00 TO 35 + 46 Ramp "D" RT.
STA. 8 + 26 TO 10 + 81 Shd. RD. LT.
STA. 10 + 68 TO 11 + 09 Shd. RD. LT.
STA. 12 + 20 TO 22 + 35 Shd. RD. LT.
STA. 12 + 61 TO 19 + 50 Shd. RD. RT.
STA. 21 + 01 TO 22 + 35 Shd. RD. RT.

PAVED DITCH - ITEM 361-B
STA. 8+33 TO 8+58 Ramp "C" RT.
STA. 8+62 TO 8+87 Ramp "C" RT.
STA. 101+02 TO 101+25 Ramp "A" RT.
STA. 104+02 TO 104+27 Ramp "A" RT.
STA. 113+73 TO 113+98 W.B. RT.
STA. 106+16 TO 107+67 A.B. Conn. RT.

GRANITE SLOPE EDGING
ITEM 556 A
STA. 100+33 TO 106+37 Ramp "A" RT.
STA. 99 + 52 TO 106+16 Ramp "B" RT.
STA. 31 + 11 TO 33+28 Ramp "D" RT.
STA. 106+16 TO 107+67 A.B. Conn. RT.

REMOVAL & DISPOSAL OF
PRESENT GUARD RAIL ITEM 550
STA. 10 + 00 TO 13 + 00 Shd. RD. LT.
STA. 16 + 04 TO 18 + 73 Shd. RD. LT.
STA. 16 + 22 TO 19 + 20 Shd. RD. RT.

EXISTING 18" X 9" CONC. BOX CURBS
TO REMAIN

EXISTING 18" X 9" CONC. BOX CURBS
TO REMAIN

EXISTING 18" X 9" CONC. BOX CURBS
TO REMAIN

189-30(6), 1189-30(7)
SHEET 44 OF 167
STAGE II CONSTRUCTION

STATE OF VERMONT
DEPARTMENT OF HIGHWAYS
INTERSTATE PROJECT IN THE CITY OF
BURLINGTON AND TOWN OF SOUTH BURLINGTON

PLAN
SOUTH BURLINGTON INTERCHANGE

BOSWELL ENGINEERING CO., RIDGEFIELD PARK, N.J.
DRAWN BY: [] IN CHARGE: R. KAY
CHECKED BY: E. P. C. DATE: [] SCALE: 1"=50'
PROJECT NO. 5-180-3 (11) SHEET 13 OF 200
STAGE I CONSTRUCTION

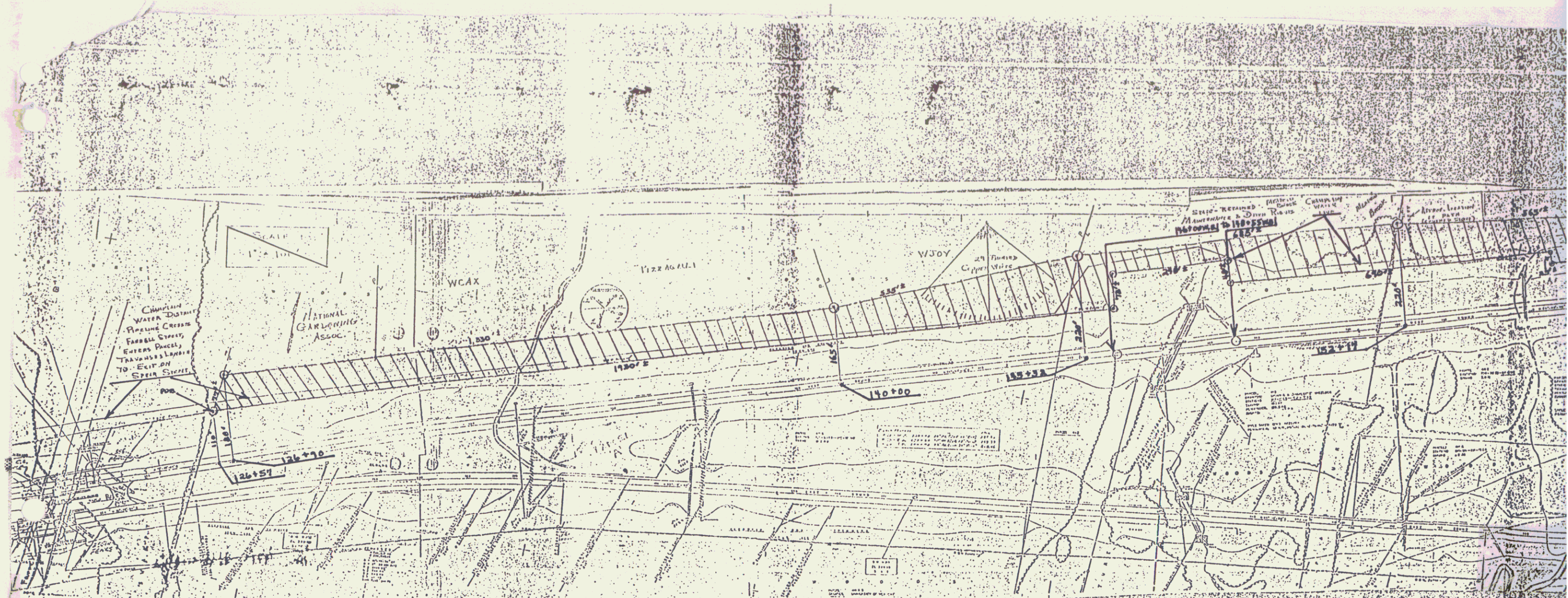

See STP-Bike (C) 5
 A.M. 92K 200
 Sheet 10

PARCEL
 THE
 Part
 Drawn by
 TAKEN



Proposed
 PARCEL OF LAND IN THE CITY OF SOUTH BURLINGTON
 COUNTY OF CHITTENDEN Sec STP
 STATE OF VERMONT *pike 65*
 TO
 THE CITY OF SOUTH BURLINGTON *210214*
 Portion of I-189 Right-of-Way
 SCALE: 1" = 200'
 Drawn by: M.S. Provost Date: September 9, 1991
 TAKEN FROM 1962 Project Plans I189-3(11)
 SHELburne CONNECTION

Sheet: **13B**

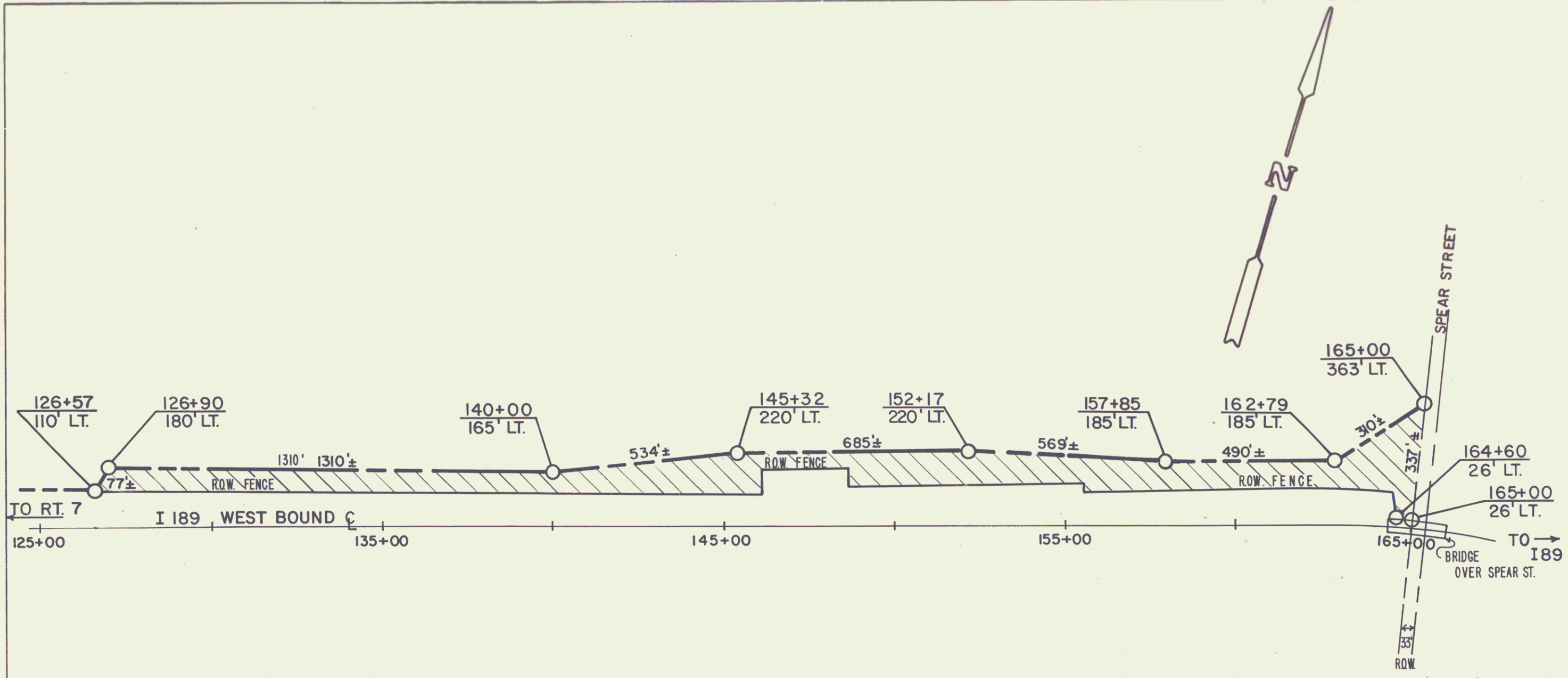

RIGHT-OF-WAY DIVISION
 TOWN FILE
 PERPETUAL
 Town of _____
 (To Be Returned To R.O.W. Division)

See STP Bike (6) S.P.# 92K294
 Renewed 8/3/95 (BK 381, Pg 501-505)
 expires 4/27/2005

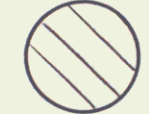
 Sold to City of SB
 12/19/1999 BK 466 pg 28
 LEASED AREA to City of So. Burlington,
 Lessee 4/28/85 to 4/27/95

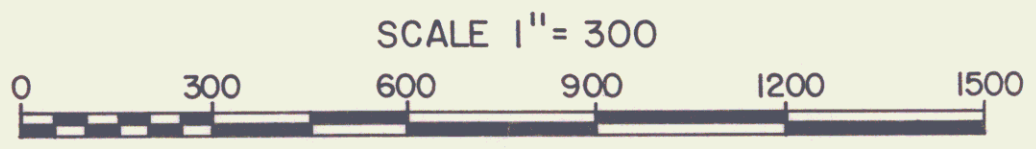

REF I 189-3(11) SHEETS 14-17 OF 200

STATE OF VERMONT
 AGENCY OF TRANSPORTATION

Sheet 13C

CITY OF SOUTH BURLINGTON

APPROX. SCALE 1" = 300'	DATE 3-11-82	DRAWN BY FJM
-------------------------	--------------	--------------

END MAINT. AGREE. AREA NO. 1 (FARRELL ST.)
WB123+55 105' LT

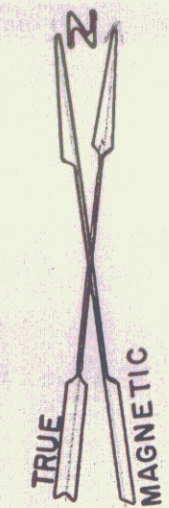
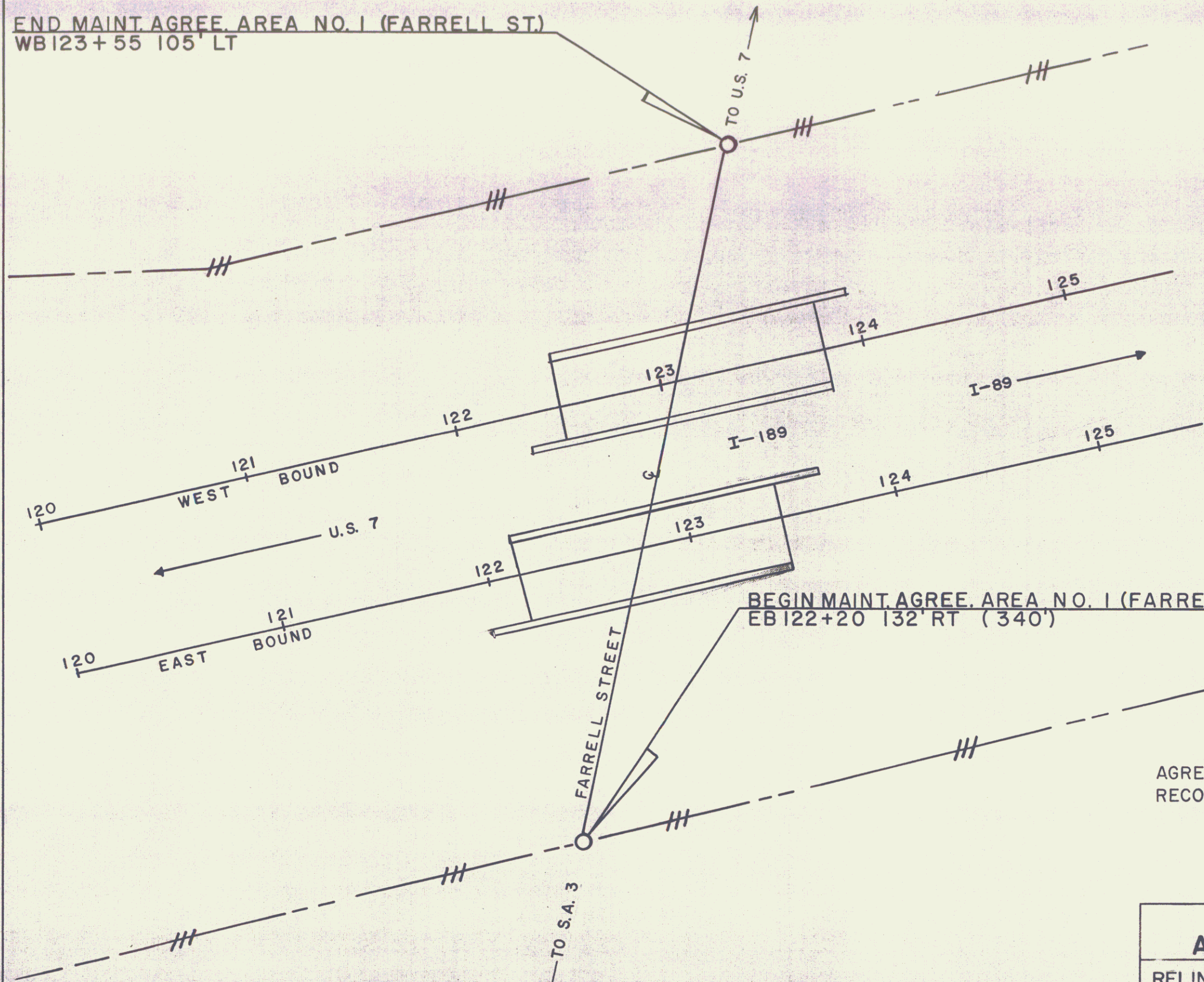

BEGIN MAINT. AGREE. AREA NO. 1 (FARRELL ST.)
EB122+20 132' RT (340°)

AGREE. DATED 7-7-81
RECORDED IN BK. 176, PAGES 1-7

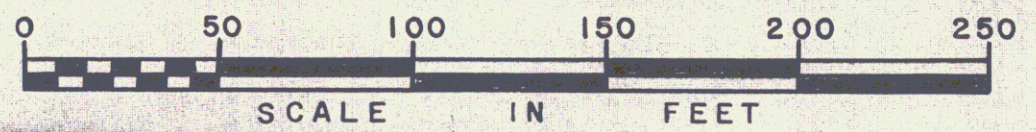

Sheet 13D

STATE OF VERMONT AGENCY OF TRANSPORTATION		
RELINQUISHMENT & MAINTENANCE PLATS CITY OF SO. BURLINGTON FARRELL STREET		
PROJ. BURLINGTON-SO. BURLINGTON I-89-3(8)		
APPROX. SCALE 1"=50'	DATE 9/3/74	DRAWN BY JEH

7

CHAIN LINK FENCE (ALUMINUM)
ITEM 590-A
(6' HIGH)
STA. 21+35 TO 29+00 RAMP 'D' RT. - 745'
STA. 15+00 TO 16+50 RAMP 'C' RT. - 210'
955'

STANDARD STEEL BEAM GUARD RAIL
ITEM 547-A
STA. 119+95 TO 120+55 W.B. LT. & RT.
(OVERHEAD SIGN LOCATION)

GRANITE SLOPE EDGING
ITEM-556 A
RAMP 'D' BULLNOSE STA 23+94 LT.

THREE CABLE GUARD RAIL WITH
STEEL POSTS - ITEM 543
119+00
STA. 115+00 TO 117+50 W.B. LT.
RAMP 'C' STA. 14+96 TO 18+00 RT.
RAMP 'D' STA. 25+52 TO 29+00 RT. 24+49-28+00 RT.
RAMP 'D' STA. 26+50 TO 29+00 LT.
STA. 118+00 TO 119+60 E.B. RT.
12+25 - 122+49 W.B. LT.
124+00 - 124+56 W.B. LT.
121+40 - 121+97 E.B. RT.
123+41 - 123+65 E.B. RT.

* STAGE 2
316 CODE
PLANTING TREES, SHRUBS AND
VINES - ITEM 601
SEE SHADED AREAS AND
QUANTITY SHEET
BITUMINOUS CONCRETE CURB - ITEM 555

PAVED DITCH ITEM 361-B
STA. 118+73 TO 119+27 MED.
STA. 124+77 TO 125+02' MED.
STA. 129+02' TO 129+27' MED.
115+0-118+50 LT. W.B.
118+0 W.B. LT.
122+40 W.B. LT.
128+35-129+25 W.B. LT.
118+0-119+50 E.B. RT.
121+50-122+00 E.B. LT.
122+0 RT. E.B.
Ramp C 16+0-17+0 RT.
Ramp D 28+90-27+0 RT.
128+0-129+15 E.B. RT.

FED. ROAD DIV. No.	STATE	FEDERAL PROJECT No.	SHEET	TOTAL SHEETS
1	VERMONT	1-189-3(III)	14	210

PROPERTY LINE FENCE WITH STEEL POSTS
ITEM 583-B
STA. 117+00 TO 121+35 E.B. RT. - 465'
STA. 122+25 TO 131+00 E.B. RT. - 845'
STA. 123+55 TO 131+00 W.B. LT. - 750'
2060'

SHEET 13
CHAIN LINK FENCE (ALUMINUM)
ITEM 590-A
(6' HIGH)
STA. 6+43 TO 8+18 SHELburne RD. LT. - 266'
STA. 8+32 TO 10+75 SHELburne RD. LT. - 256'
STA. 95+77 TO 108+88 RAMP 'A' LT. - 1427'
STA. 29+00 TO 34+66 RAMP 'D' RT. - 518'
STA. 84+40 TO 15+00 RAMP 'C' RT. - 660'
3127'

PLAN	REVISIONS	DATE	BY
1	1		
2	2		
3	3		
4	4		
5	5		

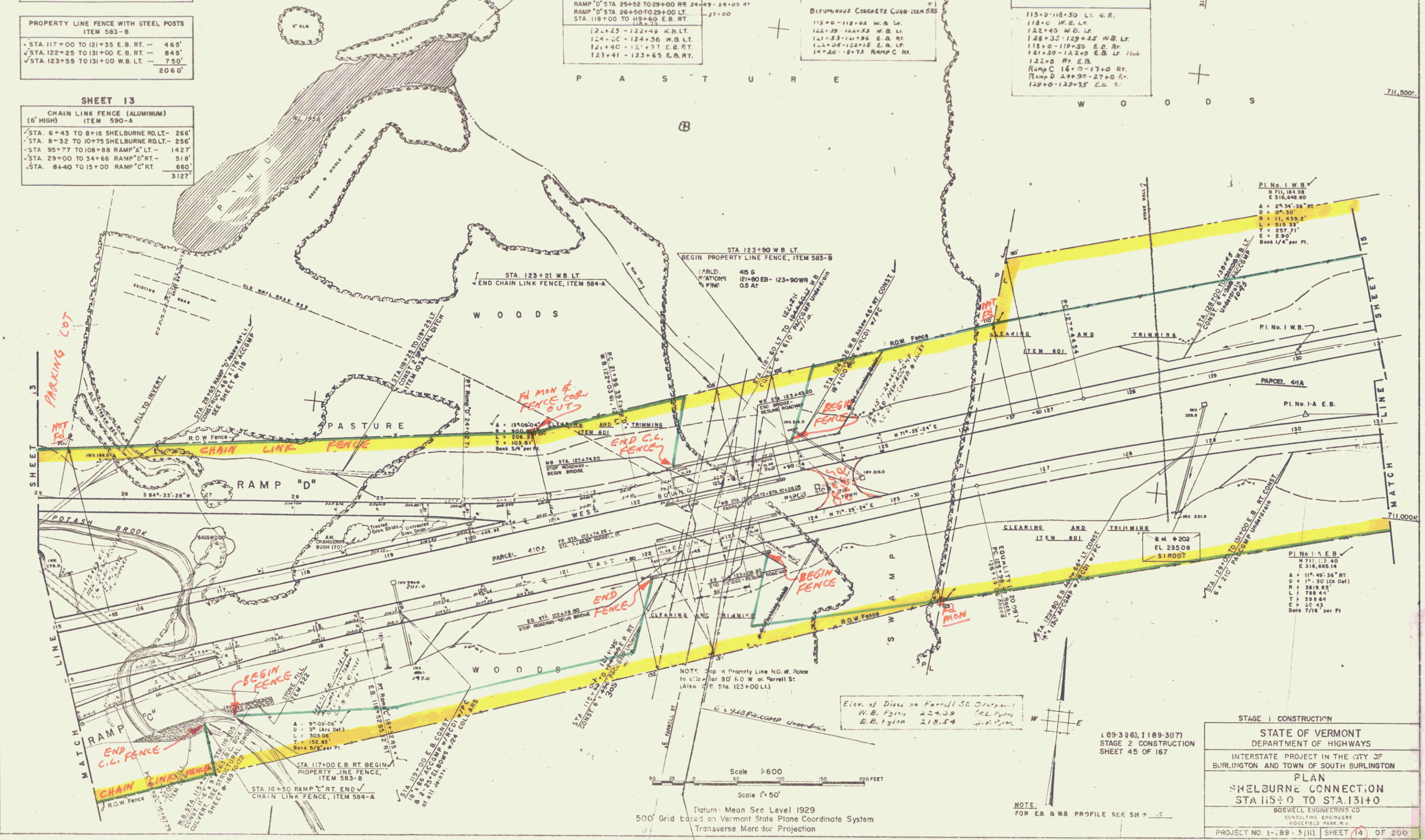

STAGE 1 CONSTRUCTION
STATE OF VERMONT
DEPARTMENT OF HIGHWAYS
INTERSTATE PROJECT IN THE CITY OF
BURLINGTON AND TOWN OF SOUTH BURLINGTON
PLAN
SHELburne CONNECTION
STA 115+0 TO STA 131+0
BOSTWELL ENGINEERING CO.
CONSULTING ENGINEERS
MIDDLEFIELD PARK, N.J.
PROJECT NO. 1-189-3(III) SHEET 14 OF 200

189-3(6), 1189-3(7)
STAGE 2 CONSTRUCTION
SHEET 45 OF 167

NOTE:
FOR E.B. & W.B. PROFILE SEE SH-1

Datum: Mean Sea Level 1929
500' Grid based on Vermont State Plane Coordinate System
Transverse Mercator Projection

111

PLAN	DESIGNED	BY	
	CHECKED		
	DATE		
	BY		
	DATE		
	BY		
	DATE		

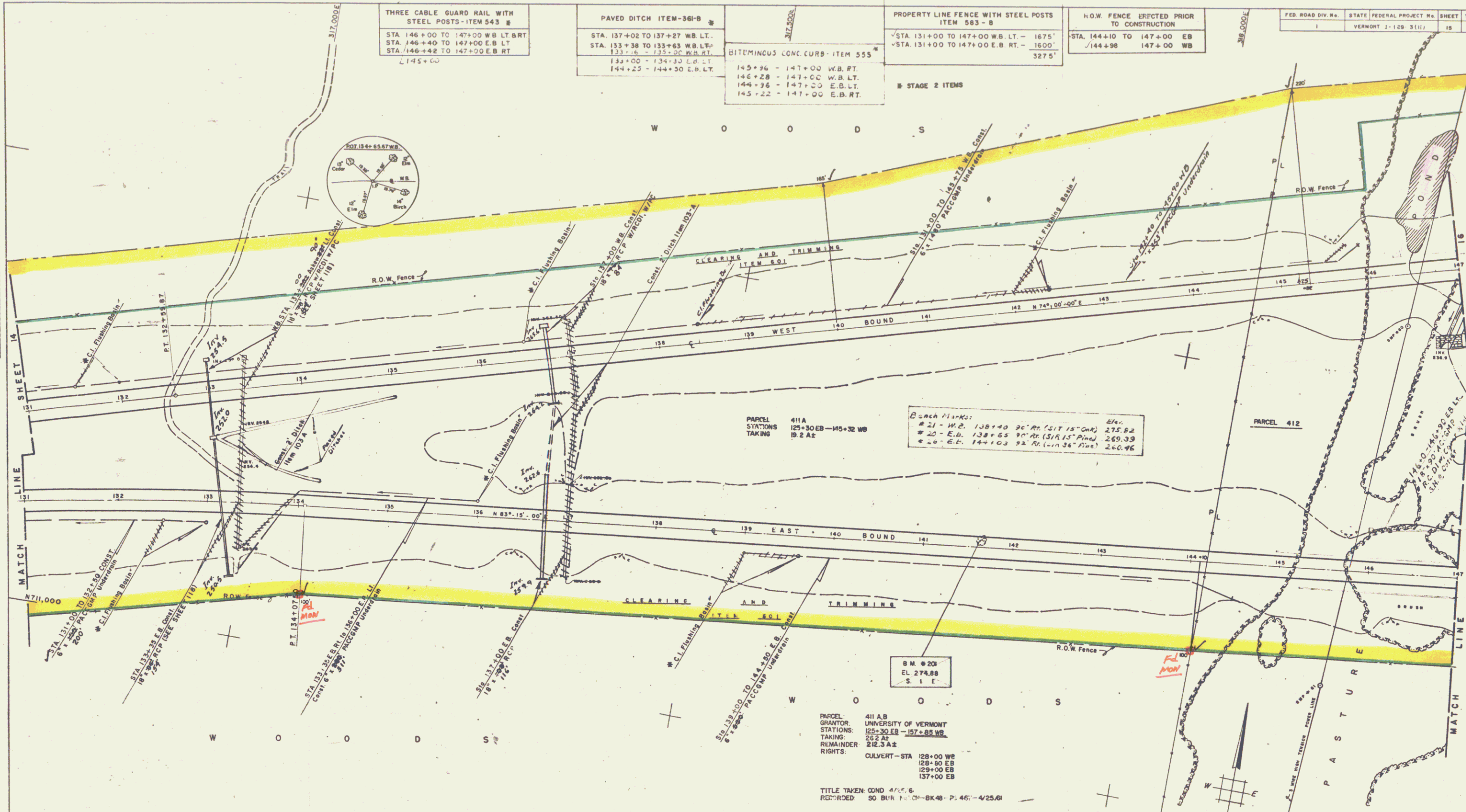

THREE CABLE GUARD RAIL WITH STEEL POSTS - ITEM 543 - B STA. 146+00 TO 147+00 WB LT. & RT. STA. 146+40 TO 147+00 E.B. LT. STA. 146+42 TO 147+00 E.B. RT. L145+00	PAVED DITCH ITEM-361-B STA. 137+02 TO 137+27 WB. LT. STA. 133+38 TO 133+63 WB. LT. 133+6 - 133+00 W.B. RT. 133+00 - 134+30 E.B. LT. 144+25 - 144+50 E.B. LT.	PROPERTY LINE FENCE WITH STEEL POSTS ITEM 583 - B STA. 131+00 TO 147+00 WB. LT. - 1675' STA. 131+00 TO 147+00 E.B. RT. - 1600' 3275'	H.O.W. FENCE ERECTED PRIOR TO CONSTRUCTION STA. 144+10 TO 147+00 EB /144+98 147+00 WB
--	--	--	--

FED. ROAD DIV. No.	STATE	FEDERAL PROJECT No.	SHEET	TOTAL SHEETS
1	VERMONT	2-128-3(11)	15	200

Corner Marks:	
# 21 - W.C. 138+40 90° Arc (1/2" Chk)	275.82
# 20 - E.B. 138+65 90° Arc (1/2" Chk)	269.39
# 20 - E.C. 144+03 92° Arc (1/2" Chk)	260.96

PARCEL 411A
 GRANTOR: UNIVERSITY OF VERMONT
 STATIONS: 125+30 EB - 137+85 WB
 TAKING: 212.3 A2
 REMAINDER: 212.3 A2
 RIGHTS: CULVERT - STA 128+00 WB
 129+50 EB
 129+00 EB
 137+00 EB

TITLE TAKEN COND. 4/27/66
 RECORDED: 50 BUR. P.O. BK48-P. 45-4/25/66

Scale 1"=50'
 Datum: Mean Sea Level 1929
 500' Grid based on Vermont State Plane Coordinate System
 Transverse Mercator Projection

189-3(16), 1189-3(7)
 STAGE 2 CONSTRUCTION
 SHEET 46 OF 167

STAGE 1 CONSTRUCTION
STATE OF VERMONT
 DEPARTMENT OF HIGHWAYS
 INTERSTATE PROJECT IN THE CITY OF
 BURLINGTON AND TOWN OF SOUTH BURLINGTON
PLAN
SHELBURNE CONNECTION
STA 131+0 TO STA 147+0
 BOSWELL ENGINEERING CO.
 CONSULTING ENGINEERS
 BOSTFIELD PARK, N.J.
 PROJECT NO. 1-189-3(11) SHEET 15 OF 200

I181 9

DATE	
BY	
REVISIONS	
1. CHECKED	
2. APPROVED	
3. FIELD	
4. AS BUILT	

FED. ROAD DIST. NO.	STATE	FEDERAL PROJECT NO.	SHEET	TOTAL SHEETS
1	VERMONT	1-89-3(4)	6	160

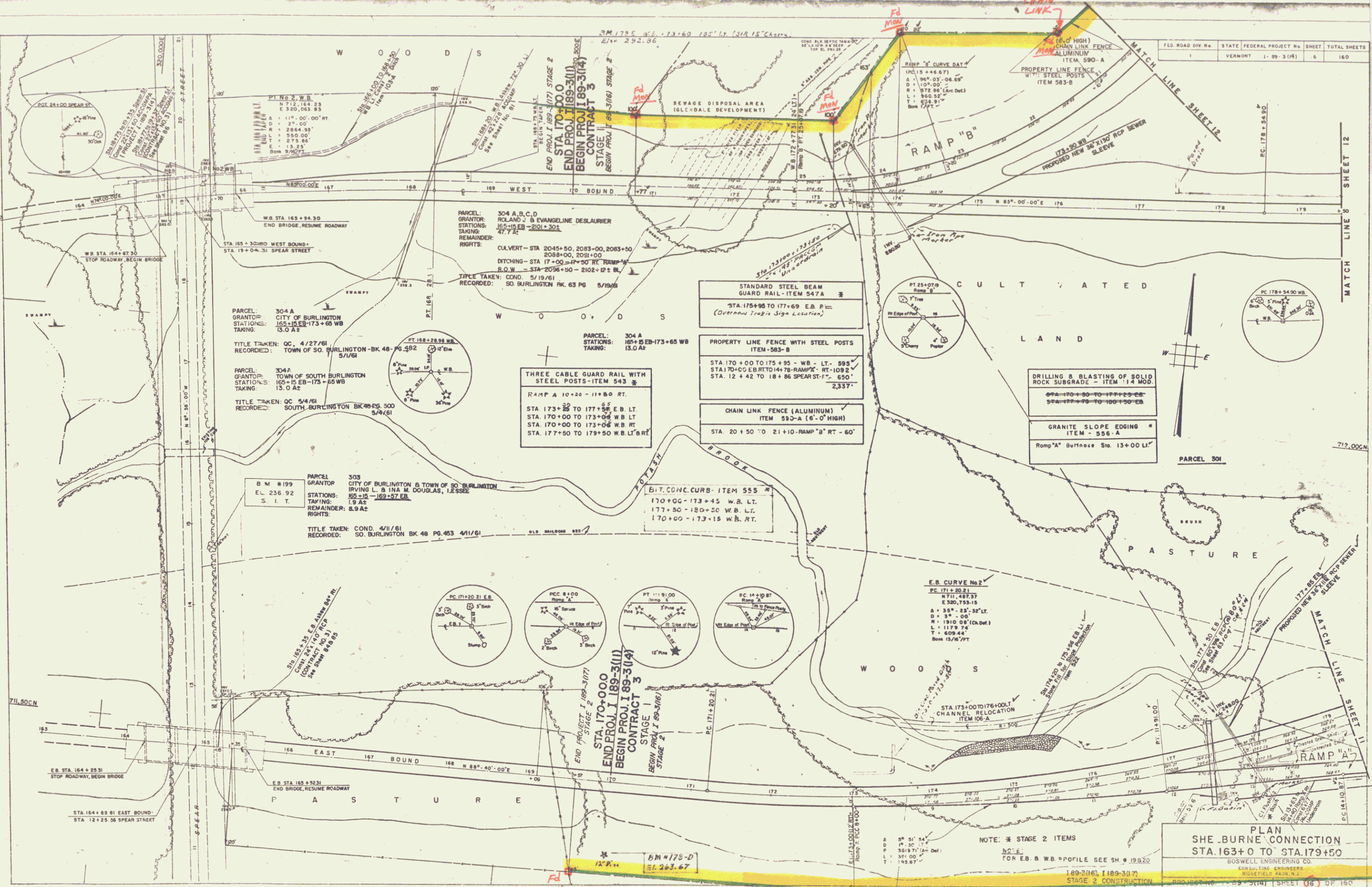

END PROJECT 1 (89-3171) STAGE 2
 STA. 170+00.0
 END PROJ. I 189-3(11)
 BEGIN PROJ. I 89-3(14)
 CONTRACT 3
 STAGE 1
 BEGIN PROJ. I 89-3(16) STAGE 2

PARCEL: 304 A, B, C, D
 GRANTOR: ROLAND J. & EMANUELE DESLAURIER
 STATIONS: 165+15 EB - 201+30 L
 TAKING: 47.7 AC
 REMAINDER:
 RIGHTS: CULVERT - STA 2045+50, 2083+00, 2083+00
 2088+00, 2091+00
 DITCHING - STA 17+00 - 17+50 RT RAMP "A"
 R.O.W. - STA 2056+50 - 2102+12 RT
 TITLE TAKEN: COND. 5/19/61
 RECORDED: SO. BURLINGTON BK. 63 PG. 61/61

PARCEL: 304 A
 GRANTOR: CITY OF BURLINGTON
 STATIONS: 165+15 EB - 173+65 WB
 TAKING: 13.0 AC

PARCEL: 304 A
 GRANTOR: TOWN OF SOUTH BURLINGTON
 STATIONS: 165+15 EB - 175+55 WB
 TAKING: 13.0 AC
 TITLE TAKEN: COND. 5/4/61
 RECORDED: SOUTH BURLINGTON BK. 63 PG. 500

PARCEL: 304 A
 STATIONS: 165+15 EB - 173+65 WB
 TAKING: 13.0 AC

THREE CABLE GUARD RAIL WITH
 STEEL POSTS - ITEM 543
 RAMP A 10+20 - 11+80 RT.
 STA. 173+85 TO 177+55 E.B. LT.
 STA. 170+00 TO 173+05 W.B. LT.
 STA. 170+00 TO 173+05 W.B. RT.
 STA. 177+50 TO 179+50 W.B. LT. & RT.

STANDARD STEEL BEAM
 GUARD RAIL - ITEM 547 A
 STA. 175+95 TO 177+65 E.B. RT.
 (Overhaul Traffic Sign Location)

PROPERTY LINE FENCE WITH STEEL POSTS
 ITEM - 583-B
 STA. 170+00 TO 175+95 W.B. LT. - 898'
 STA. 170+00 TO 175+95 W.B. RT. - 1092'
 STA. 12+42 TO 18+86 SPEAR ST. - 650'
 2,337'

CHAIN LINK FENCE (ALUMINUM)
 ITEM - 590-A (6'-0" HIGH)
 STA. 20+50 TO 21+10 RAMP "B" RT. - 60'

DRILLING & BLASTING OF SOLID
 ROCK SUBGRADE - ITEM 114 MOB
 STA. 170+00 TO 177+00 EB
 STA. 177+00 TO 180+00 EB

GRANITE SLOPE EDGING
 ITEM - 555-A
 Ramp "A" Surface Sta. 13+00 LI'

PARCEL: 303
 GRANTOR: CITY OF BURLINGTON & TOWN OF SOUTH BURLINGTON
 IRVING L. & INA M. DOUGLAS, LESSEES
 STATIONS: 162+15 - 169+57 EB
 TAKING: 1.9 AC
 REMAINDER: 8.9 AC
 RIGHTS:
 TITLE TAKEN: COND. 4/1/61
 RECORDED: SO. BURLINGTON BK. 48 PG. 453 4/1/61

BIT. CONC. CURB - ITEM 555
 170+00 - 173+45 W.B. LT.
 177+50 - 180+50 W.B. LT.
 170+00 - 173+15 W.B. RT.

E.B. CURVE No. 2
 PC (171+20.2)
 PVI (171+48.37)
 E (171+48.37)
 E 330.753-15
 A = 35° - 25' - 35" LT.
 D = 35' - 00"
 R = 1510.08' (Calc'd)
 L = 1179.74'
 T = 609.44'
 Bona 13.76'/PT

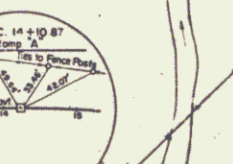
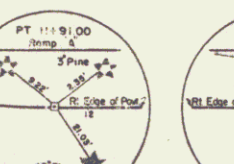
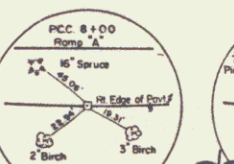
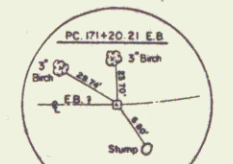

NOTE: * STAGE 2 ITEMS
 FOR E.B. & W.B. PROFILE SEE SH. 9 19820
 189-316, 189-317
 STAGE 2 CONSTRUCTION
 SHEET 38 OF 167

PLAN
 SHE. BURNE CONNECTION
 STA. 163+00 TO STA. 179+50
 BOSWELL ENGINEERS CO.
 CONSULTING ENGINEERS
 WINDFELDER PARK, N.Y.

BEGIN MAINT. AGREE. AREA NO. 2
SPEAR STREET (SA-7) 11+07 ζ (1156')

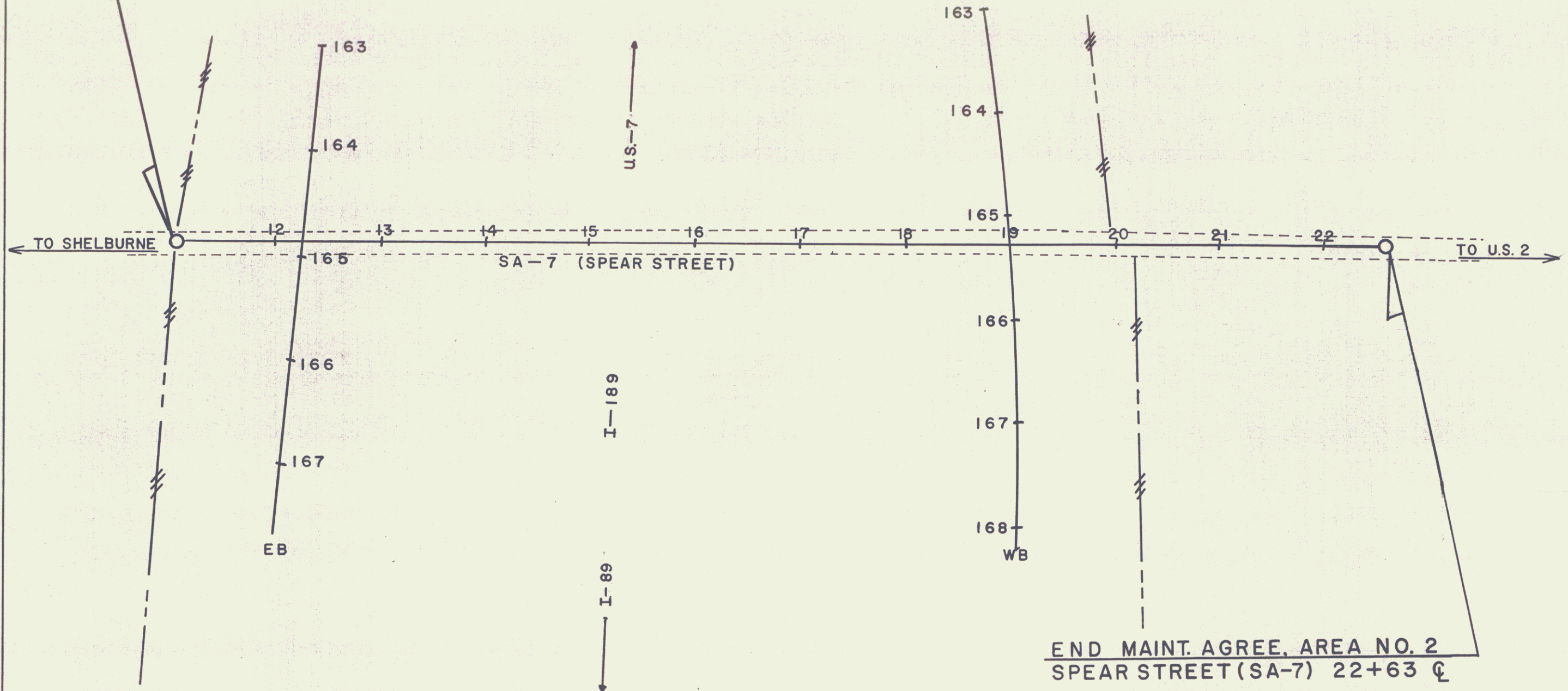
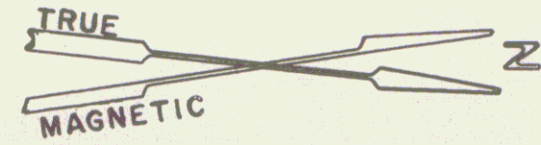

END MAINT. AGREE. AREA NO. 2
SPEAR STREET (SA-7) 22+63 ζ

AGREE. DATED 7-7-81
RECORDED IN BK. 176, PAGES 1-7

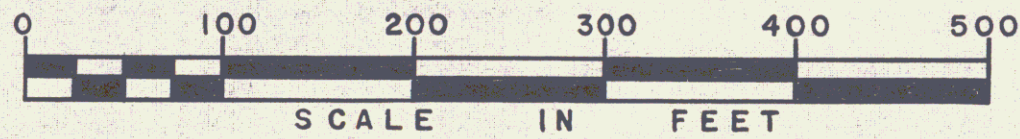

SHEET 116A

STATE OF VERMONT AGENCY OF TRANSPORTATION		
RELINQUISHMENT & MAINTENANCE PLATS CITY OF SOUTH BURLINGTON		
STATE AID ROAD NO. 7 PROJ. BURLINGTON-SO. BURLINGTON I-89-3(8)		
APPROX. SCALE 1"=100'	DATE 9/6/74	DRAWN BY JEH

PLAN	DATE
SUBMITTED	
REVISED	
BY	
DATE	
BY	
DATE	
BY	
DATE	

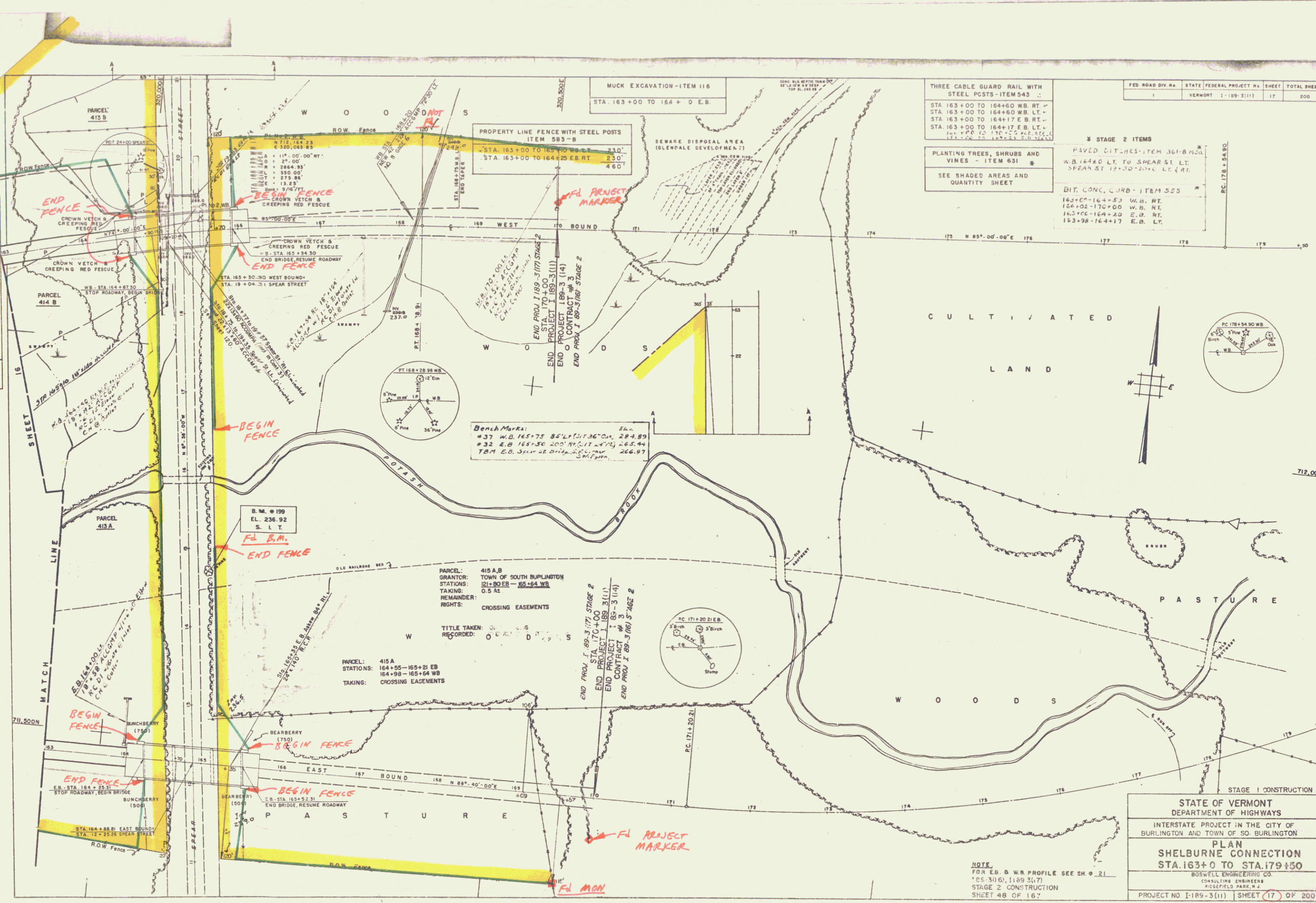

FED. ROAD DIV. NO.	STATE	FEDERAL PROJECT NO.	SHEET	TOTAL SHEETS
1	VERMONT	1-189-3(11)	17	200

THREE CABLE GUARD RAIL WITH STEEL POSTS - ITEM 543

STA. 163+00 TO 164+60 W.B. RT.
 STA. 163+00 TO 164+60 W.B. LT.
 STA. 163+00 TO 164+17 E.B. RT.
 STA. 163+00 TO 164+17 E.B. LT.
 STA. 163+00 TO 164+17 E.B. RT.
 STA. 163+00 TO 164+17 E.B. LT.

STAGE 2 ITEMS

PAVED DITCHES - ITEM 361-B MOD.
 W.B. 164+00 LT. TO SPEAR ST. LT.
 SPEAR ST. 12+30 TO 20+00 LT. E.B. RT.

BIT. CONC. CURB - ITEM 525

163+00-164+53 W.B. RT.
 163+02-170+00 W.B. RT.
 163+00-164+20 E.B. RT.
 153+26-164+17 E.B. LT.

Bench Marks:

#37 W.B. 165+75 85°14'01"36" ON 284.89
 #32 E.B. 165+50 200°10'17"17" 265.44
 TBM E.B. 165+50 200°10'17"17" 266.97

STATE OF VERMONT
 DEPARTMENT OF HIGHWAYS

INTERSTATE PROJECT IN THE CITY OF BURLINGTON AND TOWN OF SO. BURLINGTON

PLAN
 SHELburne CONNECTION
 STA. 163+00 TO STA. 179+50

BOSWELL ENGINEERING CO.
 CONSULTING ENGINEERS
 RIDGEFIELD PARK, N.J.

PROJECT NO. 1-189-3(11) SHEET 17 OF 200

NOTE:
 FOR E.B. & W.B. PROFILE SEE SH. 21
 105-3(16), 1189-3(17)
 STAGE 2 CONSTRUCTION
 SHEET 48 OF 167

LIST 13