

DATE	BY
PLAN	DESIGNED
REVISED	CHECKED
BY	BY
DATE	DATE
BY	BY
DATE	DATE

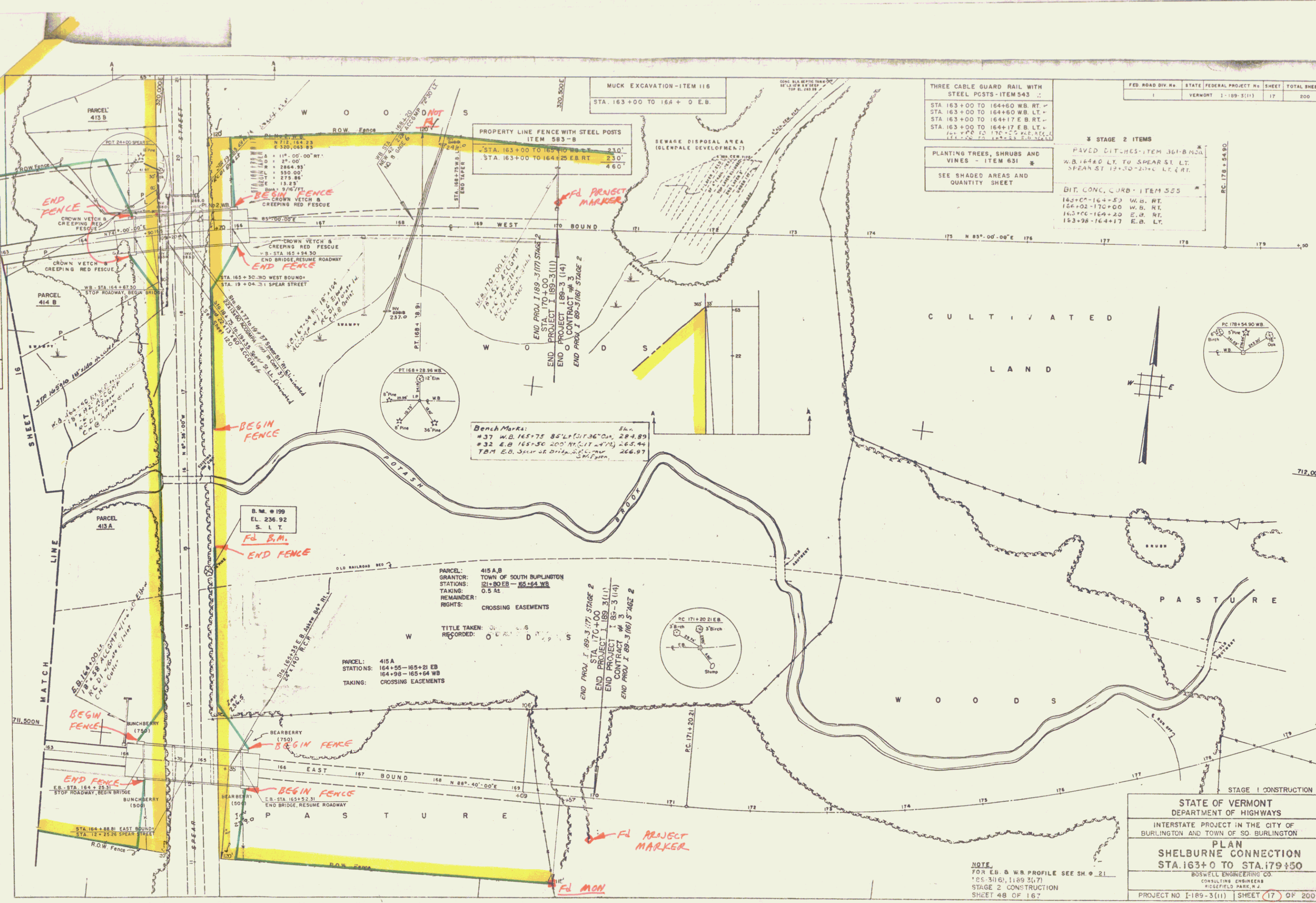

THREE CABLE GUARD RAIL WITH STEEL POSTS - ITEM 543-2
 STA. 163+00 TO 164+60 W.B. RT.
 STA. 163+00 TO 164+60 W.B. LT.
 STA. 163+00 TO 164+17 E.B. RT.
 STA. 163+00 TO 164+17 E.B. LT.
 STA. 163+00 TO 164+17 E.B. RT.
 STA. 163+00 TO 164+17 E.B. LT.

FED. ROAD DIV. NO.	STATE	FEDERAL PROJECT NO.	SHEET	TOTAL SHEETS
1	VERMONT	1-189-3(11)	17	200

STAGE 2 ITEMS
 PAVED DITCHES - ITEM 361-B MOD.
 W.B. 164+00 LT. TO SPEAR ST. LT.
 SPEAR ST. 12+30 TO 20+00 LT. & RT.
 BIT. CONC. CURB - ITEM 525
 163+00-164+50 W.B. RT.
 163+00-170+00 W.B. RT.
 163+00-164+20 E.B. RT.
 153+26-164+17 E.B. LT.

Bench Marks:
 #37 W.B. 165+75 85°14'01"36" ON 284.89
 #32 E.B. 165+50 200' N. (17°17'N) 265.44
 TBM E.B. 310+00 210' N. (17°17'N) 266.97

PARCEL: 415A
 STATIONS: 164+55-165+21 EB
 164+28-165+16 WB
 TAKING: CROSSING EASEMENTS

PARCEL: 415A,B
 GRANTOR: TOWN OF SOUTH BURLINGTON
 STATIONS: 161+80EB-165+54 WB
 0.5 AC
 REMAINDER:
 RIGHTS: CROSSING EASEMENTS

TITLE TAKEN: O.E. 21-1-6
 RECORDED: O.E. 21-1-6
 END PROJ. I 89-3 (17) STAGE 2
 END PROJ. I 70+00
 END PROJ. I 89-3 (11)
 CONTRACT # 3
 END PROJ. I 89-3 (14)
 CONTRACT # 3
 END PROJ. I 89-3 (16) STAGE 2

STATE OF VERMONT
 DEPARTMENT OF HIGHWAYS
 INTERSTATE PROJECT IN THE CITY OF
 BURLINGTON AND TOWN OF SO. BURLINGTON
 PLAN
 SHELburne CONNECTION
 STA. 163+00 TO STA. 179+50
 BOSWELL ENGINEERING CO.
 CONSULTING ENGINEERS
 RIDGEFIELD PARK, N.J.
 PROJECT NO. 1-189-3(11) SHEET 17 OF 200

NOTE:
 FOR E.B. & W.B. PROFILE SEE SH. # 21
 105-3(16), 1189-3(17)
 STAGE 2 CONSTRUCTION
 SHEET 48 OF 167

LIST 13