

BLDG. NO.	STATION	POS.
33	1128+00	RT
34	1128+45 (US-2)	RT
35	1131+50	RT
36	1131+85	RT

PROPERLY LINE FENCE ITEM 983 - B (MOD)			
LOCA.	STA.	STA.	POS.
RT LANE	1124+00	1129+75	RT.
LT LANE			

MUCK EXCAVATION ITEM 116			
LOCA.	STA.	STA.	POS.
	1129+50	1136+50	

THREE CABLE GUARD RAIL WITH STEEL POSTS ITEM 543			
LOCA.	STA.	STA.	POS.
LT LANE	1124+00	1140+00	LT.
RT LANE	1124+00	1126+75	RT.
US-2	1129+70	1133+58	LT.
"	1134+11	1140+00	LT.

DRILLING & BLASTING OF SOLID ROCK SUB GRADE ITEM 114 (MOD)			
LOCA.	STA.	STA.	POS.
	1135+00	1134+50	
	1135+50	1136+50	
US-2	1129+00	1132+00	
"	1132+00	1136+50	
"	1136+50	1138+50	
"	1138+50	1139+50	

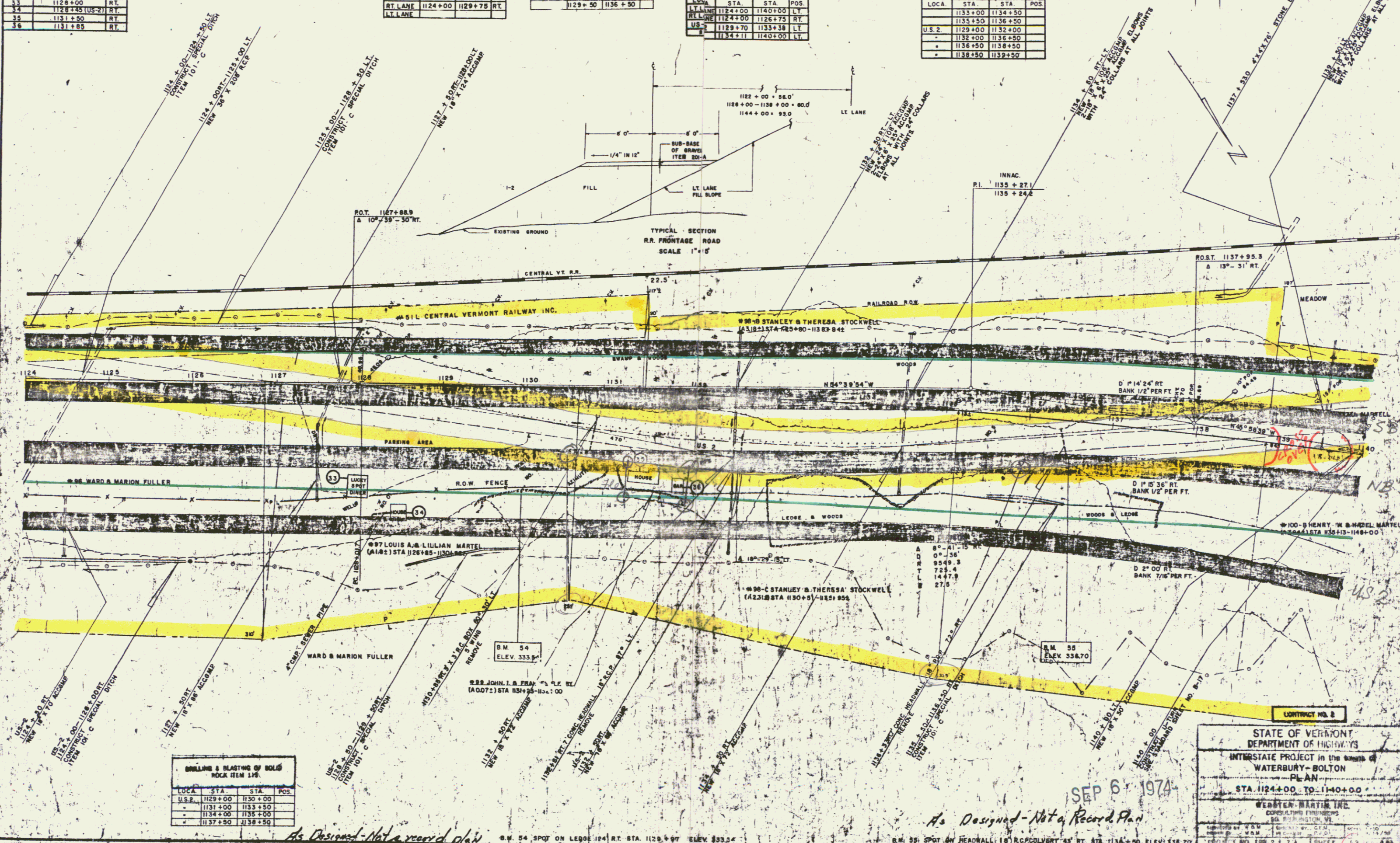

DRILLING & BLASTING OF SOLID ROCK ITEM 114			
LOCA.	STA.	STA.	POS.
U.S. 2	1129+00	1130+00	
"	1131+00	1133+50	
"	1134+00	1135+00	
"	1137+50	1138+50	

STATE OF VERMONT
DEPARTMENT OF HIGHWAYS
INTERSTATE PROJECT in the town of
WATERBURY - BOLTON
PLAN
STA. 1124+00 TO 1140+00
WESTERN MARTIN INC.
CONSULTING ENGINEERS
50 BARRINGTON, VT
PROJECT NO. 109 2 1 7 1 SHEET 53 OF 58

SEP 6 1974

As Designed - Not a Record Plan

63

24