

CONSTRUCT DRIVE			
LOCA	STA	STA	POS
1076+00			RT

SOD REMOVAL ITEM 101			
LOCA	STA	STA	POS
1076+50	1081+50		

THREE CABLE GUARD RAIL WITH STEEL POSTS ITEM 543			
LOCA	STA	STA	POS
1082+24			LT
1083+72			LT
1076+00	1084+22		RT
1082+25	1082+72		RT
1083+73	1083+23		RT
1087+80	1088+28		LT
1090+79	1091+78		LT

DRILLING & BLASTING OF SOLID ROCK 5:10 GRADE ITEM 114 (MOD)			
LOCA	STA	STA	POS
1088+35			RT
1088+25	1091+50		
1091+50	1092+00		

PROPERTY LINE FENCE ITEM 503-B (MOD.) W/ STEEL POSTS			
LOCA	STA	STA	POS
1076+00	1092+00		RT
1076+00	1092+00		LT

EXCAVATION & REMOVAL OF ROAD SURFACE ON ROADWAYS ITEM 118-A			
LOCA	STA	STA	POS
1088+00			LT

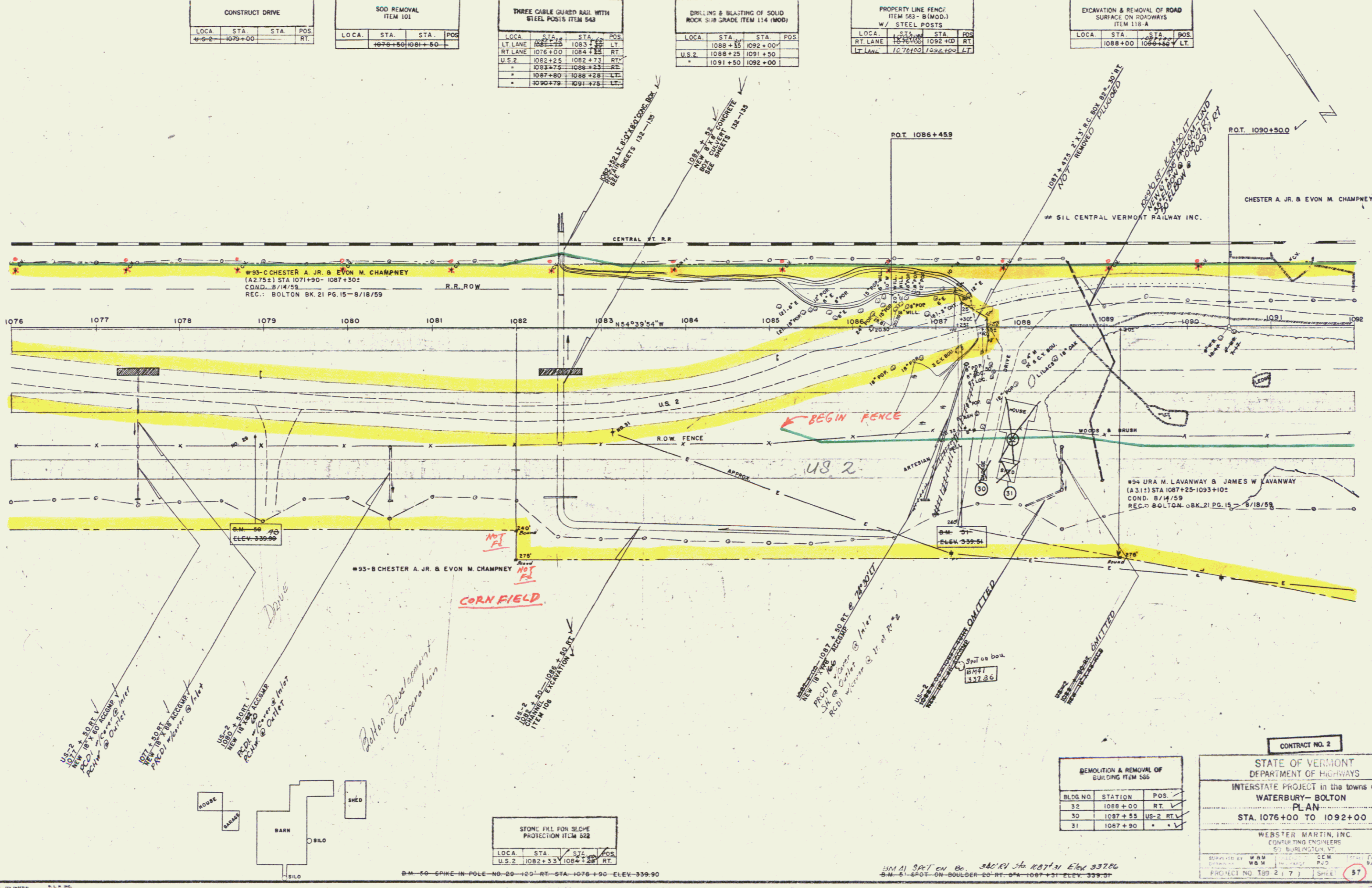

REMEDIATION & REMOVAL OF BUILDING ITEM 566		
BLDG NO.	STATION	POS.
32	1088+00	RT
30	1087+55	US-2 RT
31	1087+90	US-2 RT

CONTRACT NO. 2

STATE OF VERMONT  
DEPARTMENT OF HIGHWAYS

INTERSTATE PROJECT in the towns of  
WATERBURY-BOLTON

PLAN  
STA. 1076+00 TO 1092+00

WEBSTER MARTIN, INC.  
CONSULTING ENGINEERS  
51 BURLINGTON VT.

DESIGNED BY W.M. P.J. 5/14/59  
CHECKED BY W.M. P.J. 5/14/59  
PROJECT NO. 199 2 (7) SHEET 57 295