

REMOVAL OF EXISTING PAVEMENT ITEM 101-C				PROPERTY LINE FENCE ITEM 503-B (WOOD) W/ STEEL POSTS			
LOCA	STA	STA	POS	LOCA	STA	STA	POS
1028+00	1029+00			1028+00	1044+00		LT

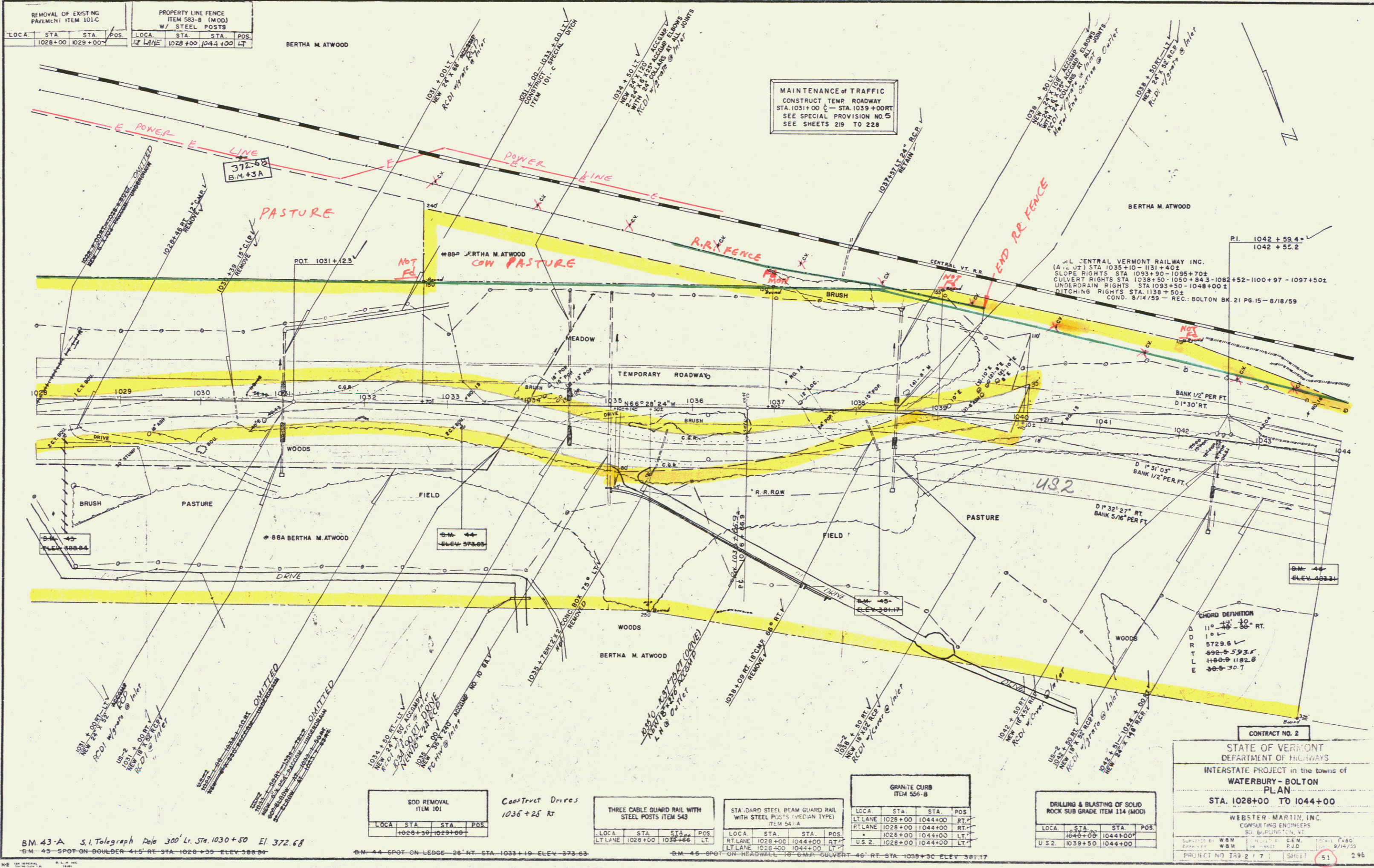

MAINTENANCE OF TRAFFIC
CONSTRUCT TEMP ROADWAY
STA. 1031+00 C - STA. 1039+00 RT
SEE SPECIAL PROVISION NO. 5
SEE SHEETS 219 TO 228

J.L. CENTRAL VERMONT RAILWAY INC.
(A.L. 02) STA. 1035+10 - 1131+40±
SLOPE RIGHTS STA. 1035+50 - 1095+70±
CULVERT RIGHTS STA. 1038+50 - 1050+84.3 - 1082+52 - 1100+97 - 1097+50±
UNDERPAIN RIGHTS STA. 1033+50 - 1048+00±
DITCHING RIGHTS STA. 1138+50±
COND. 8/14/59 - REC. BOLTON BK 21 PG. 15 - 8/18/59

CONTRACT NO. 2
STATE OF VERMONT
DEPARTMENT OF HIGHWAYS
INTERSTATE PROJECT in the town of
WATERBURY - BOLTON
PLAN
STA. 1028+00 TO 1044+00

WEBSTER MARTIN, INC.
CONSULTING ENGINEERS
50 BURLINGTON, VT

DATE: 8/14/59
PROJECT NO. 133 2 1 7 1 SHEET 51 296

SOD REMOVAL ITEM 101			
LOCA	STA	STA	POS
1028+30	1029+00		

Construct Drives
1035+25 RT

THREE CABLE GUARD RAIL WITH STEEL POSTS ITEM 543			
LOCA	STA	STA	POS
1028+00	1028+00	1044+00	LT

STANDARD STEEL BEAM GUARD RAIL WITH STEEL POSTS (MEDIAN TYPE) ITEM 541-A			
LOCA	STA	STA	POS
1028+00	1028+00	1044+00	RT
1028+00	1028+00	1044+00	LT
U.S. 2	1028+00	1044+00	LT

GRANITE CURB ITEM 556-B			
LOCA	STA	STA	POS
1028+00	1028+00	1044+00	RT
1028+00	1028+00	1044+00	LT
U.S. 2	1028+00	1044+00	LT

DRILLING & BLASTING OF SOLID ROCK SUB GRADE ITEM 114 (MOD)			
LOCA	STA	STA	POS
1040+00	1040+00	1044+00	RT
U.S. 2	1039+50	1044+00	

BM 43-A S.I. Telegraph Pole 300' Lt. Sta. 1030+50 El. 372.68
BM 43 - SPOT ON BOULDER 415 RT STA. 1028+35 ELEV. 388.84

BM 44 - SPOT ON LEDGE 26 RT STA. 1033+19 ELEV. 373.83

BM 45 - SPOT ON HEADWALL 18 CMT. CULVERT 40 RT STA. 1035+30 ELEV. 381.17