

BLDG. NO.	STATION	POS.	LOCA.	STA.	STA.	POS.
16	887+43	LT.	RT LANE	887+00	891+40	LT.
DEMOLITION AND REMOVAL OF BLDG. ITEM 592						
			RT LANE	899+82	900+00	RT.
			LT Lane	883+12	893+72	LT.

THREE CABLE GUARD RAIL WITH STEEL POSTS ITEM 543

TOPSOIL & SEEDING ITEMS 621 & 611			
REST AREA			
LOCA.	STA.	STA.	POS.
✓	889+58	893+92	RT.

PROPERTY LINE FENCE ITEM 583-B (MOD) W/ STEEL POSTS			
LOCA.	STA.	STA.	POS.
✓	884+00	900+00	RT.
✓	884+00	900+00	LT.

STONE FILL FOR SLOPE PROTECTION 893+22 RT. & LT.

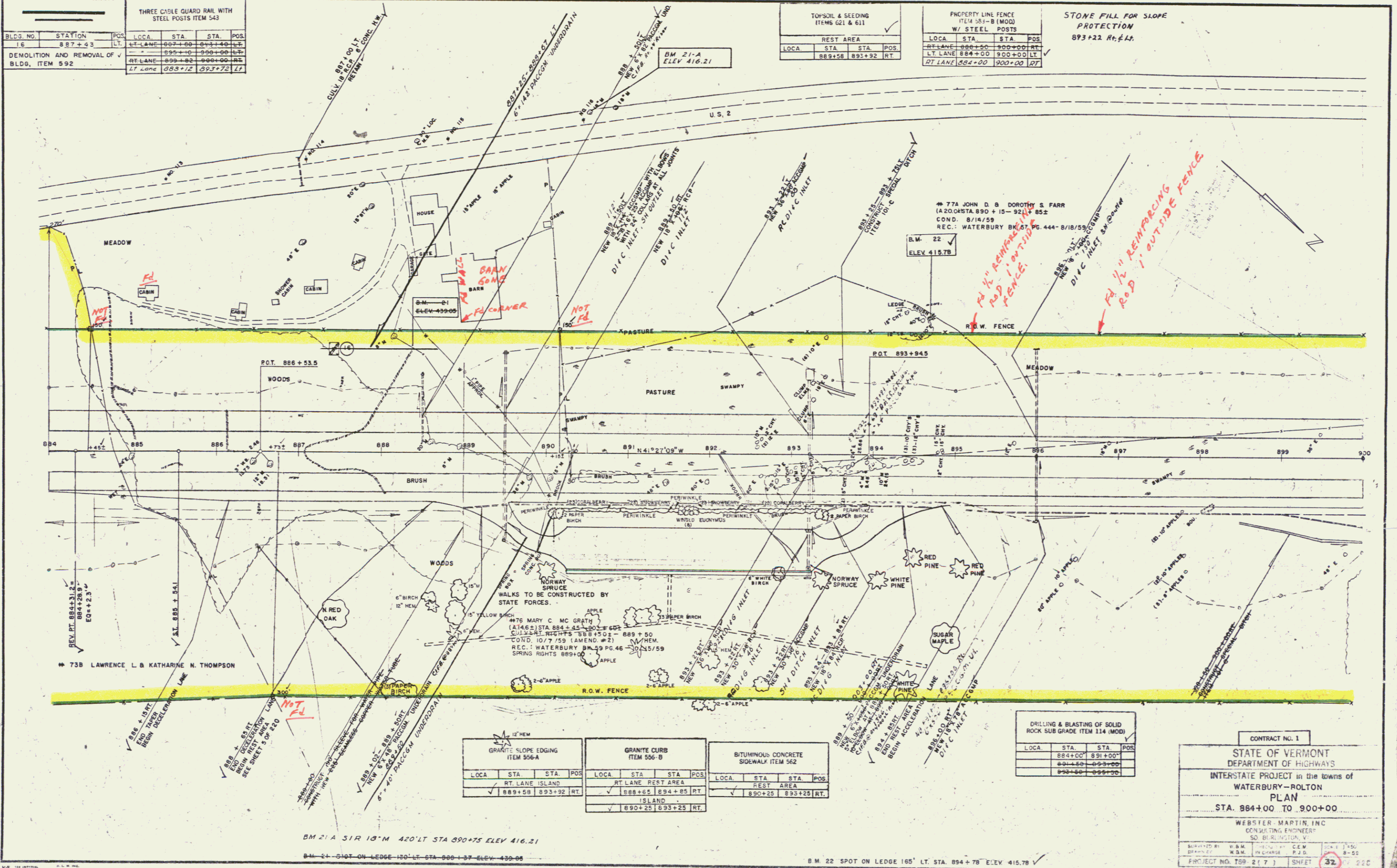

GRANITE SLOPE EDGING ITEM 556-A			
LOCA.	STA.	STA.	POS.
✓	889+58	893+92	RT.

GRANITE CURBS ITEM 556-B			
LOCA.	STA.	STA.	POS.
✓	889+58	894+85	RT.
✓	890+25	893+25	RT.

BITUMINOUS CONCRETE SIDEWALK ITEM 562			
LOCA.	STA.	STA.	POS.
✓	890+25	893+25	RT.

DRILLING & BLASTING OF SOLID ROCK SUBGRADE ITEM 114 (MOD)			
LOCA.	STA.	STA.	POS.
✓	884+00	891+00	
✓	891+50	893+00	
✓	893+50	895+00	

CONTRACT NO. 1

STATE OF VERMONT  
DEPARTMENT OF HIGHWAYS

INTERSTATE PROJECT in the towns of  
WATERBURY-ROLTON

PLAN  
STA. 884+00 TO 900+00

WEBSTER MARTIN, INC.  
CONSULTING ENGINEER  
50 BRISTOL ST.  
WATERBURY, VT.

DESIGNED BY: W.M. CHECKED BY: C.E.W. DATE: 1/50  
DRAWN BY: W.M. IN CHARGE: P.J.D. SCALE: 8-50  
PROJECT NO. 199-217-1 SHEET 32 OF 220

BM 21-A 51' 10" N 420' LT STA 890+75 ELEV 416.21

BM 21-A SPOT ON LEDGE 120' LT STA 888+37 ELEV 439.08

BM 22 SPOT ON LEDGE 165' LT STA. 894+78 ELEV 415.78