

THREE CABLE GUARD RAIL W/STEEL POSTS  
 732+40 Left 740+40 Right 739+30  
 731+70 to 741+10 737+70 to 740+60

PROPERTY LINE FENCE W/STEEL POSTS  
 Left Right  
 730+00 to 744+00 730+00 to 744+00

DEMOLITION AND REMOVAL OF BUILDING  
 STA. 737+70 LT. NO. 3

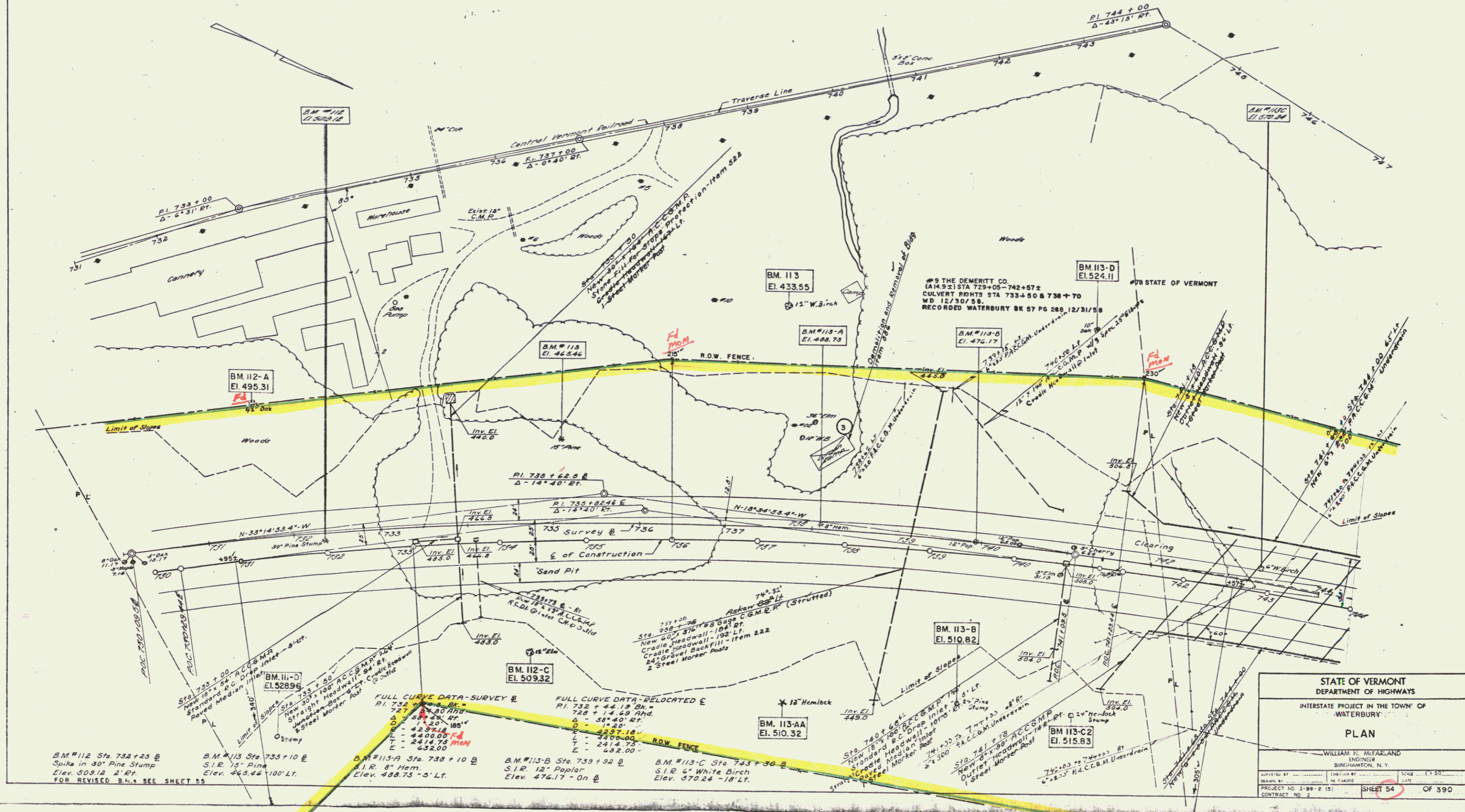

B.M. #112 Sta. 732+25 @  
 Spike in 30" Pine Stump  
 Elev. 309.12 ± Rt.  
 FOR REVISED B.M., SEE SHEET 55

B.M. #113 Sta. 735+10 @  
 S.I.R. 12" Pine  
 Elev. 463.46 ± 100' Lt.

FULL CURVE DATA - SURVEY @  
 P.I. 732+44.19  
 Δ = 58° 20' 18"  
 D = 112.00  
 L = 42.37  
 T = 24.14  
 E = 23.20

FULL CURVE DATA - RELOCATED @  
 P.I. 732+44.19  
 Δ = 58° 20' 18"  
 D = 112.00  
 L = 42.37  
 T = 24.14  
 E = 23.20

B.M. #113-A Sta. 738+10 @  
 S.I.R. 8" Hemlock  
 Elev. 488.75 ± 5' Lt.

B.M. #113-B Sta. 733+32 @  
 S.I.R. 12" Poplar  
 Elev. 476.17 ± On @

B.M. #113-C Sta. 743+30 @  
 S.I.R. 6" White Birch  
 Elev. 370.24 ± 18' Lt.

STATE OF VERMONT DEPARTMENT OF HIGHWAYS			
INTERSTATE PROJECT IN THE TOWN OF WATERBURY			
PLAN			
WILLIAM H. McFARLAND ENGINEER BINGHAMTON, N.Y.			
SUPPLIED BY	CHECKED BY	SCALE	1" = 50'
DRAWN BY	IN CHARGE	DATE	
PROJECT NO. 2-88-2 (S)		SHEET 54	OF 390
CONTRACT NO. 2			

Fd 1 1/2" IRON PIPE IN FENCE  
 Fd 1 1/2" IRON PIPE IN FENCE  
 Fd 1 1/2" IRON PIPE IN FENCE