

THREE CABLE GUARD RAIL W/STEEL POSTS
 Left 446+00 to 460+00 Right 451+80
 446+58 to 450+00
 450+00 to 460+00
 657+50

PROPERTY LINE FENCE W/STEEL POSTS
 Left 446+00 to 460+00 Right 451+80
 446+00 to 450+00
 450+00 to 460+00
 652+50 to

LANDSCAPE MATERIAL
 TREES
 657+25 RT. 2' E. RED CEDAR (1)
 659+50 RT. 2' E. RED CEDAR (1)

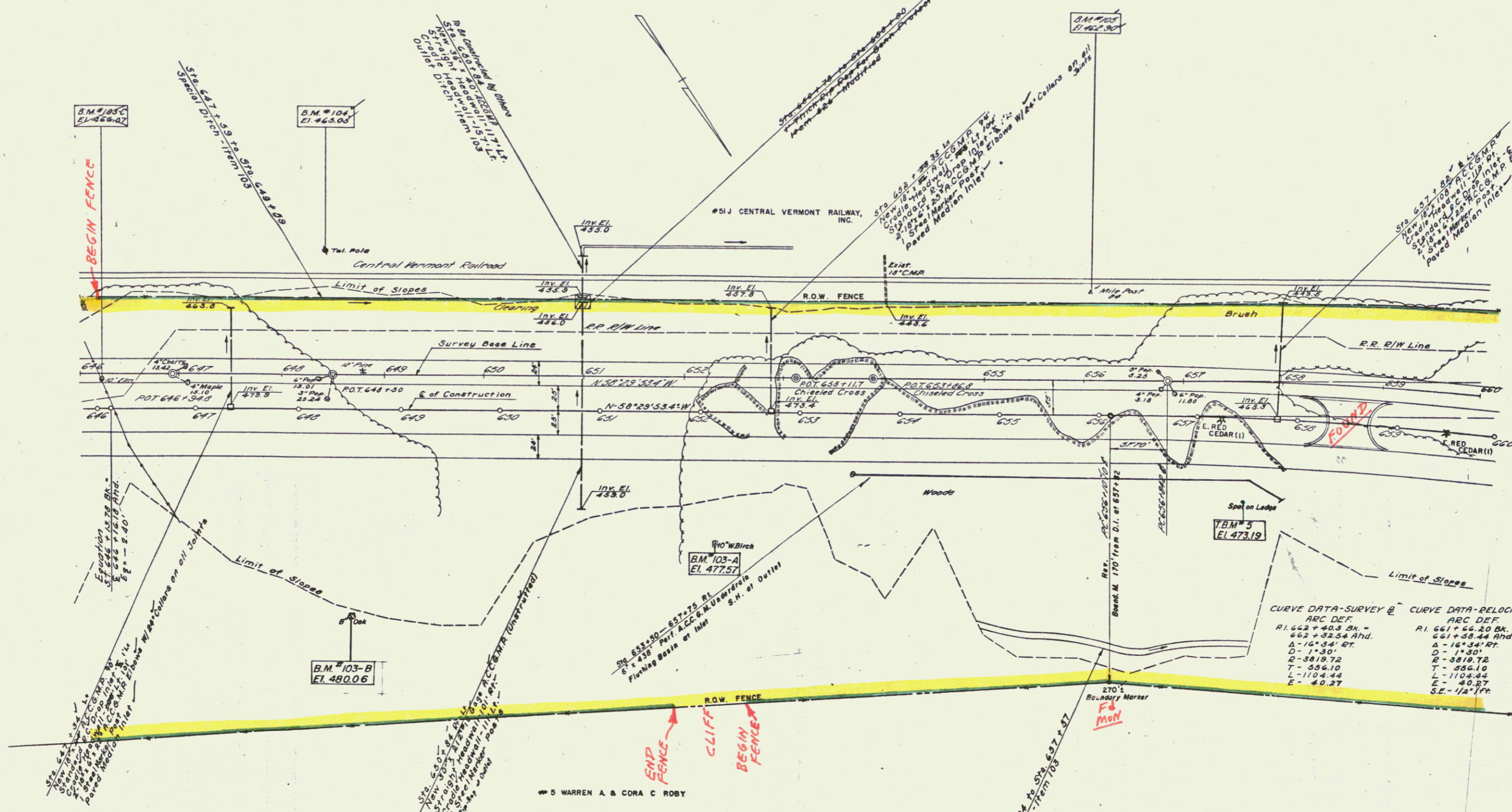

CURVE DATA-SURVEY @	CURVE DATA-RELOCATED @
ARC DEF.	ARC DEF.
R1 653+40.3 BK =	R1 661+66.20 BK =
402+32.54 Rhd.	651+58.44 Rhd.
Δ - 16°34' RT	Δ - 16°34' RT
D - 1°30'	D - 1°30'
Q - 3818.72	Q - 3818.72
T - 556.10	T - 556.10
L - 1104.44	L - 1104.44
E - 40.27	E - 40.27
	SE - 1/2" 1/4"

B.M. #103-C Sta. 446+21 @
 S.I.R. - 10' Elm
 Elev. 468.07 - 468.07

B.M. #104 Sta. 443+43 @
 Spike in Tel. Pole
 Elev. 463.05 - 463.05 Lt.
 156

B.M. #105 Sta. 656+00 @
 Mile Post 84
 Elev. 462.90 - 83' Lt.

B.M. #103-A S.I.T. 10' W. Birch 134' Rt. Sta. 652+15 Elev. 477.57
 T.B.M.'s S.O.L. 8" Rt. Sta. 657+50 Elev. 473.19

B.M. #103-B S.I.T. 8" Oak 253' Rt. Sta. 648+53 Elev. 480.06

STATE OF VERMONT
 DEPARTMENT OF HIGHWAYS
 INTERSTATE PROJECT IN THE TOWNS OF
 MIDDLESEX - WATERBURY
 PLAN

W. LIAM H. McFARLAND
 ENGINEER
 BINGHAMTON, N.Y.

SURVEYED BY: _____ CHECKED BY: _____ SCALE: 1"=50'
 DRAWN BY: _____ IN CHARGE: _____ DATE: _____
 CONTRACT NO. _____ SHEET 42 OF 315