

LANDSCAPE MATERIAL
TREES
598+85 RT. 130' W. BIRCH (1)
599+00 RT. 115' W. BIRCH (1)
599+40 RT. 110' W. BIRCH (1)

THREE CABLE GUARD RAIL w/ STEEL POSTS
Left 590+00 to 595+50
Right 601+00 to 604+00
601+00 to 604+00

PROPERTY LINE FENCE w/ STEEL POSTS
Left 593+00
Right 590+00 to 604+00
597+00 to 604+00

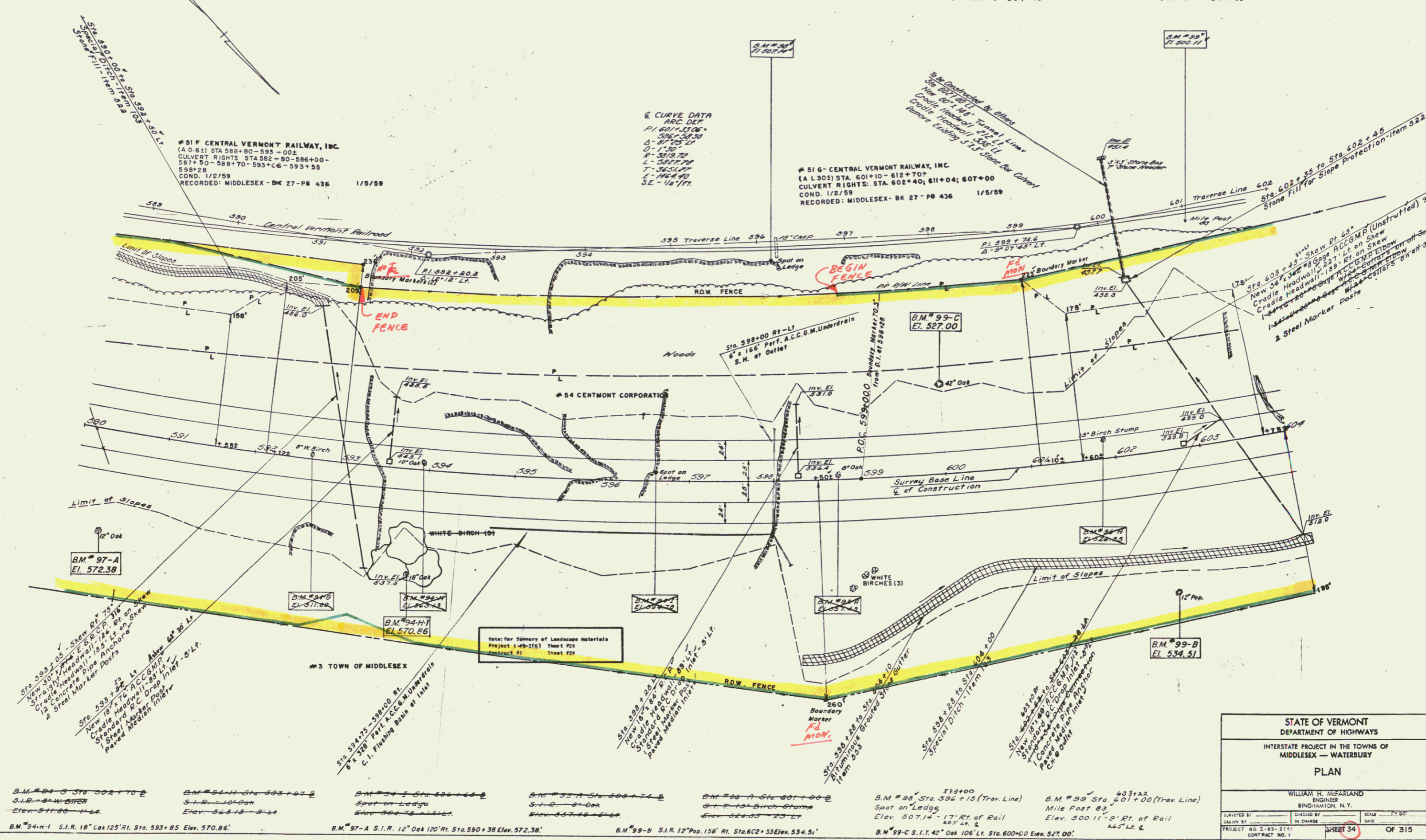

51 F CENTRAL VERMONT RAILWAY, INC.
(A.O. 62) STA 588+80-593+00
CULVERT RIGHTS STA 582-80-586+00-
587+50-588+70-593+00-593+55
598+28
COND. 1/2/59
RECORDED: MIDDLESEX - BK 27 - PG 436 1/5/59

Q CURVE DATA
ARC DEF
P.I. 601+51.0
336+34.0
D=110
R=350.72
L=362.70
T=363.47
E=106.40
SE=1/4" PT.

51 G CENTRAL VERMONT RAILWAY, INC.
(A.I. 305) STA 601+10-612+70
CULVERT RIGHTS: STA. 602+40; 611+04; 607+00
COND. 1/2/59
RECORDED: MIDDLESEX - BK 27 - PG 436 1/5/59

Sta. 593+05 - Skew Pt. 73.1
New 30' x 12' x 18" ACCOMP.
Culvert, 12' x 12' x 18" on Skew
12' x 12' x 18" Anchored
2 Steel Marker Posts
Sta. 593+22 - L4
New 10' x 7' ACCOMP.
Culvert, 10' x 7' x 18" on Skew
Standard R.C. Pipe
1 Steel Marker Post
1 Paved Median Inlet

Note: For Summary of Landscape Materials
Project 149-1(5) Sheet #21
Project #1 Sheet #21

STATE OF VERMONT DEPARTMENT OF HIGHWAYS	
INTERSTATE PROJECT IN THE TOWNS OF MIDDLESEX - WATERBURY	
PLAN	
WILLIAM H. McFARLAND ENGINEER BINGHAMTON, N.Y.	
DESIGNED BY	SCALE 1" = 50'
DRAWN BY	DATE
CHECKED BY	IN CHARGE
PROJECT NO. I-89-211	SHEET 34
CONTRACT NO. 1	OF 315

- B.M. #94-C Sta. 592+70.0 S.I.R. - 8" W. BIRCH Elev. 571.80 - 1.44
- B.M. #94-H-1 S.I.R. 18" x 12" 125' Rt. Sta. 593+85 Elev. 570.86
- B.M. #94-H-2 S.I.R. 18" x 12" 125' Rt. Sta. 593+85 Elev. 570.86
- B.M. #94-H-3 S.I.R. 18" x 12" 125' Rt. Sta. 593+85 Elev. 570.86
- B.M. #94-H-4 S.I.R. 18" x 12" 125' Rt. Sta. 593+85 Elev. 570.86
- B.M. #94-H-5 S.I.R. 18" x 12" 125' Rt. Sta. 593+85 Elev. 570.86
- B.M. #94-H-6 S.I.R. 18" x 12" 125' Rt. Sta. 593+85 Elev. 570.86
- B.M. #94-H-7 S.I.R. 18" x 12" 125' Rt. Sta. 593+85 Elev. 570.86
- B.M. #94-H-8 S.I.R. 18" x 12" 125' Rt. Sta. 593+85 Elev. 570.86
- B.M. #94-H-9 S.I.R. 18" x 12" 125' Rt. Sta. 593+85 Elev. 570.86
- B.M. #94-H-10 S.I.R. 18" x 12" 125' Rt. Sta. 593+85 Elev. 570.86
- B.M. #94-H-11 S.I.R. 18" x 12" 125' Rt. Sta. 593+85 Elev. 570.86
- B.M. #94-H-12 S.I.R. 18" x 12" 125' Rt. Sta. 593+85 Elev. 570.86
- B.M. #94-H-13 S.I.R. 18" x 12" 125' Rt. Sta. 593+85 Elev. 570.86
- B.M. #94-H-14 S.I.R. 18" x 12" 125' Rt. Sta. 593+85 Elev. 570.86
- B.M. #94-H-15 S.I.R. 18" x 12" 125' Rt. Sta. 593+85 Elev. 570.86
- B.M. #94-H-16 S.I.R. 18" x 12" 125' Rt. Sta. 593+85 Elev. 570.86
- B.M. #94-H-17 S.I.R. 18" x 12" 125' Rt. Sta. 593+85 Elev. 570.86
- B.M. #94-H-18 S.I.R. 18" x 12" 125' Rt. Sta. 593+85 Elev. 570.86
- B.M. #94-H-19 S.I.R. 18" x 12" 125' Rt. Sta. 593+85 Elev. 570.86
- B.M. #94-H-20 S.I.R. 18" x 12" 125' Rt. Sta. 593+85 Elev. 570.86
- B.M. #94-H-21 S.I.R. 18" x 12" 125' Rt. Sta. 593+85 Elev. 570.86
- B.M. #94-H-22 S.I.R. 18" x 12" 125' Rt. Sta. 593+85 Elev. 570.86
- B.M. #94-H-23 S.I.R. 18" x 12" 125' Rt. Sta. 593+85 Elev. 570.86
- B.M. #94-H-24 S.I.R. 18" x 12" 125' Rt. Sta. 593+85 Elev. 570.86
- B.M. #94-H-25 S.I.R. 18" x 12" 125' Rt. Sta. 593+85 Elev. 570.86
- B.M. #94-H-26 S.I.R. 18" x 12" 125' Rt. Sta. 593+85 Elev. 570.86
- B.M. #94-H-27 S.I.R. 18" x 12" 125' Rt. Sta. 593+85 Elev. 570.86
- B.M. #94-H-28 S.I.R. 18" x 12" 125' Rt. Sta. 593+85 Elev. 570.86
- B.M. #94-H-29 S.I.R. 18" x 12" 125' Rt. Sta. 593+85 Elev. 570.86
- B.M. #94-H-30 S.I.R. 18" x 12" 125' Rt. Sta. 593+85 Elev. 570.86
- B.M. #94-H-31 S.I.R. 18" x 12" 125' Rt. Sta. 593+85 Elev. 570.86
- B.M. #94-H-32 S.I.R. 18" x 12" 125' Rt. Sta. 593+85 Elev. 570.86
- B.M. #94-H-33 S.I.R. 18" x 12" 125' Rt. Sta. 593+85 Elev. 570.86
- B.M. #94-H-34 S.I.R. 18" x 12" 125' Rt. Sta. 593+85 Elev. 570.86
- B.M. #94-H-35 S.I.R. 18" x 12" 125' Rt. Sta. 593+85 Elev. 570.86
- B.M. #94-H-36 S.I.R. 18" x 12" 125' Rt. Sta. 593+85 Elev. 570.86
- B.M. #94-H-37 S.I.R. 18" x 12" 125' Rt. Sta. 593+85 Elev. 570.86
- B.M. #94-H-38 S.I.R. 18" x 12" 125' Rt. Sta. 593+85 Elev. 570.86
- B.M. #94-H-39 S.I.R. 18" x 12" 125' Rt. Sta. 593+85 Elev. 570.86
- B.M. #94-H-40 S.I.R. 18" x 12" 125' Rt. Sta. 593+85 Elev. 570.86
- B.M. #94-H-41 S.I.R. 18" x 12" 125' Rt. Sta. 593+85 Elev. 570.86
- B.M. #94-H-42 S.I.R. 18" x 12" 125' Rt. Sta. 593+85 Elev. 570.86
- B.M. #94-H-43 S.I.R. 18" x 12" 125' Rt. Sta. 593+85 Elev. 570.86
- B.M. #94-H-44 S.I.R. 18" x 12" 125' Rt. Sta. 593+85 Elev. 570.86
- B.M. #94-H-45 S.I.R. 18" x 12" 125' Rt. Sta. 593+85 Elev. 570.86
- B.M. #94-H-46 S.I.R. 18" x 12" 125' Rt. Sta. 593+85 Elev. 570.86
- B.M. #94-H-47 S.I.R. 18" x 12" 125' Rt. Sta. 593+85 Elev. 570.86
- B.M. #94-H-48 S.I.R. 18" x 12" 125' Rt. Sta. 593+85 Elev. 570.86
- B.M. #94-H-49 S.I.R. 18" x 12" 125' Rt. Sta. 593+85 Elev. 570.86
- B.M. #94-H-50 S.I.R. 18" x 12" 125' Rt. Sta. 593+85 Elev. 570.86
- B.M. #94-H-51 S.I.R. 18" x 12" 125' Rt. Sta. 593+85 Elev. 570.86
- B.M. #94-H-52 S.I.R. 18" x 12" 125' Rt. Sta. 593+85 Elev. 570.86
- B.M. #94-H-53 S.I.R. 18" x 12" 125' Rt. Sta. 593+85 Elev. 570.86
- B.M. #94-H-54 S.I.R. 18" x 12" 125' Rt. Sta. 593+85 Elev. 570.86
- B.M. #94-H-55 S.I.R. 18" x 12" 125' Rt. Sta. 593+85 Elev. 570.86
- B.M. #94-H-56 S.I.R. 18" x 12" 125' Rt. Sta. 593+85 Elev. 570.86
- B.M. #94-H-57 S.I.R. 18" x 12" 125' Rt. Sta. 593+85 Elev. 570.86
- B.M. #94-H-58 S.I.R. 18" x 12" 125' Rt. Sta. 593+85 Elev. 570.86
- B.M. #94-H-59 S.I.R. 18" x 12" 125' Rt. Sta. 593+85 Elev. 570.86
- B.M. #94-H-60 S.I.R. 18" x 12" 125' Rt. Sta. 593+85 Elev. 570.86
- B.M. #94-H-61 S.I.R. 18" x 12" 125' Rt. Sta. 593+85 Elev. 570.86
- B.M. #94-H-62 S.I.R. 18" x 12" 125' Rt. Sta. 593+85 Elev. 570.86
- B.M. #94-H-63 S.I.R. 18" x 12" 125' Rt. Sta. 593+85 Elev. 570.86
- B.M. #94-H-64 S.I.R. 18" x 12" 125' Rt. Sta. 593+85 Elev. 570.86
- B.M. #94-H-65 S.I.R. 18" x 12" 125' Rt. Sta. 593+85 Elev. 570.86
- B.M. #94-H-66 S.I.R. 18" x 12" 125' Rt. Sta. 593+85 Elev. 570.86
- B.M. #94-H-67 S.I.R. 18" x 12" 125' Rt. Sta. 593+85 Elev. 570.86
- B.M. #94-H-68 S.I.R. 18" x 12" 125' Rt. Sta. 593+85 Elev. 570.86
- B.M. #94-H-69 S.I.R. 18" x 12" 125' Rt. Sta. 593+85 Elev. 570.86
- B.M. #94-H-70 S.I.R. 18" x 12" 125' Rt. Sta. 593+85 Elev. 570.86
- B.M. #94-H-71 S.I.R. 18" x 12" 125' Rt. Sta. 593+85 Elev. 570.86
- B.M. #94-H-72 S.I.R. 18" x 12" 125' Rt. Sta. 593+85 Elev. 570.86
- B.M. #94-H-73 S.I.R. 18" x 12" 125' Rt. Sta. 593+85 Elev. 570.86
- B.M. #94-H-74 S.I.R. 18" x 12" 125' Rt. Sta. 593+85 Elev. 570.86
- B.M. #94-H-75 S.I.R. 18" x 12" 125' Rt. Sta. 593+85 Elev. 570.86
- B.M. #94-H-76 S.I.R. 18" x 12" 125' Rt. Sta. 593+85 Elev. 570.86
- B.M. #94-H-77 S.I.R. 18" x 12" 125' Rt. Sta. 593+85 Elev. 570.86
- B.M. #94-H-78 S.I.R. 18" x 12" 125' Rt. Sta. 593+85 Elev. 570.86
- B.M. #94-H-79 S.I.R. 18" x 12" 125' Rt. Sta. 593+85 Elev. 570.86
- B.M. #94-H-80 S.I.R. 18" x 12" 125' Rt. Sta. 593+85 Elev. 570.86
- B.M. #94-H-81 S.I.R. 18" x 12" 125' Rt. Sta. 593+85 Elev. 570.86
- B.M. #94-H-82 S.I.R. 18" x 12" 125' Rt. Sta. 593+85 Elev. 570.86
- B.M. #94-H-83 S.I.R. 18" x 12" 125' Rt. Sta. 593+85 Elev. 570.86
- B.M. #94-H-84 S.I.R. 18" x 12" 125' Rt. Sta. 593+85 Elev. 570.86
- B.M. #94-H-85 S.I.R. 18" x 12" 125' Rt. Sta. 593+85 Elev. 570.86
- B.M. #94-H-86 S.I.R. 18" x 12" 125' Rt. Sta. 593+85 Elev. 570.86
- B.M. #94-H-87 S.I.R. 18" x 12" 125' Rt. Sta. 593+85 Elev. 570.86
- B.M. #94-H-88 S.I.R. 18" x 12" 125' Rt. Sta. 593+85 Elev. 570.86
- B.M. #94-H-89 S.I.R. 18" x 12" 125' Rt. Sta. 593+85 Elev. 570.86
- B.M. #94-H-90 S.I.R. 18" x 12" 125' Rt. Sta. 593+85 Elev. 570.86
- B.M. #94-H-91 S.I.R. 18" x 12" 125' Rt. Sta. 593+85 Elev. 570.86
- B.M. #94-H-92 S.I.R. 18" x 12" 125' Rt. Sta. 593+85 Elev. 570.86
- B.M. #94-H-93 S.I.R. 18" x 12" 125' Rt. Sta. 593+85 Elev. 570.86
- B.M. #94-H-94 S.I.R. 18" x 12" 125' Rt. Sta. 593+85 Elev. 570.86
- B.M. #94-H-95 S.I.R. 18" x 12" 125' Rt. Sta. 593+85 Elev. 570.86
- B.M. #94-H-96 S.I.R. 18" x 12" 125' Rt. Sta. 593+85 Elev. 570.86
- B.M. #94-H-97 S.I.R. 18" x 12" 125' Rt. Sta. 593+85 Elev. 570.86
- B.M. #94-H-98 S.I.R. 18" x 12" 125' Rt. Sta. 593+85 Elev. 570.86
- B.M. #94-H-99 S.I.R. 18" x 12" 125' Rt. Sta. 593+85 Elev. 570.86
- B.M. #94-H-100 S.I.R. 18" x 12" 125' Rt. Sta. 593+85 Elev. 570.86