

THREE CABLE GUARD RAIL W/STEEL POSTS  
 Left 562+00 to 566+00 Right 562+00 to 569+00  
 567+50 to 574+00

Removing & Resetting Three Cable Guard Rail  
 with Steel Posts  
 Left  
 567+84 to 572+00

PROPERTY LINE FENCE W/STEEL POSTS  
 Left 575+75 Right 562+00 to 576+00

E CURVE DATA  
 REC. DEF.  
 PI 603+33.06 Ak =  
 385+56.30 Rad.  
 Δ - 87° 25' LT  
 D - 30.00'  
 E - 3819.72'  
 T - 3651.27'  
 L - 3627.78'  
 E - 1464.40'  
 SE - 1/2" 1/4"

LANDSCAPING MATERIAL  
 TREES  
 562+75 RT. 2' E. RED CEDAR (1)

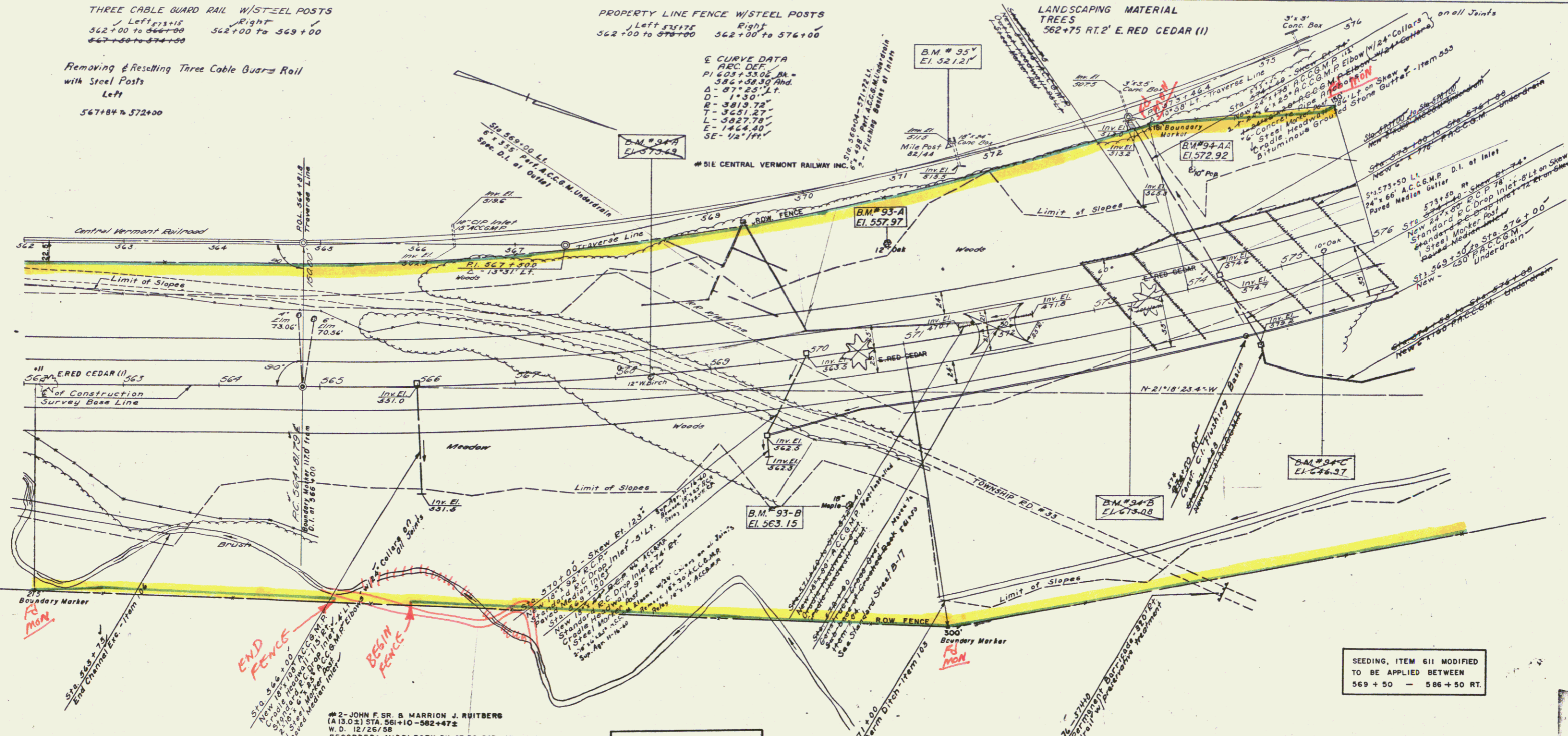

END FENCE

BEGIN FENCE

SEEDING, ITEM 611 MODIFIED  
 TO BE APPLIED BETWEEN  
 569 + 50 - 586 + 50 RT.

#2 - JOHN F. SR. & MARRION J. RUITBERG  
 (A 13.02) STA. 561+10 - 582+47.2  
 W.D. 12/26/58  
 RECORDED: MIDDLESEX BK. 27 P. 545-47 - 12/31/58

Note: for Summary of Landscape Material  
 Project 1-89 (15) Sheet #28  
 Contract #1 Sheet #26

B.M. #94-A ON 560+42.2  
 S 17° 12' W BIRCH  
 Elev. 575.60 - 1/4"

B.M. #94-B ON 573+40.2  
 S 12° 10' W Hemlock  
 Elev. 613.08 - 3/4"

B.M. #94-C ON 575+45.2  
 S 12° 10' W Oak  
 Elev. 646.97 - 3/4"

B.M. #92 STA. 571+00 (Traverse Line)  
 Top Mile Post #44/44  
 Elev. 521.21 - 1/4" LT  
 198' LT

B.M. #93-A S.I.T. 12" Oak 108' Lt. Sta. 591+00 Elev. 557.97  
 B.M. #93-B S.I.T. 16" Maple 160' Rt. Sta. 570+20 Elev. 563.15  
 B.M. #94-AA S.I.T. 10" Pop. 172' Lt. Sta. 574+35 Elev. 572.92

STATE OF VERMONT  
 DEPARTMENT OF HIGHWAYS  
 INTERSTATE PROJECT IN THE TOWNS OF  
 MIDDLESEX - WATERBURY  
 PLAN

WILLIAM H. McFARLAND  
 ENGINEER  
 BIRCHMOUNT, N.Y.

PROJECT NO. 1 89-2 (15)  
 CONTRACT NO. 1  
 SHEET 30 OF 315