

THREE CABLE GUARD RAIL W/STEEL POSTS
 LEFT Sta 531+00 to Sta 532+100
 RIGHT Sta 538+00 to Sta 539+100

PROPERTY LINE FENCE W/STEEL POSTS
 LEFT Sta 538+100 to Sta 539+100
 RIGHT Sta 548+100 to Sta 549+100

LANDSCAPING MATERIAL
 TREES
 560+25 RT 2' E. RED CEDAR (1)

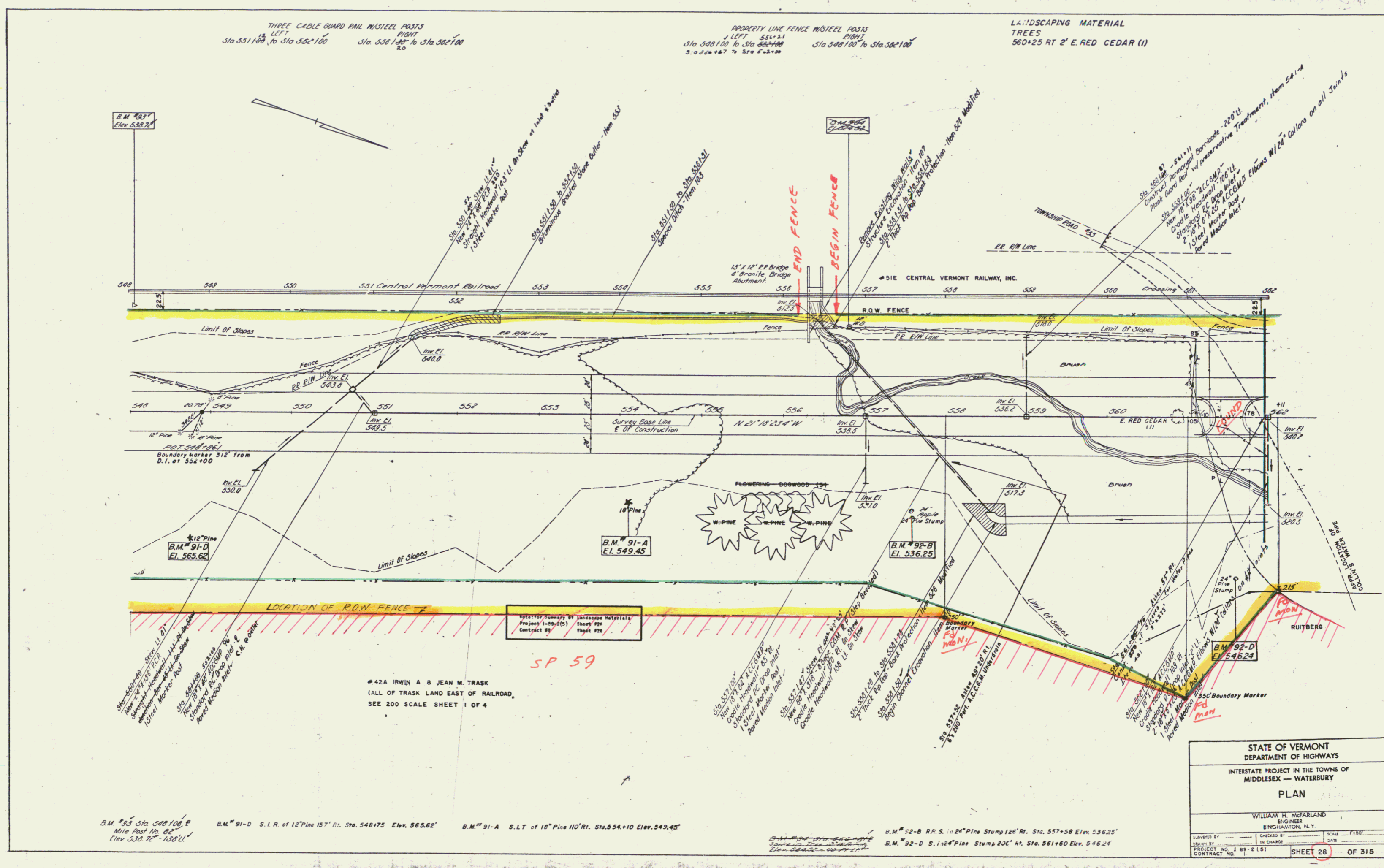

B.M. #87
 Elev. 538.72

B.M. #88
 Elev. 538.72

B.M. #91-A
 Elev. 549.45

B.M. #92-B
 Elev. 536.25

B.M. #92-D
 Elev. 546.24

B.M. #93 Sta 548+100
 Mile Post No. 62
 Elev. 538.72 - 130' U

B.M. #91-D S. 1/4 R. of 12" Pine 157' Rl. Sta. 548+75 Elev. 565.62

B.M. #91-A S.L.T. of 18" Pine 110' Rl. Sta. 554+10 Elev. 549.45

B.M. #92-B R.R.S. of 24" Pine Stump 126' Rl. Sta. 557+58 Elev. 536.25
 B.M. #92-D S. 1/4 R. of 24" Pine Stump 200' Rl. Sta. 561+60 Elev. 546.24

PROPERTY LINE FENCE W/STEEL POSTS
 Project 1-89-051 Sheet #28
 Contract #1

#42A IRWIN A & JEAN M. TRASK
 (ALL OF TRASK LAND EAST OF RAILROAD,
 SEE 200 SCALE SHEET 1 OF 4)

STATE OF VERMONT DEPARTMENT OF HIGHWAYS	
INTERSTATE PROJECT IN THE TOWNS OF MIDDLESEX — WATERBURY	
PLAN	
WILLIAM H. McFARLAND ENGINEER BINGHAMTON, N.Y.	
DESIGNED BY	CHECKED BY
DRAWN BY	IN CHARGE
PROJECT NO. 1-89-051	SCALE 1"=50'
CONTRACT NO. 1-1-2-151	DATE
SHEET 28	OF 315