

51 CENTRAL VERMONT RAILWAY, INC.
 R. O. W. EASEMENT STA. 519+90
 COND. 12/31/58
 RECORDED MIDDLESEX BK. 29 PG. 94-III 12/31/58

FED. ROAD DIV. NO.	STATE	FEDERAL PROJECT NO.	SHEET	TOTAL SHEETS
1	VERMONT	I 89-2 (4)	74	80

GRANITE SLOPE EDGING ITEM 556A

RAMP A	STA 8+08 TO 9+65.07	RT.
RAMP A	STA 8+52 TO 9+22	LT.
RAMP A	STA 13+66 TO 15+60	RT.
RAMP A	AB ISLAND	
RAMP B	STA 3+50 TO 5+19	RT.
RAMP B	STA 9+77 TO 11+34	RT.
RAMP B	STA 10+20 TO 10+90	LT.
RAMP B	AB ISLAND	
RAMP C	STA 2+46 TO 3+82	RT.
RAMP C	STA 2+86 TO 3+88	LT.
RAMP C	AB ISLAND	
RAMP D	STA 12+43 TO 13+85	RT.
RAMP D	STA 12+76 TO 13+50	LT.
RAMP D	AB ISLAND	
RAMP D	MAINLINE BULLNOSE	
RAMP AB	STA 2+42 TO 2+5079	LT.
RAMP AB	STA 2+42 TO 2+4946	RT.

FILL DEPRESSION TO FACILITATE DRAINAGE (5,000 CY EST.)
 SPECIAL 4' DITCH

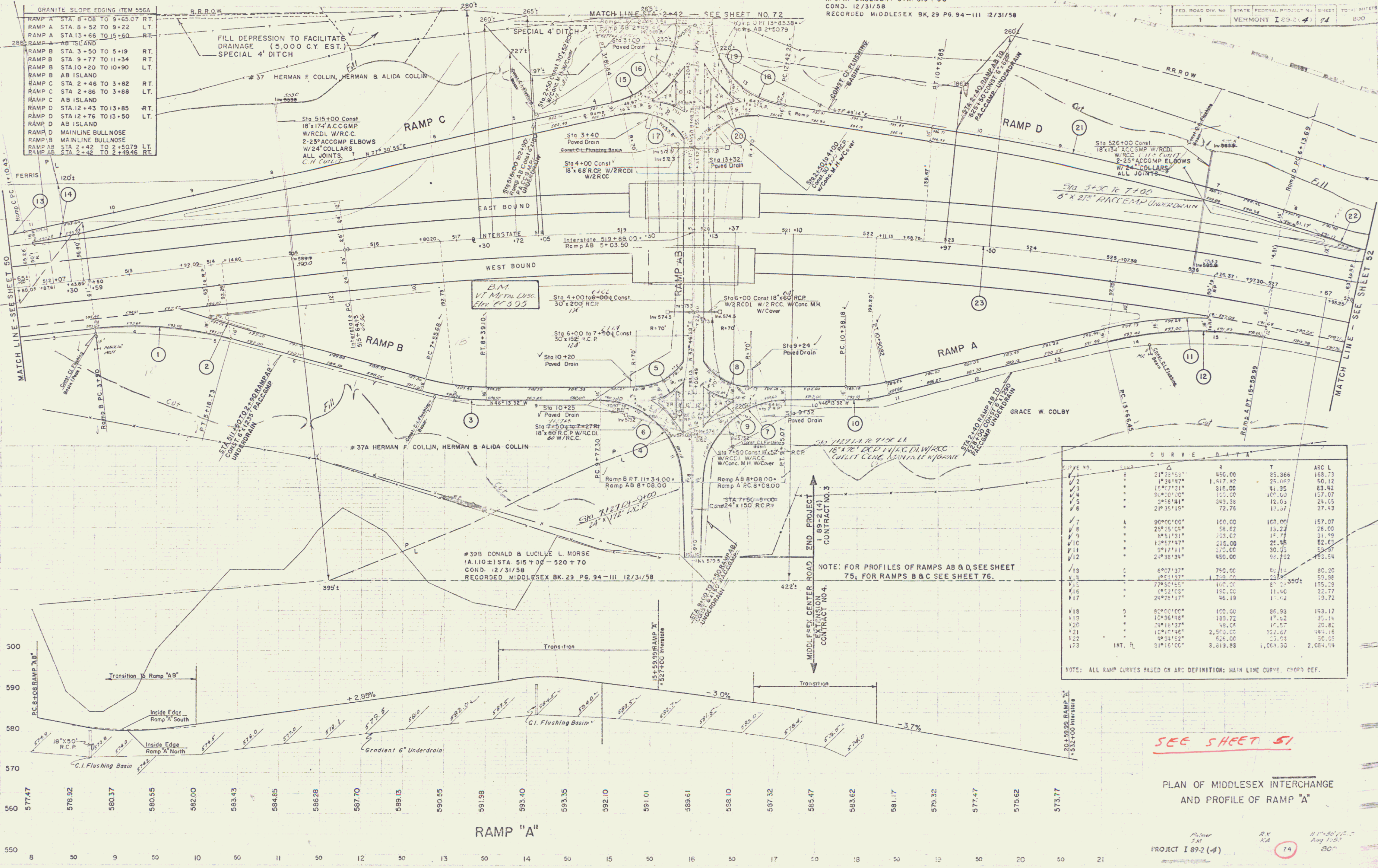

CURVE NO.	SWAY	Δ	R	T	ARC L
1		21°25'55"	450.00	85.366	168.73
2		1°24'47"	1,417.87	25.067	50.12
3		15°07'13"	318.00	61.35	83.82
4		50°20'00"	155.00	105.00	157.07
5		3°56'41"	348.38	12.63	24.65
6		21°35'19"	72.76	19.37	27.43
7		90°00'00"	100.00	100.00	157.07
8		25°25'05"	58.67	13.22	26.00
9		8°51'13"	153.67	15.75	31.19
10		13°57'47"	215.00	26.45	52.63
11		9°17'11"	370.00	30.75	59.97
12		24°38'34"	450.00	82.252	163.54
13		6°07'37"	750.00	81.19	80.20
14		8°51'13"	1,210.00	23.29	59.88
15		7°43'05"	100.00	8.24	155.29
16		8°52'05"	180.00	11.40	22.77
17		24°28'17"	86.19	13.42	19.72
18		5°00'00"	100.00	86.93	143.12
19		10°36'16"	159.72	17.22	35.14
20		24°16'37"	88.04	16.57	20.82
21		10°11'46"	2,570.00	22.67	441.16
22		4°34'52"	626.00	23.03	30.05
23	INT. R.	31°16'00"	3,619.83	1,064.30	2,084.94

NOTE: ALL RAMP CURVES BASED ON ARC DEFINITION; MAIN LINE CURVE, CHORD DEF.

SEE SHEET 51

PLAN OF MIDDLESEX INTERCHANGE AND PROFILE OF RAMP "A"

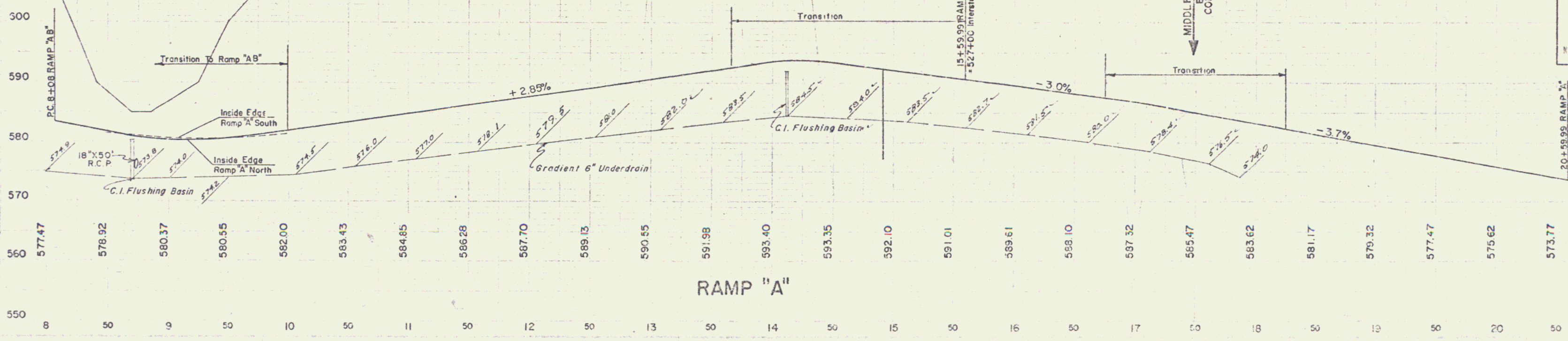

PROJECT I 89-2 (4) 74 const