

FED. ROAD DIV. NO.	STATE	FEDERAL PROJECT NO.	SHEET	TOTAL SHEETS
1	VERMONT	I 89-2(4)	70	800

REMOVAL & DISPOSAL  
OF PRESENT GUARD RAIL  
36+0 - 36+34 RT.  
35+20 - 36+38 RT.  
35+20 - 35+99 RT.

EXCAV. & REMOVAL OF ROAD  
SURF. ON ROADWAYS  
ITEM 118A  
STA. 32+0 - 36+50  
36+90 - 38+65

NOTE:  
SEE MAIN LINE SHEET  
NOS. 43 & 44.

CONST. PLANK GUARD RAIL  
WITH PAINT ROUTE 2  
STATION 36+70 RT. OMITTED

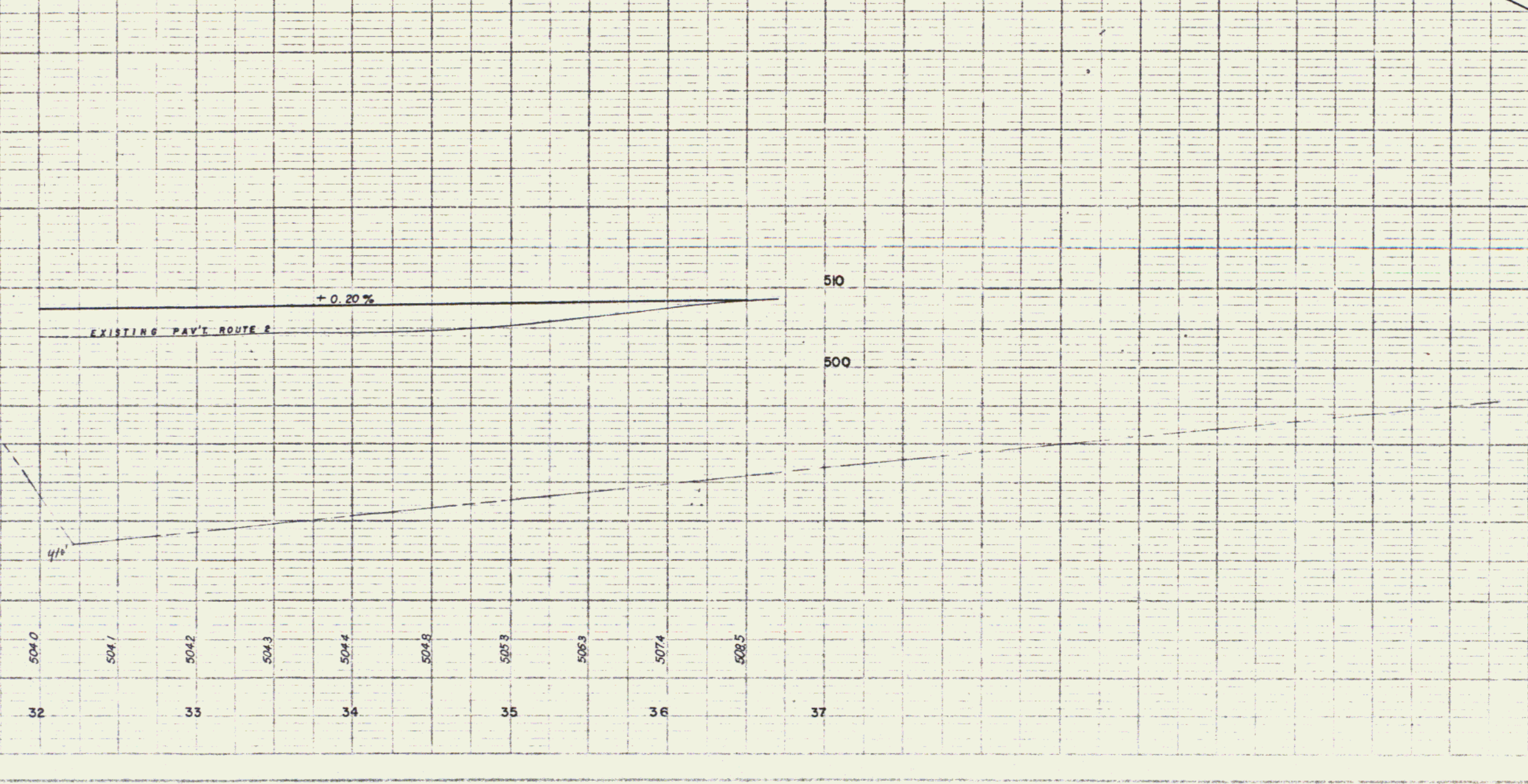
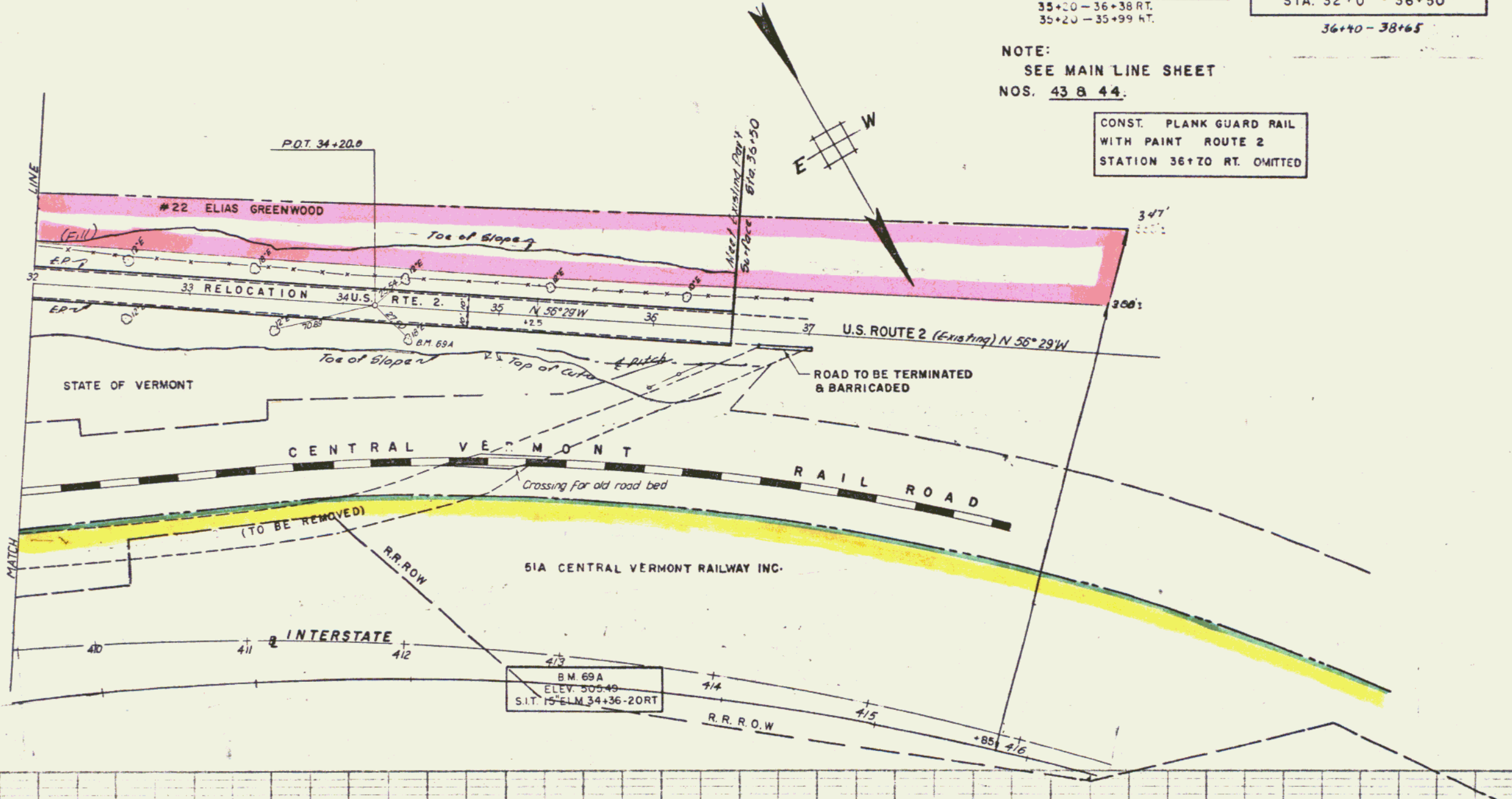

PALMER - ISHAM  
 A.B.  
 A.C.  
 A.D.  
 A.E.  
 A.F.  
 A.G.  
 A.H.  
 A.I.  
 A.J.  
 A.K.  
 A.L.  
 A.M.  
 A.N.  
 A.O.  
 A.P.  
 A.Q.  
 A.R.  
 A.S.  
 A.T.  
 A.U.  
 A.V.  
 A.W.  
 A.X.  
 A.Y.  
 A.Z.

PALMER - ISHAM  
 A.B.  
 A.C.  
 A.D.  
 A.E.  
 A.F.  
 A.G.  
 A.H.  
 A.I.  
 A.J.  
 A.K.  
 A.L.  
 A.M.  
 A.N.  
 A.O.  
 A.P.  
 A.Q.  
 A.R.  
 A.S.  
 A.T.  
 A.U.  
 A.V.  
 A.W.  
 A.X.  
 A.Y.  
 A.Z.

STATE OF VERMONT  
DEPARTMENT OF HIGHWAYS  
INTERSTATE PROJECT in the towns of  
BURLINGTON and FERRISBURGH  
**U.S. ROUTE 2 RELOCATION N°3**  
VICINITY OF WILDER UNDERPASS

Palmer  
35  
PROJECT I 89-2 (4)  
RK  
KA  
Aug '57  
800  
const

Sheet 70  
Contract #1  
51