

FLD. ROAD DIV. No.	STATE	FEDERAL PROJECT No.	SHEET	TOTAL SHEETS
1	VERMONT	I 89-2 (3)	65	800

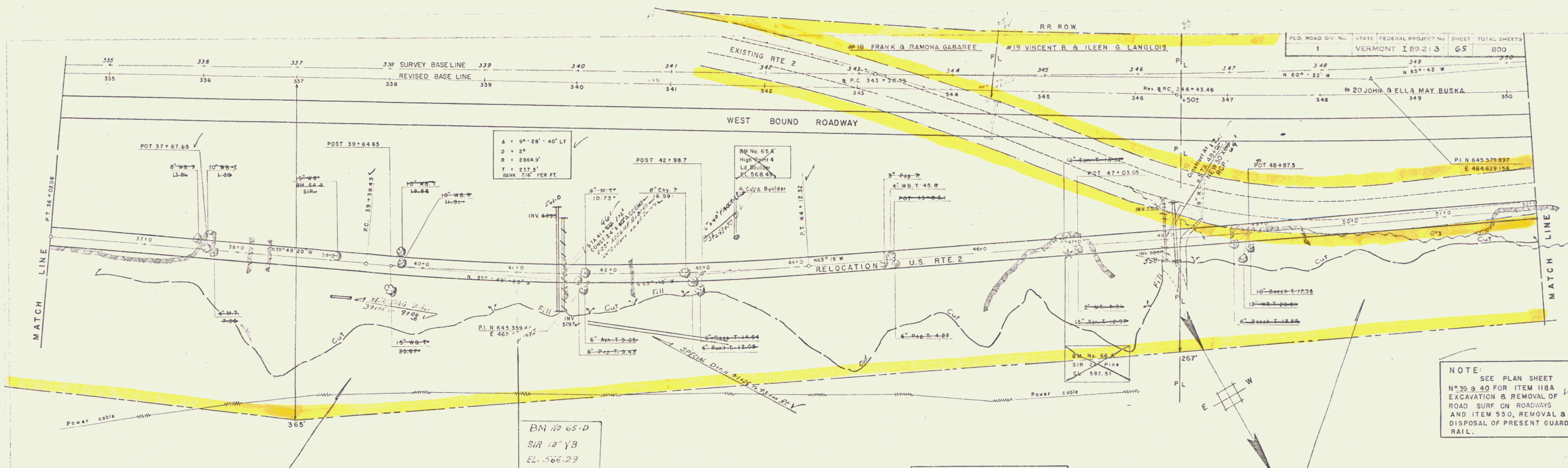

THREE CABLE GUARD RAIL WITH STEEL POST

STA 40+75 to 44+75 LEFT ✓
 STA 47+00 to 48+00 LEFT ✓
 STA 36+00 to 37+00 LEFT ✓
 STA 36+00 to 37+00 LEFT ✓
 STA 47+02 - 50+55 LEFT ✓
 STA 51+02 - 52+00 LEFT ✓

DRILLING & BLASTING OF SOLID ROCK SUBGRADE

STA. 36+00 to 40+25 ✓
 STA. 41+00 to 42+25 ✓
 STA. 48+25 to 47+00 ✓
 STA. 48+20 to 52+00 ✓

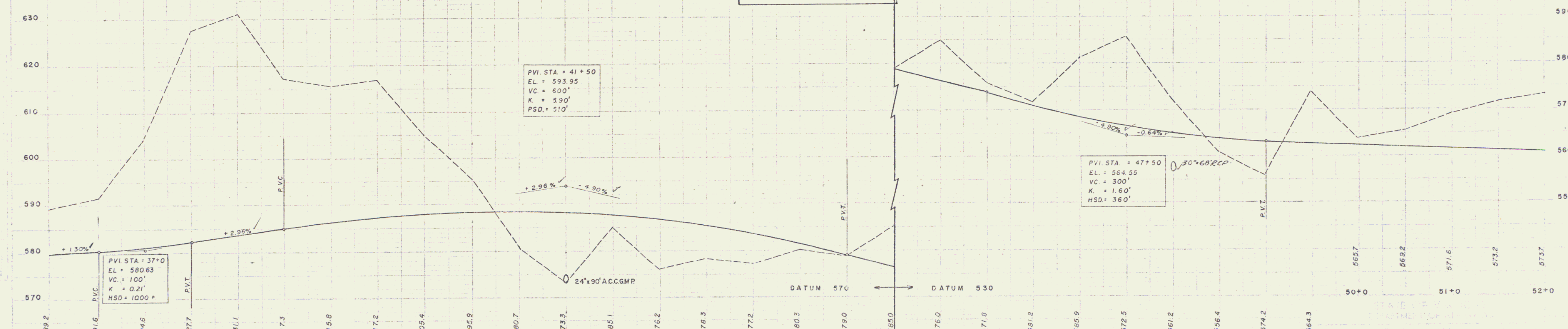

U.S. RTE. 2. RELOCATION NO. 2. PLAN & PROFILE

Palmer S.M. R. Kerr K. Adelberg
 PROJECT I 89-2 (3) 1" = 50' Aug 1957
 800