

APPROXIMATE
DATE
BY
REVISED
DATE
BY

APPROXIMATE
DATE
BY
REVISED
DATE
BY

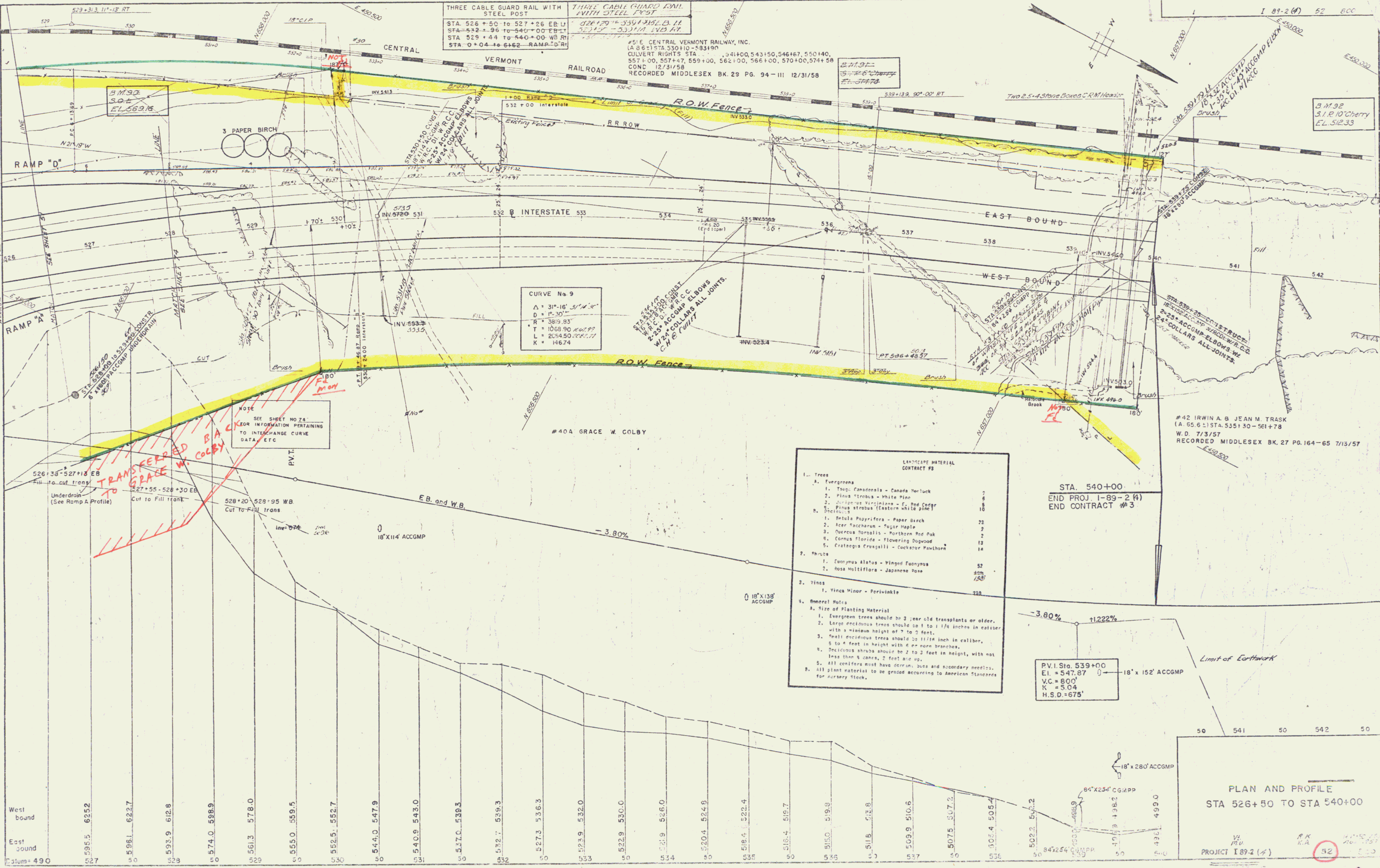

THREE CABLE GUARD RAIL WITH STEEL POST
STA. 526+50 TO 527+26 EB U
STA. 527+26 TO 540+00 EB U
STA. 529+44 TO 540+00 WB R
STA. 0+04 TO 6+62 RAMP "D" R

THREE CABLE GUARD RAIL WITH STEEL POST
STA. 526+50 TO 527+26 EB U
STA. 527+26 TO 540+00 EB U
STA. 529+44 TO 540+00 WB R
STA. 0+04 TO 6+62 RAMP "D" R

#5 E. CENTRAL VERMONT RAILWAY, INC.
(A. 85.1) STA. 530+10 - 531+90
CULVERT RIGHTS STA. 534+00, 543+50, 546+67, 550+40,
557+00, 557+47, 559+00, 562+00, 566+00, 570+00, 574+58
COND. 12/31/58
RECORDED MIDDLESEX BK. 29 PG. 94-III 12/31/58

CURVE No. 9
A = 31°-16' 51" 1/2"
D = 1°-30"
R = 3819.83'
T = 1068.90'
L = 2054.50'
K = 1467.4

LANDSCAPE MATERIAL CONTRACT #3

- Trees
 - Evergreens
 - Taxus canadensis - Canada Hemlock 0
 - Pinus strobus - White Pine 6
 - Juniperus virginiana - E. Red Cedar 8
 - Pinus strobus (Eastern white pine) 10
 - Deciduous
 - Betula papyrifera - Paper Birch 22
 - Acer saccharum - Sugar Maple 2
 - Quercus borealis - Northern Red Oak 2
 - Cornus florida - Flowering Dogwood 13
 - Crataegus crugallii - Cockspur Hawthorn 14
- Shrubs
 - Comynus alatus - Winged Euonymus 52
 - Rosa multiflora - Japanese Rose 138
- Vines
 - Vitex minor - Periwinkle 110
- General Notes
 - Size of Planting Material
 - Evergreen trees should be 3 year old transplants or older.
 - Large deciduous trees should be 1 to 1 1/4 inches in caliper with a minimum height of 7 to 8 feet.
 - Small deciduous trees should be 1 1/4 inch in caliper, 5 to 6 feet in height with 4 or more branches.
 - Deciduous shrubs should be 2 to 3 feet in height, with not less than 3 canes, 2 feet and up.
 - All containers must have drainage holes and secondary needles.
 - All plant material to be graded according to American Standards for Nursery Stock.

STA. 540+00
END PROJ. 1-89-2 (4)
END CONTRACT #3

P.V.I. Sta. 539+00
E.I. = 547.87
V.C. = 800'
K = 5.04
H.S.D. = 675'

PLAN AND PROFILE
STA 526+50 TO STA 540+00
PROJECT I 89-2 (4)
CONST