

3 CABLE GUARD RAIL WITH STEEL POSTS  
 STA. 5+91 LT. TO 8+79 LT.  
 STA. 12+70 LT. TO 15+00 LT.  
 STA. 7+50 RT. TO 9+26 RT.  
 STA. 12+00 RT. TO 15+00 RT. ✓

DRILLING & BLASTING OF SOLID ROCK SUB-GRADE  
 STA. 5+50 TO 9+20

GRANITE SLOPE EDGING  
 RAMP "B"  
 STA. 15+75 TO 18+00 LT. ✓  
 STA. 16+20 TO 16+70 RT. ✓  
 RAMP "A"  
 STA. 15+51 TO 17+13 RT. ✓  
 RAMP "H"  
 STA. 6+14 TO 6+64 LT. ✓  
 STA. 5+50 TO 15+00 ISLAND ✓

B-M-3A  
 Spot on Ledge  
 11+32-42' LT.  
 Elev. 563.47

BM 3 AA  
 514 24" Hem.  
 El. 599.02

BM 3 AB  
 515 18" Pine  
 El. 574.14

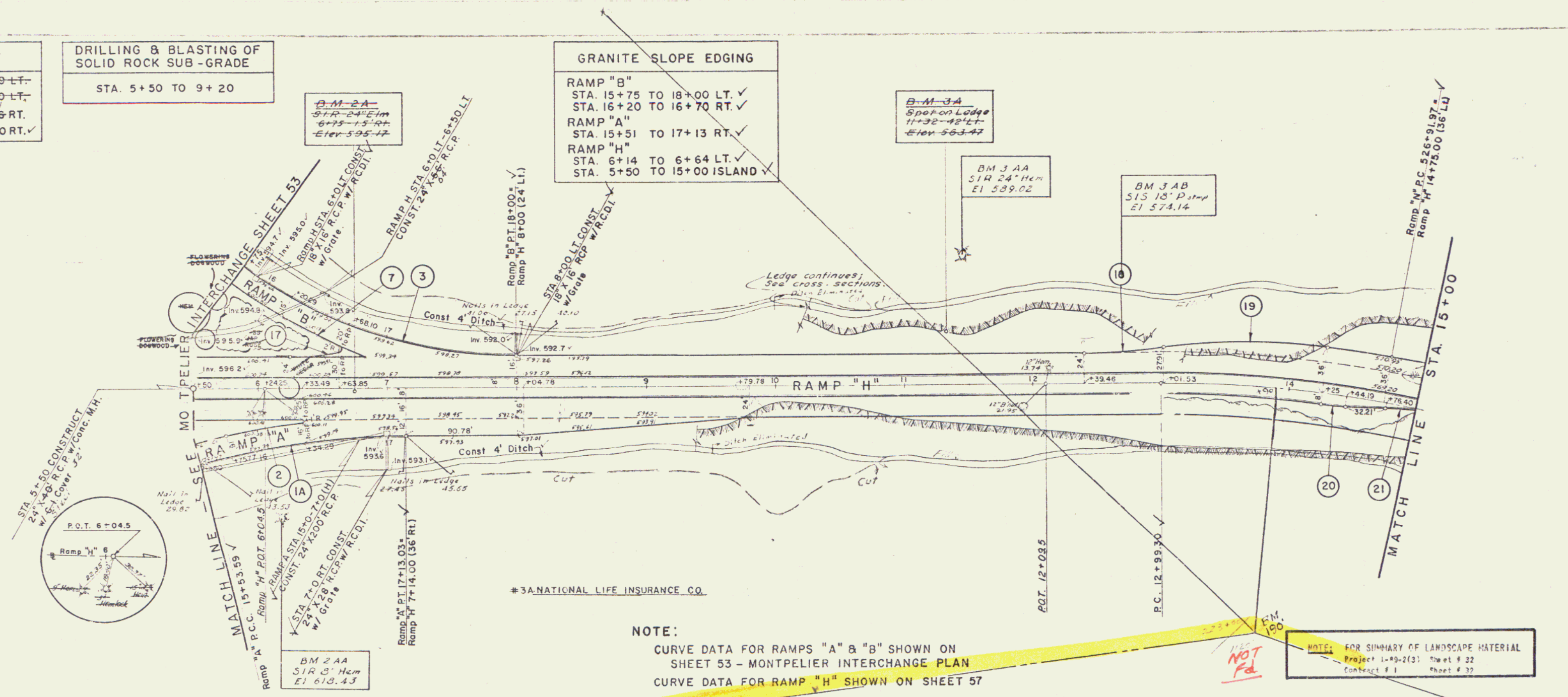

NOTE:  
 CURVE DATA FOR RAMPS "A" & "B" SHOWN ON SHEET 53 - MONTPELIER INTERCHANGE PLAN  
 CURVE DATA FOR RAMP "H" SHOWN ON SHEET 57

NOTE: FOR SUMMARY OF LANDSCAPE MATERIAL  
 Project I-89-2(3) Sheet # 22  
 Contract # 1 Sheet # 30

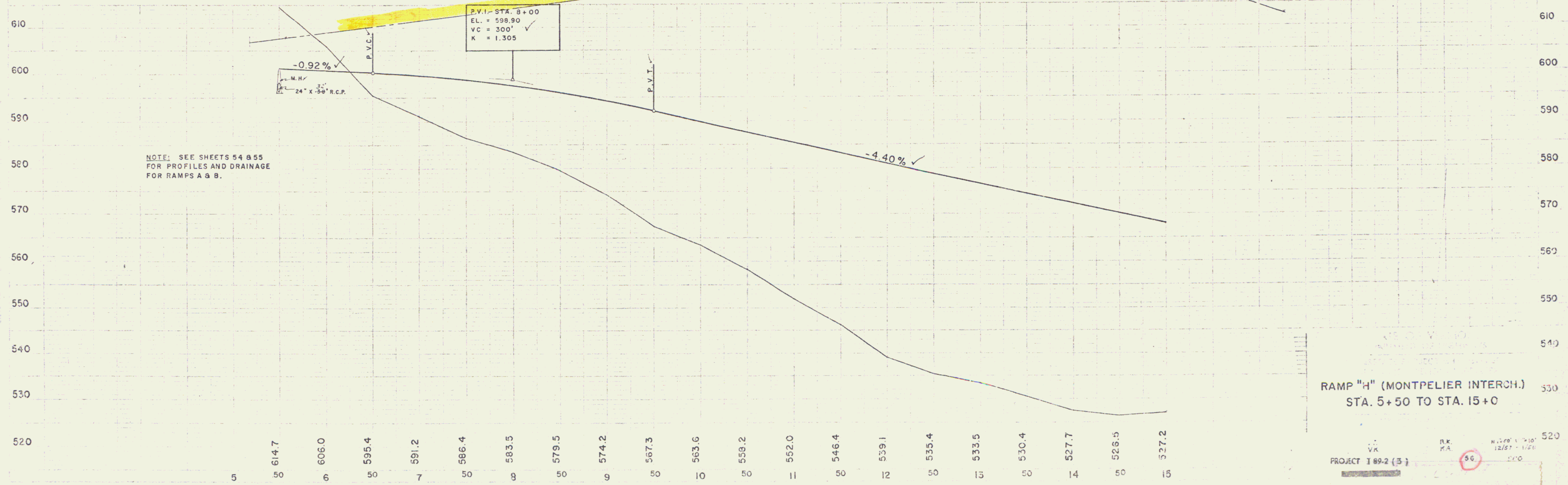

NOTE: SEE SHEETS 54 & 55 FOR PROFILES AND DRAINAGE FOR RAMPS A & B.

RAMP "H" (MONTPELIER INTERCH.)  
 STA. 5+50 TO STA. 15+00