

THIS IS PART OF THE LAND AND RIGHTS ACQUIRED BY THE STATE OF VERMONT FROM ROBERT H. MENARD AND MILDRED P. MENARD BY WD DATED JULY 28, 1967 AND RECORDED IN BK. 37, PG. 266 OF THE TOWN OF BERLIN LAND RECORDS..

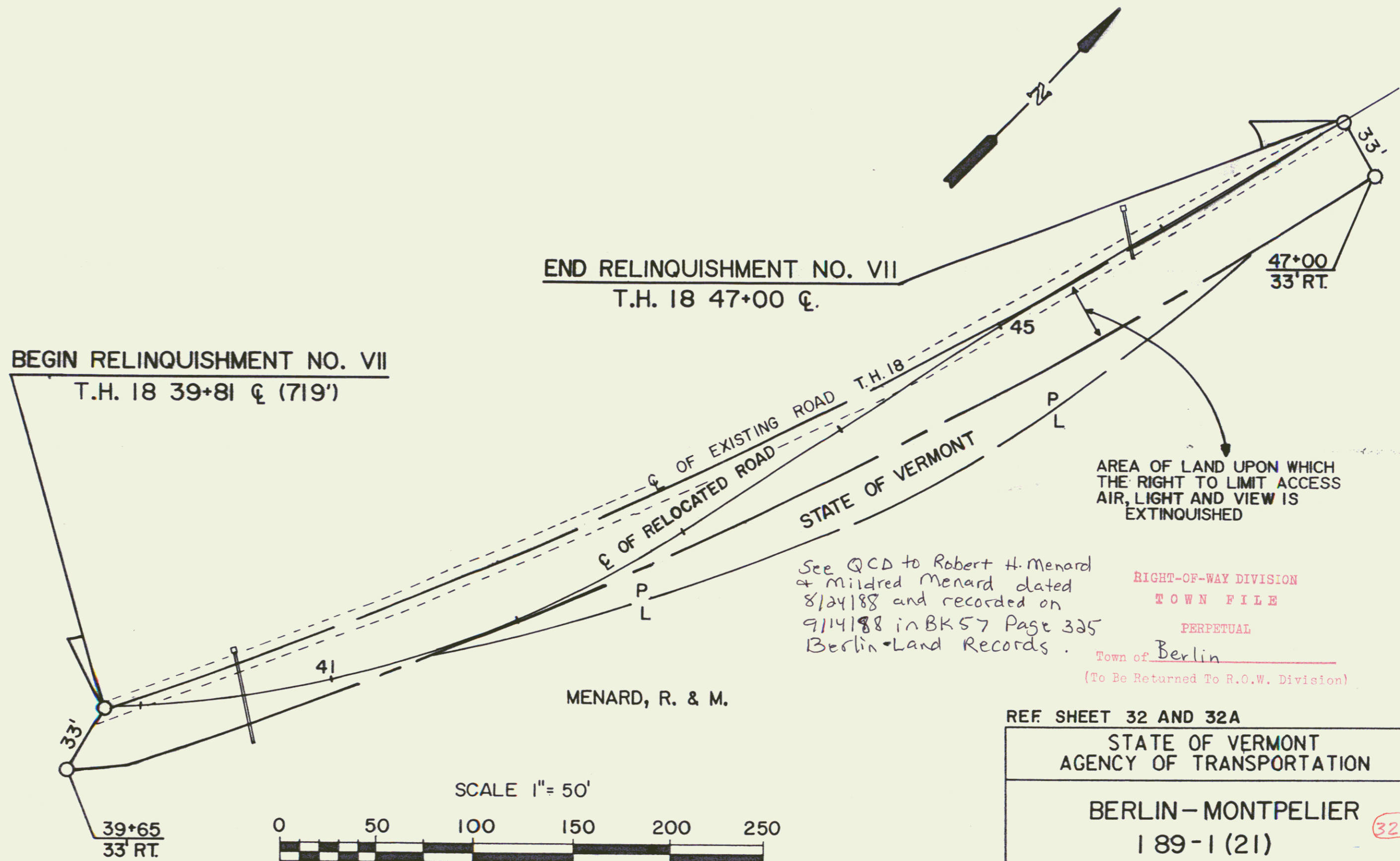

See QCD to Robert H. Menard & Mildred Menard dated 8/24/88 and recorded on 9/14/88 in BK 57 Page 325 Berlin Land Records.

RIGHT-OF-WAY DIVISION
TOWN FILE
PERPETUAL
Town of Berlin
(To Be Returned To R.O.W. Division)

REF SHEET 32 AND 32A		
STATE OF VERMONT AGENCY OF TRANSPORTATION		
BERLIN - MONTPELIER 320		
189-1 (21)		
APPROX. SCALE 1" = 50'	DATE: 7-25-88	DRAWN BY A.S.J.