

* DENOTES STAGE 2 ITEMS

Stone Fill For Slope Protection (Light Type)
Item 512
T-65 11+00 RT.
(Inlet Ditch)

Three Cable Guard Rail w/LL St Posts
Item 538
S.B.A.R. 40+75 ~ 45+55 RT
Ramp D' 38+52 ~ 40+75 RT
37+73

Standard Steel Beam Guard Rail w/Steel Posts (6'-9" Spacing)
Item 535-A
S.B.A.R. 40+75 ~ 47+14 LT
Ramp C' 37+00 ~ 40+75 LT

Bituminous Concrete Surface For Gutters & Traffic Islands
Item 554, Road
S.B.A.R. 42+50 Median
S.B.A.R. 45+00 Median
S.B.A.R. 47+60 Median
Ramp D' 38+00 RT
Ramp C' 40+00 ~ 40+75 LT

RELOCATED T-65 CURVE DATA
Δ = 37° 30' 00"
D = 12° 00' 00"
R = 47747'
T = 16208'
L = 31250'
E = 2676'
Bank = 1/2" Per Ft.

Treated Timber Curb, Item 559
S.B.A.R. 40+75 ~ 45+02 RT
Ramp D' 40+3744 ~ 40+75 RT

Granite Slope Edging, Item 556-A
S.B.A.R. 40+75 ~ 49+8452 Median
Ramp C' 40+3744 ~ 40+75 LT
Ramp D' 38+00 ~ 40+3744 RT
Ramp D' 40+3744 ~ 40+75 LT

PROPERTY LINE FENCE WITH STEEL POSTS ITEM 585-E MOD.		
STA.	STA.	POS.
SOUTH BOUND		
Ramp C' 37+00	40+75	LT

CONSTRUCT DRIVE ROW BID ITEM
43+36-44
12+00

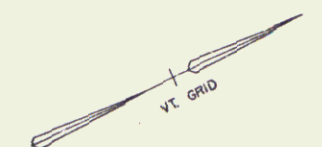

○ FILL
△ CUT

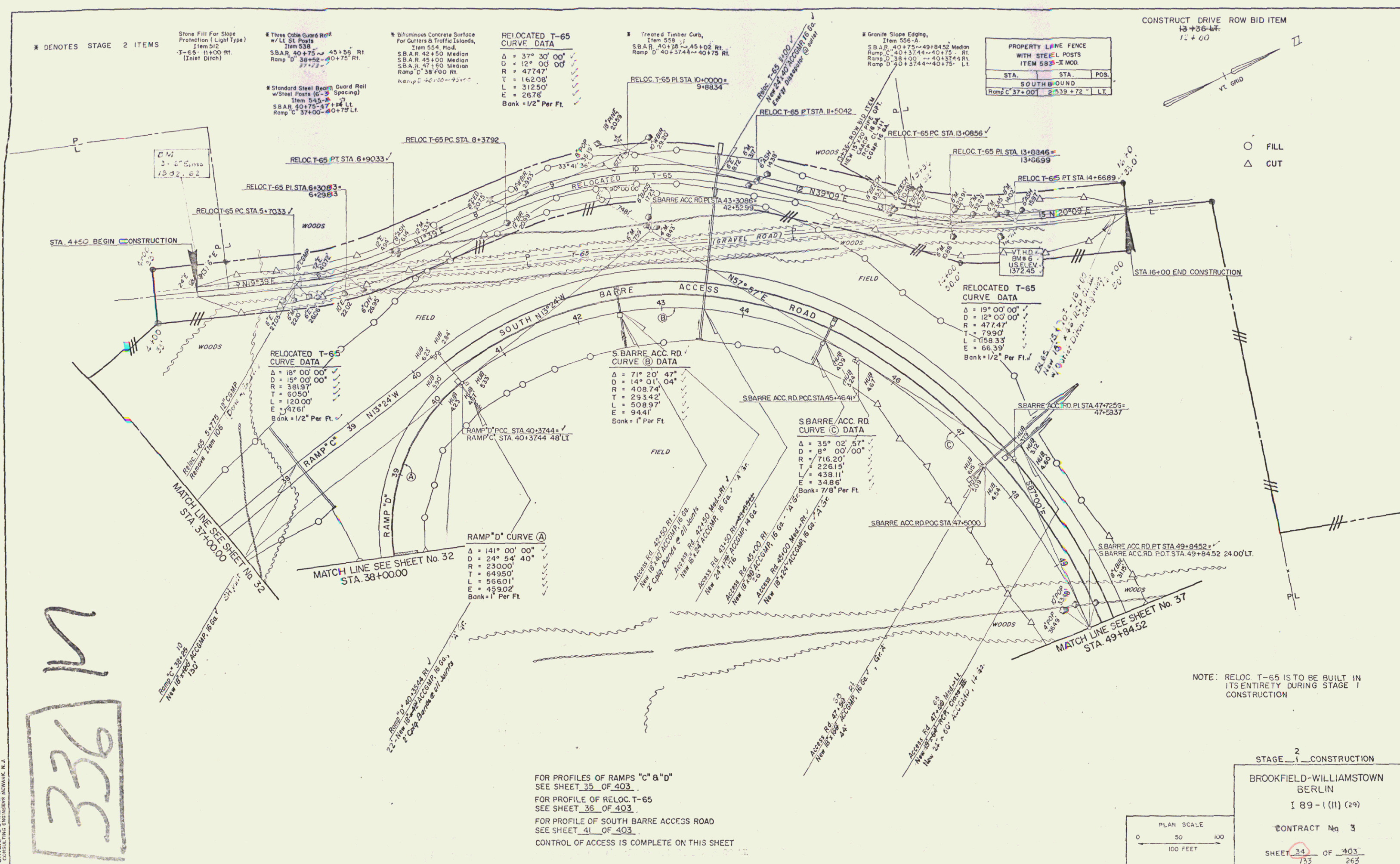

336

POSTER, CHERNEN & ARMSTRONG
CONSULTING ENGINEERS
1000 ROUTE 100
MORRISTOWN, N.J.

FOR PROFILES OF RAMP'S "c" & "d"
SEE SHEET 35 OF 403
FOR PROFILE OF RELOC. T-65
SEE SHEET 36 OF 403
FOR PROFILE OF SOUTH BARRE ACCESS ROAD
SEE SHEET 41 OF 403
CONTROL OF ACCESS IS COMPLETE ON THIS SHEET

NOTE: RELOC. T-65 IS TO BE BUILT IN ITS ENTIRETY DURING STAGE 1 CONSTRUCTION

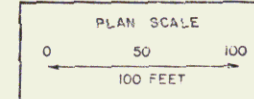

STAGE 2 CONSTRUCTION
BROOKFIELD-WILLIAMSTOWN
BERLIN
I 89-1 (11) (29)
CONTRACT No 3
SHEET 34 OF 403
173 263

117